

LVNI BEIJING BRANCH

Address: No. 49, Gaolou Village, Malian Road, Fengtai District, Beijing
Mobile:13580404292(Mr.Tang)

LVNI SHANGHAI BRANCH

Address: Room 211, No. 1, Weiguang Qingchuang Base, No. 523-525,
Jiasong Middle Road, Qingpu District, Shanghai
Mobile:15112104162(Mr.Chen)

LVNI SHENZHEN BRANCH

Address: No. 26, Putian Road, Bainikeng Community, Pinghu
Street Office, Longgang District, Shenzhen
Mobile:15112104164(Mr.Monte)

LVNI CHENGDU BRANCH

Address: 2nd Floor, Building C, Xinwulian Port Food Packaging Machinery
Trading Center, No. 1988 Xingcheng Avenue, Xindu District, Chengdu
Mobile:19950292823(Ms.Luo)

LVNI HUNAN PRODUCTION BASE

Address: Jianye Road, Economic and Technological Development Zone,
Lengshuitan District, Yongzhou City, Hunan Province
Mobile:18928736087(Mr.Deng)

LVNI Overseas Business Department

Add.: No. 701, Building Chengye Skycraper, Panyu District, Guangzhou City
Contact: Maggie
Mobile/Wechat/Whatsapp: +8618927583976
Email: sales1@lvni-greenlife.com
Web: www.lvni-fridge.com
Alibaba: <https://greenlifehotel.en.alibaba.com>



Service Hotline: 400-169-8839

Note: The company reserves the right to change product specifications, models, appearance and functions without prior notice, please refer to the actual product for details.

LVNI TECH. CATALOGUE



LVNi WeChat
Official Account



GREENLIFE
BE WITH YOU
AIR-COOLED
FREEZER
PICK LVNI

LVNI overseas official website: www.lvnifridge.com

LVNI Alibaba International: <https://greenlifelifehotel.en.alibaba.com>

LVNI Technology

COMPANY OVERVIEW

LVNI Group was established in 2011 with a registered capital of 10 million RMB and 150 employees. It is a high-tech enterprise that provides mid-to-high-end commercial kitchen air-cooled refrigerators, cold chain cabinets, smart refrigerators, star hotels and kitchen equipment solutions, integrating scientific research, design, production, sales and trade. LVNI Group currently has Guangzhou marketing headquarters, Beijing branch, Shanghai branch, Chengdu branch, Shenzhen branch, Changsha branch and a 30,000-square-meter manufacturing base located in Yongzhou Economic and Technological Development Zone, Hunan Province.

COMPANY PRODUCTS

LVNI's products include commercial kitchen energy-saving air-cooled refrigerators, vending machines, cold storage, fresh cold chain and non-standard customized refrigerators, etc., mainly serving hotels, catering, high-end clubhouse, smart home, biotechnology, agricultural products and other fields. Currently holding four brands "LVNi", "AILIPUSH", "Sai Lingsi" and "Sleeping Shark". It has trade relations with more than 40 countries and regions in the world, the total export volume is increasing continuously, and it maintains partnerships with many high-quality brand customers at home and abroad.

DEVELOPMENT PATH

After 11 years of ups and downs, LVNi Group has continued to deepen the field of commercial refrigerators, and its development momentum is extremely rapid. It has successively established Guangzhou Ailipush Refrigeration Equipment Co., Ltd., Shanghai LVNI Refrigeration Technology Co., Ltd., Beijing LVNi Intelligent Equipment Co., Ltd., Hunan LVNi Intelligent Technology Co., Ltd., Chengdu Branch and Shenzhen Branch.

LVNi Group has developed into a comprehensive enterprise integrating R&D, production and sales of commercial kitchen air-cooled refrigerators. It is committed to providing customers with competitive commercial kitchen equipment solutions and services, and is an important supplier of many well-known hotels around the world. "LVNi" has become one of the global representative brands of commercial kitchen refrigerators.

LVNi Group takes creating a world-renowned enterprise and brand as its highest mission. It is currently listed on the Hunan Equity Exchange and will strive for an IPO listing on the Beijing Stock Exchange in 2026.

INNOVATION

LVNI Group has always built R&D and innovation as its core competitiveness, and is committed to providing people with the best technology, green, and energy-saving products, and providing users with the best services of intelligent sharing. In order to meet the needs of different types of customers, the company continues to innovate. Since 2015, it has successively launched solutions in the fields of "energy-saving refrigerators", "Internet of Things air-cooled refrigerators", "personalized customized refrigerators", and "frequency conversion refrigerators".

Focusing on customer needs and technology leadership, it continues to innovate, maintains open cooperation with various industry partners, and continues to create value for customers.

LVNI Group currently has 2 invention patents and 13 practical patents. The self-developed modular unit has the characteristics of convenient loading and unloading, space saving, fast cooling, power saving and loss reduction. The company's core products have independent intellectual property rights, and have passed more than 20 domestic and foreign certifications, including ISO, CVC, energy efficiency test, salt spray test, mildew test, anti-interference noise test, five-star after-sales service, 3C, CE, ROHS, MSDS, SASO and other certifications. In terms of quality inspection and control, there is an independent testing center with a complete range of testing equipment, standardized management, and strict requirements. Products and components are designed and tested with reference to international standards to ensure product safety and stability.

HONOR

LVNI Group has successively won many honors such as "Guangdong Province AAA Credit Enterprise", "Guangdong Province Famous Brand", "Guangdong Province Contract-abiding and Credit-honoring Enterprise", "China's Most Popular Brand of Refrigeration Equipment in the Hotel Supplies Industry", "High-tech Enterprise", "A-level Taxpaying Enterprise", etc.

COMPANY CULTURE

Mission: To build a green brand, create and enjoy intelligent technology, provide competitive commercial kitchen equipment solutions and services.

Vision: To become a trusted global enterprise.

Service Concept: Greenlife be with you.

Brand Slogan: Air-cooled Freezer Pick LVNI

01

E SERIES

E Series Air-cooled Upright Chiller & freezer 01

E Series Air-cooled Counter Chiller & freezer 03

05

S SERIES

Standard Type S Series Upright Chiller & Freezer 05

Standard Type S Series Counter Chiller & Freezer 08

S Series Air-cooled Counter Chiller & Freezer With Drawers 11

S Series Air-cooled Upright Plug-in Chiller & Freezer 13

S Series Air-cooled Salad Refrigerator 16

Bottom Mounted Salad Cabinet 17

Countertop Salad Table 18

19

EU SERIES

EU Type GN Series Upright Chiller & Freezer 19

EU Type GN Series Counter Chiller & Freezer 21

23

US SERIES

US Type US Series Upright Chiller & Freezer 23

US Type US Series Counter Chiller & Freezer 25

27

Chef Base Refrigerator Series

29

BLAST FREEZER SERIES

Blast Freezer -40°C 29

Steam Oven Trolley Blast Freezer 33

Blast Chiller & Freezer Cabinets 34

35

Push-in Fridge & Freezer Series

37

Banquet Cart Chiller & Warmer

39

B SERIES

Air-cooled Stainless Steel Bar Fridge Series 39

Air-cooled Stainless Steel Bar Fridge Series 41

Beverage Display Fridge 43

Beverage Display Freezer 45

47

Wine Fridge Display 47

Wine Fridge Display 49

51

Aging Beef Display

53

Ice Cream Display 53

Cake Display 55

Four-layer Cake Showcase 57

Combi Showcase 58

Chocolate Display Cabinet (Humidity Control) 58

61

Duck Drying Cabinet

63

Cold Room Series

E | E TYPE E SERIES UPRIGHT CHILLER & FREEZER



WANBAO COMPRESSOR

- ① High efficiency
- ② Low maintenance rate



SMART THERMOSTAT

- ① Digital temperature controller
- ② Precise temperature control
- ③ Accurate to 0.1°C



FIERCE FAN COOLING CIRCULATION

- ① Air-cooled frost-free
- ② Fast cooling
- ③ Uniform cooling



THICKENED ADJUSTABLE SHELF

- ① Adjustable shelf
- ② Flexible control of space



FILLET LINER

- ① Inner liner
- ② Easy storage
- ③ Easy clean



360° UNIVERSAL WHEEL FOOT

- ① Universal wheel with brakes
- ② Easy to move and strong



- Low freezing point, high latent heat of evaporation, faster cooling rate per unit time;
- The isentropic compression ratio doing less work results in smooth operation and extends the lifespan of the compressor;
- Small molecular weight and good fluidity reduce the load on the compressor;
- Using R290 refrigerant, the energy saving rate can reach 15~35%.

E | E TYPE E SERIES UPRIGHT CHILLER & FREEZER

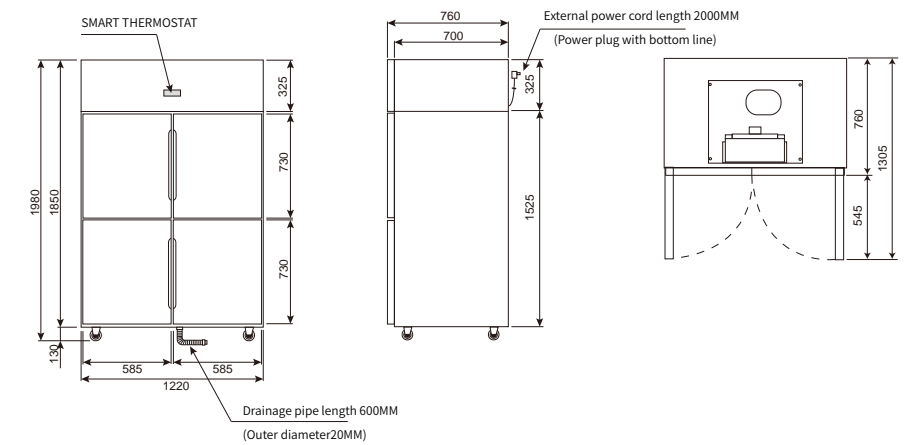
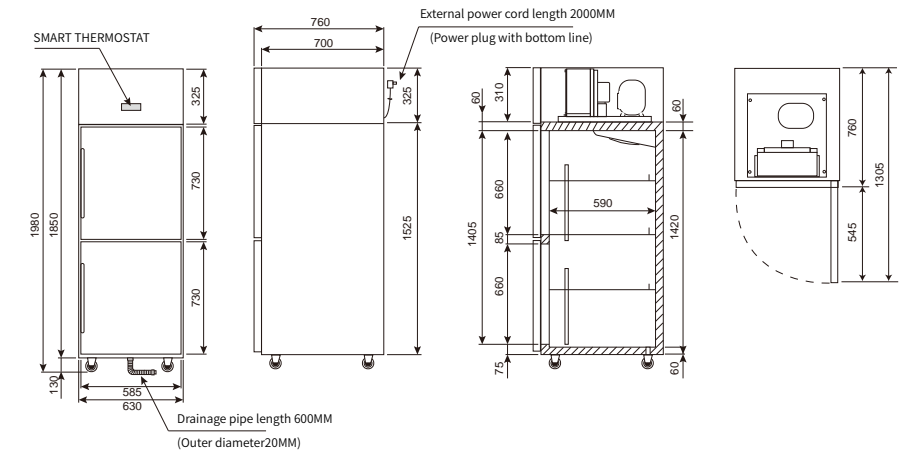

Model	Dimension (mm)	Title	System	Temp °C	Voltage	power	volume
EBC-0.5L1F	630*760*1980	1 door upright chiller	Air-cooled	2~8°C	220v/50HZ	230W	500L
EBC-0.5L1FD	630*760*1980	1 door upright freezer	Air-cooled	-10~-15°C	220v/50HZ	400W	500L
EBC-0.5L2F	630*760*1980	2 doors upright chiller	Air-cooled	2~8°C	220v/50HZ	230W	500L
EBC-0.5L2FD	630*760*1980	2 doors upright freezer.	Air-cooled	-10~-15°C	220v/50HZ	400W	500L
EBC-1.0L2F	1220*760*1980	2 doors upright chiller	Air-cooled	2~8°C	220v/50HZ	350W	1000L
EBC-1.0L2FD	1220*760*1980	2 doors counter freezer	Air-cooled	-10~-15°C	220v/50HZ	600W	1000L
EBC-1.0L2FS	1220*760*1980	2 doors dual temp. fridge	Air-cooled	2~8°C/-10~-15°C	220v/50HZ	500W	900L
EBC-1.0L4F	1220*760*1980	4 doors upright chiller	Air-cooled	2~8°C	220v/50HZ	350W	1000L
EBC-1.0L4FD	1220*760*1980	4 doors counter freezer	Air-cooled	-10~-15°C	220v/50HZ	600W	1000L
EBC-1.0L4FS	1220*760*1980	4 doors dual temp. fridge	Air-cooled	2~8°C/-10~-15°C	220v/50HZ	500W	900L

E | E TYPE E SERIES COUNTER CHILLER & FREEZER



AUTOMATIC EVAPORATION SYSTEM

- ①Automatically evaporates water
- ②No drain required



WHEELS OPTIONAL

- ①Adjustable bullet feet
- ②Stable even on uneven ground



FILLET LINER

- ①Inner liner
- ②Easy storage
- ③Easy clean



SMART THERMOSTAT

- ①Digital temperature controller
- ②Precise temperature control
- ③Accurate to 0.1°C



THICKENED ADJUSTABLE SHELF

- ①Adjustable shelf
- ②Flexible control of space



REMOVABLE SEALING STRIP

- ①Removable sealing strip
- ②Easy clean



E | E TYPE E SERIES COUNTER CHILLER & FREEZER

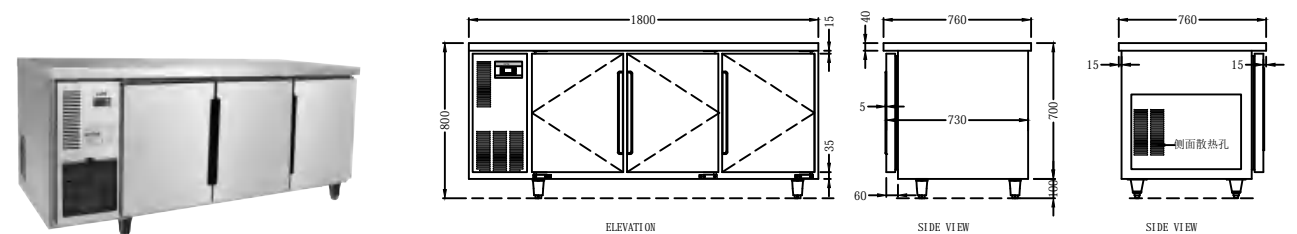
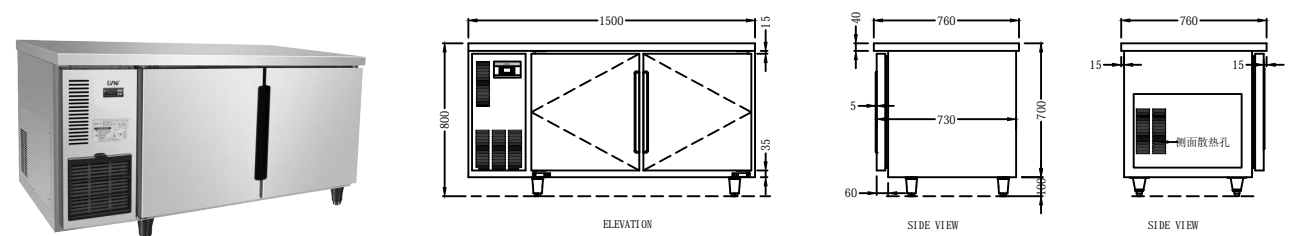
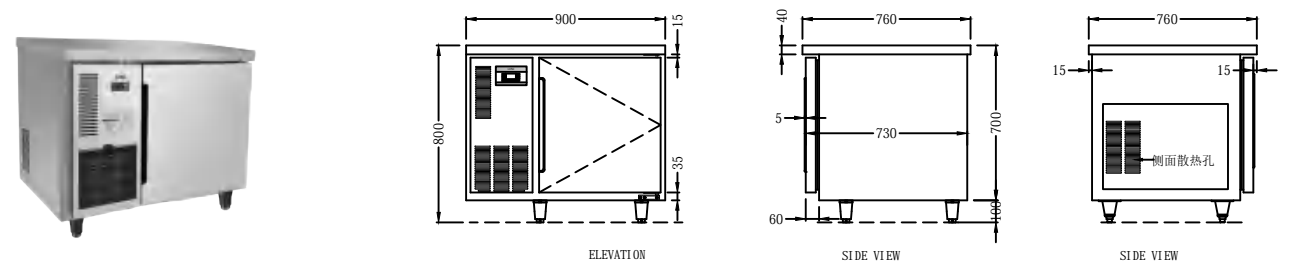

Model	Dimension (mm)	Title	System	Temp °C	Voltage	power	volume
EBG-0.1L1F	900*760*800	1 door counter chiller	Air-cooled	2~8°C	220v/50HZ	150W	180L
EBG-0.1L1FD	900*760*800	1 door counter freezer	Air-cooled	-10~-15°C	220v/50HZ	200W	180L
EBG-0.2L2F	1200*760*800	2 doors counter chiller	Air-cooled	2~8°C	220v/50HZ	180W	300L
EBG-0.2L2FD	1200*760*800	2 doors counter freezer	Air-cooled	-10~-15°C	220v/50HZ	200W	300L
EBG-0.3L2F	1500*760*800	2 doors counter chiller	Air-cooled	2~8°C	220v/50HZ	190W	390L
EBG-0.3L2FD	1500*760*800	2 doors counter freezer	Air-cooled	-10~-15°C	220v/50HZ	320W	390L
EBG-0.4L3F	1800*760*800	doors counter chiller	Air-cooled	2~8°C	220v/50HZ	230W	500L
EBG-0.4L3FD	1800*760*800	2 doors counter freezer	Air-cooled	-10~-15°C	220v/50HZ	420W	500L

S | STANDARD TYPE S SERIES UPRIGHT CHILLER & FREEZER



- Material: 201# (304#optional)
- Freezer door frame is with heating wire
- Ambient temperature+38°C
- Refrigerant: R290/R134a/R404
- Condensate evaporates automatically
- Secop compressor from Germany

MODULAR COMPRESSOR UNIT ① Detachable compressor unit design ② Easy to repair and replace	
DETACHABLE DUST FILTER ① Removable condenser filter ② Easy to clean and repair	
SECOP COMPRESSOR FROM GERMANY ① High efficiency ② Low humidity ③ Low maintenance rate	
SMART THERMOSTAT ① Digital temperature controller ② Precise temperature control ③ Accurate to 0.1°C	
FIERCE FAN COOLING CIRCULATION ① Air-cooled frost-free ② Fast cooling ③ Uniform cooling	
THICKENED ADJUSTABLE SHELF ① Adjustable shelf ② Flexible control of space	
FILLET LINER ① Inner liner ② Easy storage ③ Easy clean	
360 ° UNIVERSAL WHEEL FOOT ① Universal wheel with brakes ② Easy to move and strong	
AUTOMATIC EVAPORATION SYSTEM ① Automatically evaporates water ② No drain required	

S | STANDARD TYPE S SERIES UPRIGHT CHILLER & FREEZER

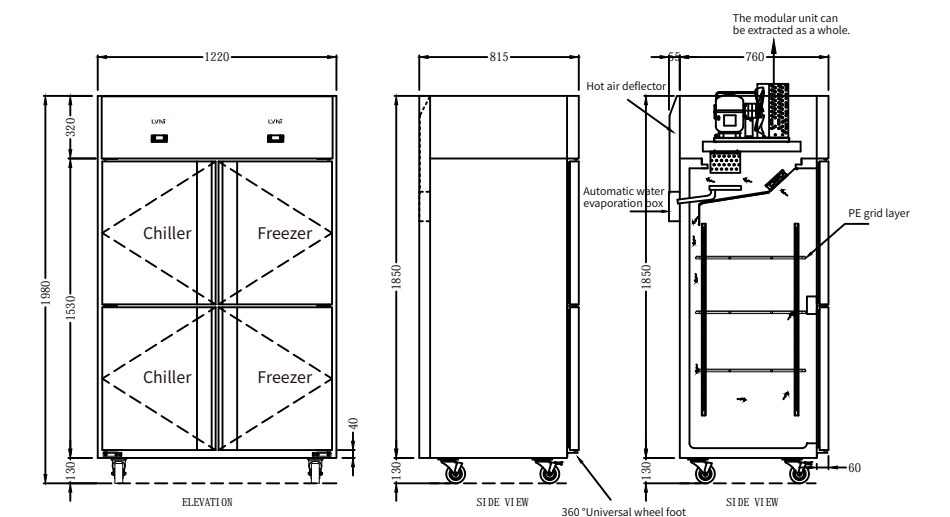
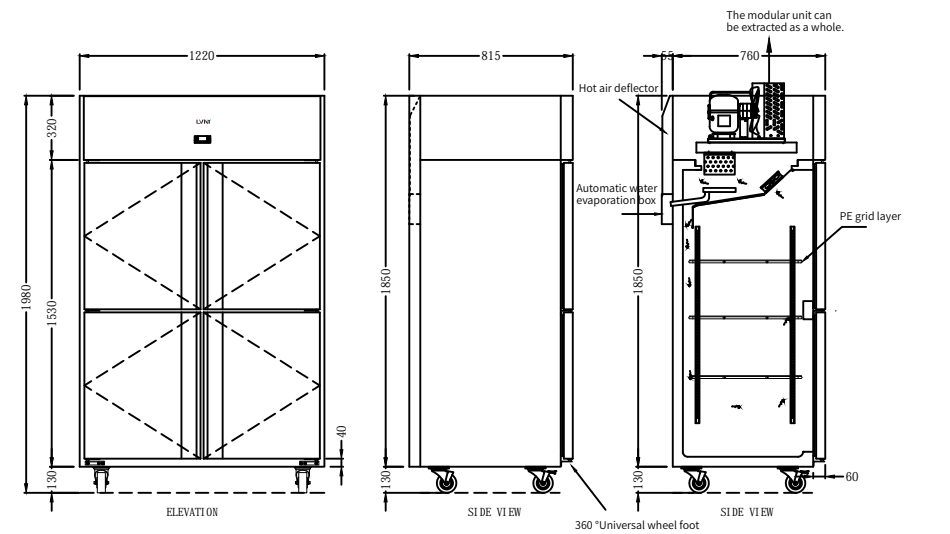
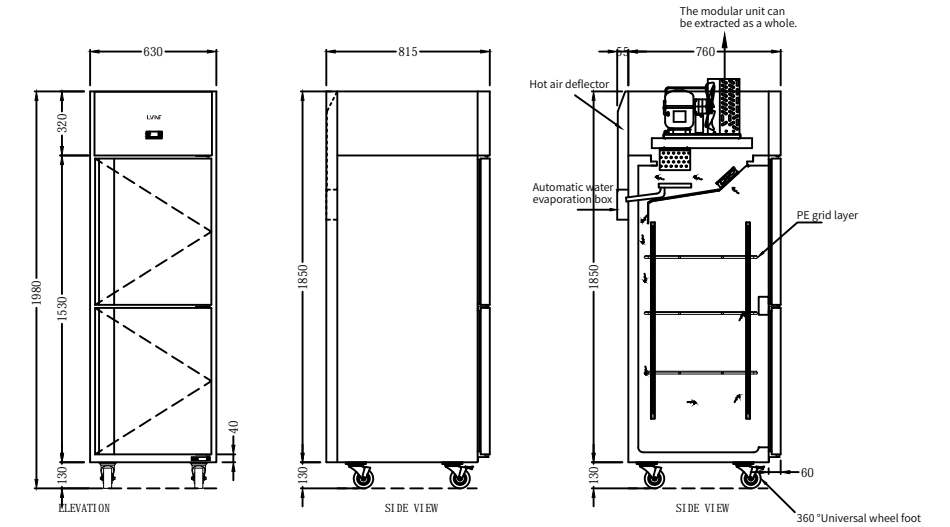

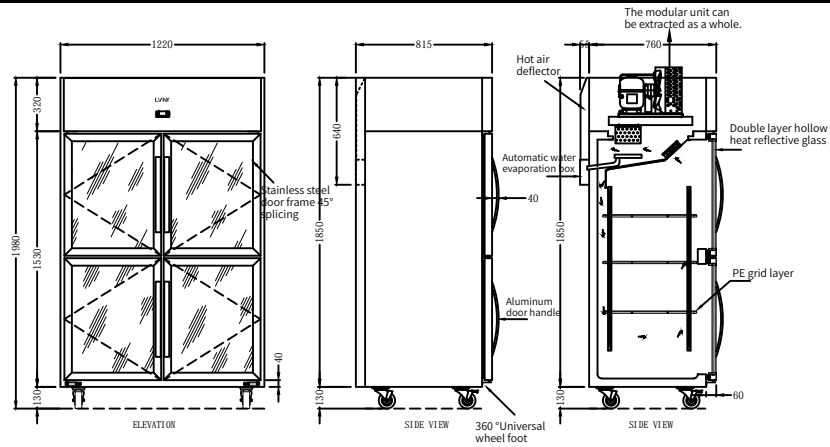
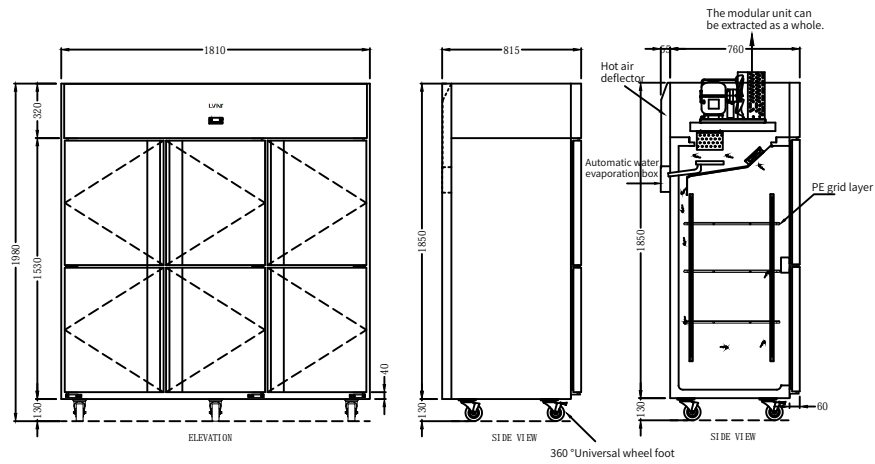

S | STANDARD TYPE S SERIES COUNTER CHILLER & FREEZER



The depth of 760mm is for direct drainage of condensate, and the depth of 815mm is for automatic evaporation of condensate.

Model explanation

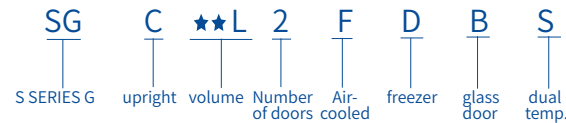

Model	Dimension (mm)	Title	System	Temp °C	Voltage	power	volume
SGC-0.5L2F	630*760/815*1980	2 doors upright chiller	Air-cooled	2~8°C	220v/50HZ	230W	500L
SGC-0.5L2FD	630*760/815*1980	2 doors upright freezer	Air-cooled	-18~-23°C	220v/50HZ	400W	500L
SGC-1.0L2F	1220*760/815*1980	2 doors upright chiller	Air-cooled	2~8°C	220v/50HZ	350W	1000L
SGC-1.0L2FD	1220*760/815*1980	2 doors upright freezer	Air-cooled	-18~-23°C	220v/50HZ	600W	1000L
SGC-1.0L2FS	1220*760/815*1980	2 doors dual temp.fridge	Air-cooled	2~8°C/-18~-23°C	220v/50HZ	500W	900L
SGC-1.0L4F	1220*760/815*1980	4 doors upright chiller	Air-cooled	2~8°C	220v/50HZ	350W	1000L
SGC-1.0L4FD	1220*760/815*1980	4 doors upright freezer	Air-cooled	-18~-23°C	220v/50HZ	600W	1000L
SGC-1.0L4FS	1220*760/815*1980	4 doors dual temp.fridge	Air-cooled	2~8°C/-18~-23°C	220v/50HZ	500W	900L
SGC-1.6L6F	1810*760/815*1980	6 doors upright chiller	Air-cooled	2~8°C	220v/50HZ	540W	1580L
SGC-1.6L6FD	1810*760/815*1980	6 doors upright freezer	Air-cooled	-18~-23°C	220v/50HZ	965W	1580L
SGC-1.6L6FS	1810*760/815*1980	6 doors dual temp.fridge	Air-cooled	2~8°C/-18~-23°C	220v/50HZ	850W	1580L
SGC-0.5L2FB	630*760/815*1980	2 glass doors upright chiller	Air-cooled	2~8°C	220v/50HZ	230W	500L
SGC-1.0L4FB	1220*760/815*1980	4 glass doors upright chiller	Air-cooled	2~8°C	220v/50HZ	350W	1000L

DETACHABLE DUST FILTER ①Removable condenser filter ②Easy to clean and repair		AUTOMATIC EVAPORATION SYSTEM ①Automatically evaporates water ②No drain required	
WHEELS OPTIONAL ①Adjustable bullet feet ②Stable even on uneven ground		90° AUTOMATIC RETURN DOOR ①90° Automatic Return Door ②Avoid energy loss	
FILLET LINER ①Inner liner ②Easy storage ③Easy clean		SMART THERMOSTAT ①Digital temperature controller ②Precise temperature control ③Accurate to 0.1°C	
THICKENED ADJUSTABLE SHELF ①Adjustable shelf ②Flexible control of space		REMOVABLE SEALING STRIP ①Removable sealing strip ②Easy clean	

S | STANDARD TYPE S SERIES COUNTER CHILLER & FREEZER

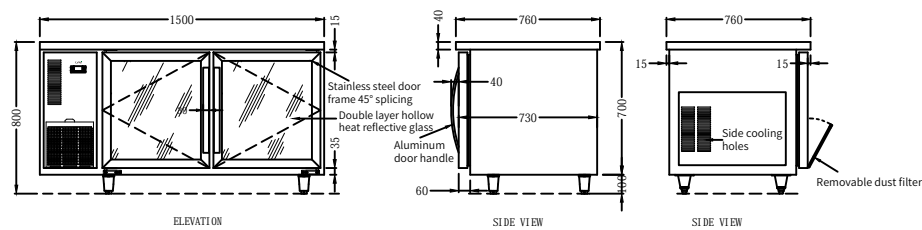
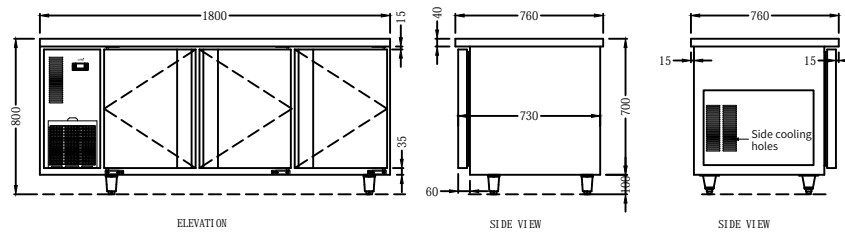
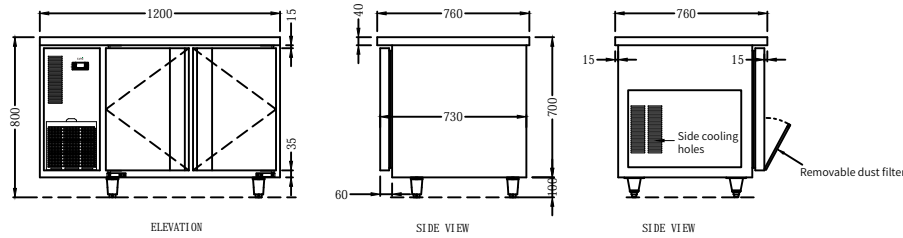
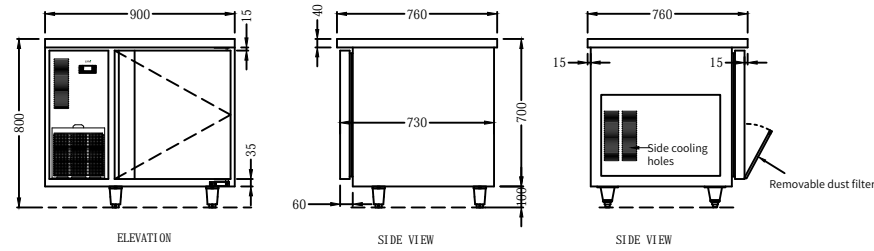

- Material : 201# (304#optional)
- Freezer door frame is with heating wire
- Ambient temperature : +38°C
- Refrigerant: R290/R134a/R404
- Condensate evaporates automatically
- Secop compressor from Germany

Model explanation

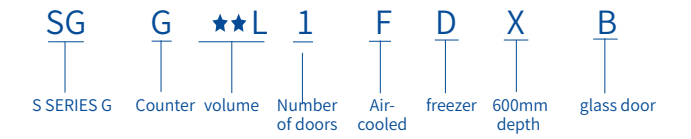

Model	Dimension (mm)	Title	System	Temp °C	Voltage	power	volume
SGG-0.1L1F	900*760*800	1 door counter chiller	Air-cooled	2~8°C	220v/50HZ	150W	180L
SGG-0.1L1FD	900*760*800	1 door counter freezer	Air-cooled	-18~-23°C	220v/50HZ	200W	180L
SGG-0.2L2F	1200*760*800	2 doors counter chiller	Air-cooled	2~8°C	220v/50HZ	180W	300L
SGG-0.2L2FD	1200*760*800	2 doors counter freezer	Air-cooled	-18~-23°C	220v/50HZ	220W	300L
SGG-0.3L2F	1500*760*800	2 doors counter chiller	Air-cooled	2~8°C	220v/50HZ	190W	390L
SGG-0.3L2FD	1500*760*800	2 doors counter freezer	Air-cooled	-18~-23°C	220v/50HZ	320W	390L
SGG-0.4L3F	1800*760*800	3 doors counter chiller	Air-cooled	2~8°C	220v/50HZ	230W	500L
SGG-0.4L3FD	1800*760*800	3 doors counter freezer	Air-cooled	-18~-23°C	220v/50HZ	320W	500L
SGG-0.2L2FB	1200*760*800	2 glass doors counter chiller	Air-cooled	2~8°C	220v/50HZ	180W	300L
SGG-0.3L2FB	1500*760*800	2 glass doors counter chiller	Air-cooled	2~8°C	220v/50HZ	190W	390L
SGG-0.4L3FB	1800*760*800	3 glass doors counter chiller	Air-cooled	2~8°C	220v/50HZ	230W	500L

S SERIES AIR-COOLED COUNTER CHILLER & FREEZER WITH DRAWERS

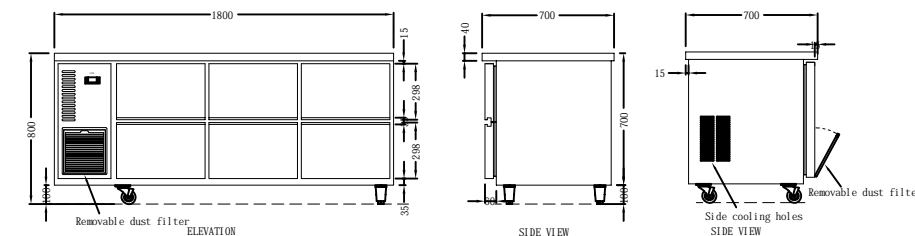
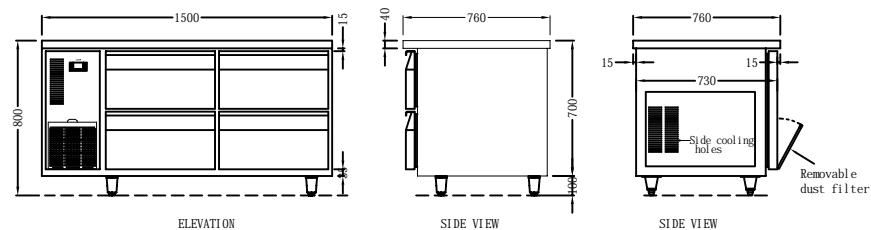

- Ambient temperature : +38°C
- Condensate evaporates automatically
- Secop compressor from Germany
- Material : 201# (304#) optional
- Refrigerant: R290/R134a/R404

Model explanation

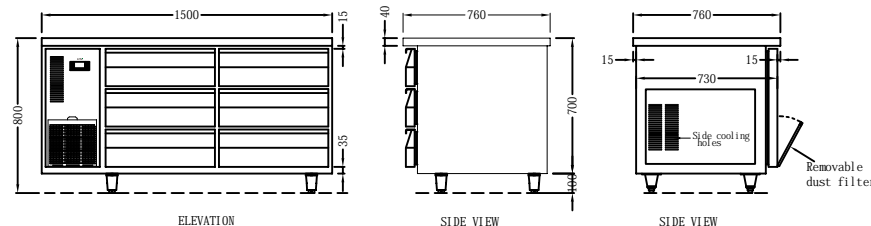
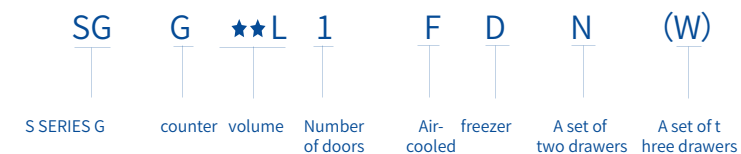

Model	Dimension (mm)	Title	System	Temp C	Voltage	Power	Drawer
SGG-0.1L1FN	900*760*800	2 drawers counter chiller	Air-cooled	2~8°C	220v/50HZ	550W	2
SGG-0.2L2FNN	1200*760*800	4 drawers counter chiller	Air-cooled	2~8°C	220v/50HZ	550W	4
SGG-0.3L2FNN	1500*760*800	4 drawers counter chiller	Air-cooled	2~8°C	220v/50HZ	550W	4
SGG-0.4L3FNNN	1800*760*800	6 drawers counter chiller	Air-cooled	2~8°C	220v/50HZ	660W	6
SGG-0.1L1FW	900*760*800	3 drawers counter chiller	Air-cooled	2~8°C	220v/50HZ	550W	3
SGG-0.2L2FWW	1200*760*800	6 drawers counter chiller	Air-cooled	2~8°C	220v/50HZ	550W	6
SGG-0.3L2FWW	1500*760*800	6 drawers counter chiller	Air-cooled	2~8°C	220v/50HZ	550W	6
SGG-0.4L3FWWW	1800*760*800	9 drawers counter chiller	Air-cooled	2~8°C	220v/50HZ	660W	9

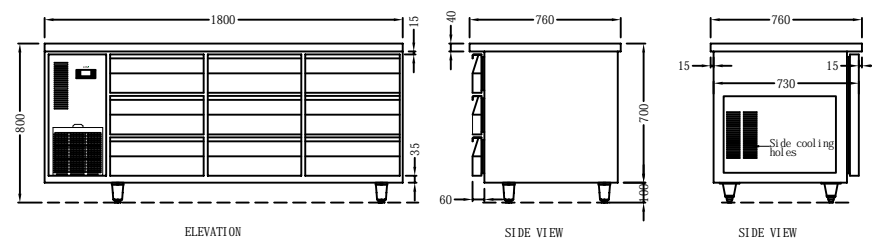

S | S SERIES AIR-COOLED UPRIGHT PLUG-IN CHILLER & FREEZER



SECO COMPRESSOR FROM GERMANY

- ① High efficiency
- ② Low humidity
- ③ Low maintenance rate

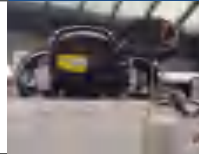

SMART THERMOSTAT

- ① Digital temperature controller
- ② Precise temperature control
- ③ Accurate to 0.1°C



FIERCE FAN COOLING CIRCULATION

- ① Air-cooled frost-free
- ② Fast cooling
- ③ Uniform cooling



ADJUSTABLE PAN GAP

- ① Suitable for placing 28 baking pans of 600*400mm
- ② The spacing is adjustable

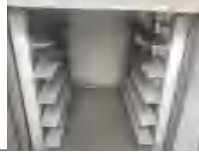

FILLET LINER

- ① Inner liner
- ② Easy storage
- ③ Easy clean



360° UNIVERSAL WHEEL FOOT

- ① Universal wheel with brakes
- ② Easy to move and strong



S | S SERIES AIR-COOLED UPRIGHT PLUG-IN CHILLER & FREEZER

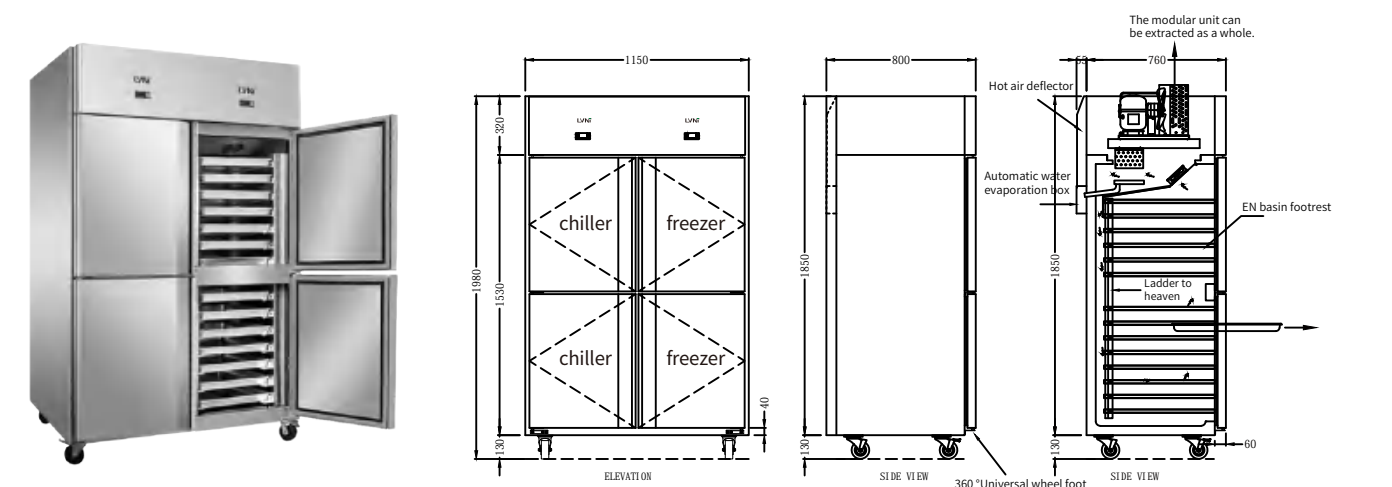
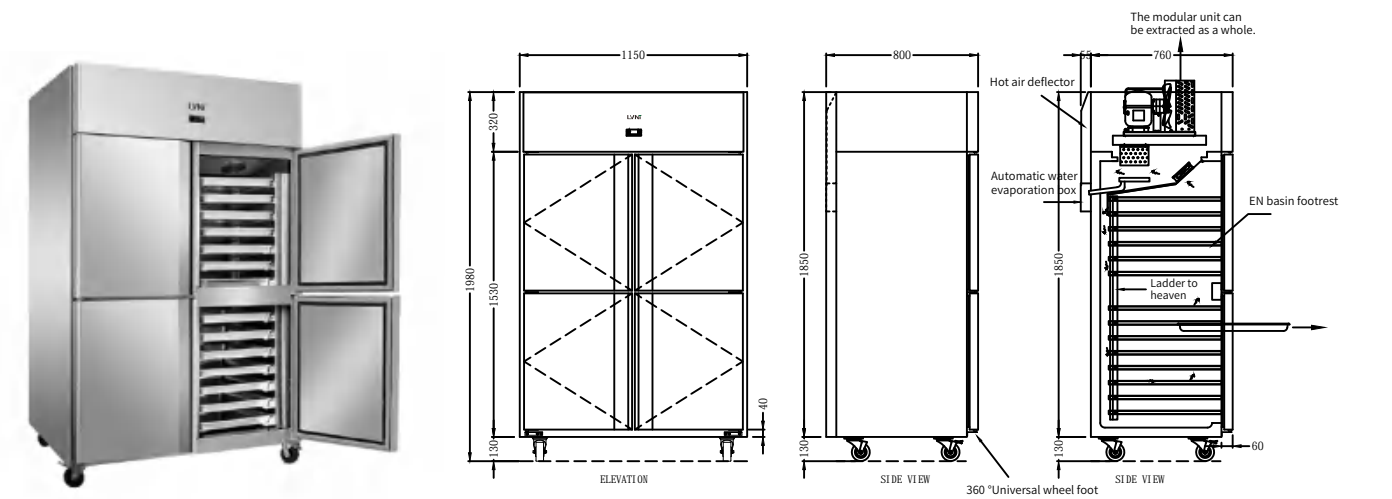
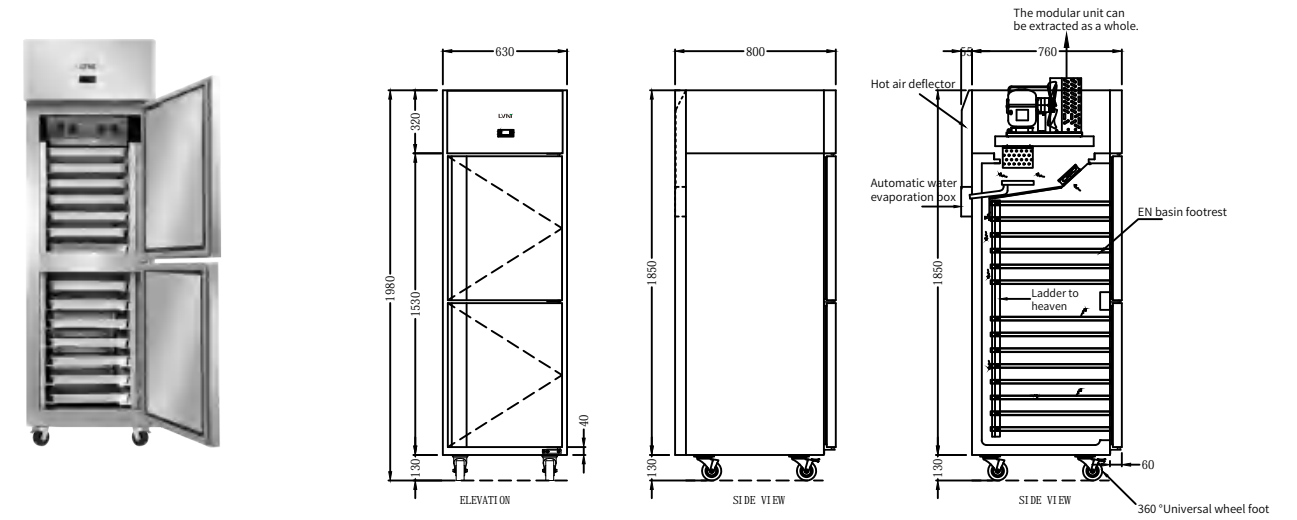

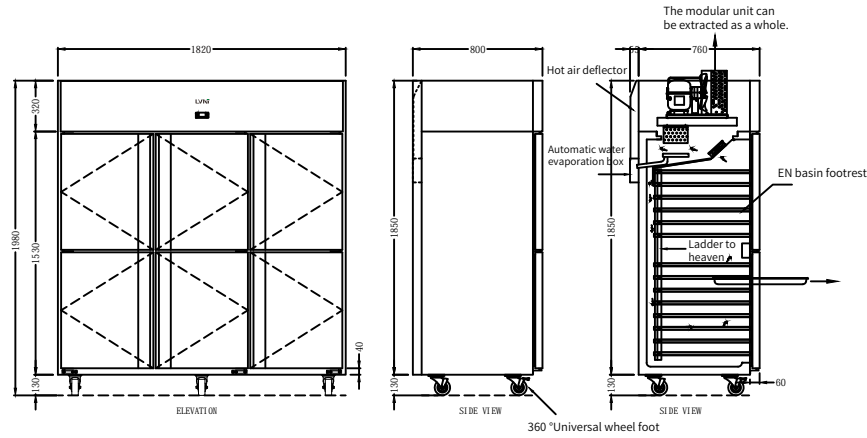

S | S SERIES AIR-COOLED SALAD REFRIGERATOR



- Material : 201#(304#) optional
- Ambient temperature : +38°C
- Freezer door frame is with heating wire
- Condensate evaporates automatically
- Refrigerant: R290/R134a/R404
- Secop compressor from Germany

Model	Dimension (mm)	Title	System	Temp °C	Voltage	power	volume
SKC-0.5L2F	620*800*1980	2 doors upright plug-in chiller	Air-cooled	2~8°C	220v/50HZ	660W	500L
SKC-0.5L2FD	620*800*1980	2 doors upright plug-in freezer	Air-cooled	-18~-23°C	220v/50HZ	990W	500L
SKC-1.0L4F	1150*800*1980	4 doors upright plug-in chiller	Air-cooled	2~8°C	220v/50HZ	770W	1000L
SKC-1.0L4FD	1150*800*1980	4 doors upright plug-in freezer	Air-cooled	-18~-23°C	220v/50HZ	1420W	1000L
SKC-1.6L6F	1820*800*1980	6 doors upright plug-in chiller	Air-cooled	2~8°C	220v/50HZ	1300W	1580L
SKC-1.6L6FD	1820*800*1980	6 doors upright plug-in freezer	Air-cooled	-18~-23°C	220v/50HZ	2200W	1580L

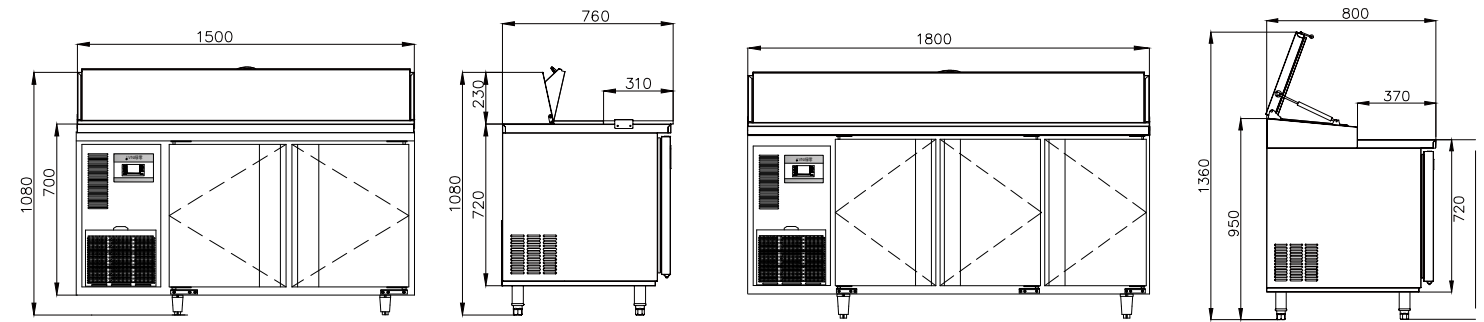

- Ambient temperature : +38°C
- Secop compressor from Germany
- Condensate evaporates automatically
- Material : 201#(304#) optional
- Refrigerant: R290/R134a/R404

Model	Dimension (mm)	Title	System	Temp °C	Voltage	power	volume
SSL-900	900*760*1050	1 door salad/pizza chiller	Air-cooled	2~8°C	220v/50HZ	285W	160L
SSL-1200	1200*760*1050	2 doors salad/pizza chiller	Air-cooled	2~8°C	220v/50HZ	550W	220L
SSL-1500	1500*760*1050	2 doors salad/pizza chiller	Air-cooled	2~8°C	220v/50HZ	550W	320L
SSL-1800	1800*760*1050	3 doors salad/pizza chiller	Air-cooled	2~8°C	220v/50HZ	660W	420L

S | BOTTOM MOUNTED SALAD CABINET

S | COUNTERTOP SALAD TABLE

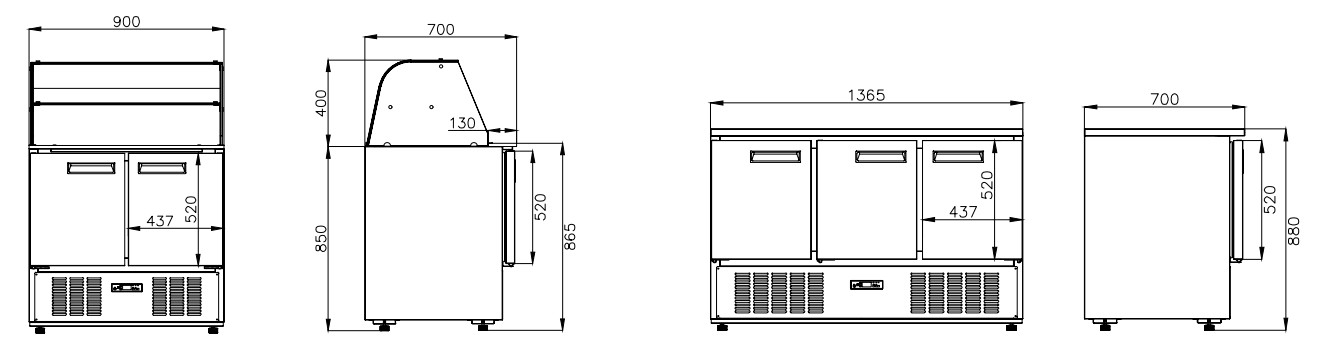
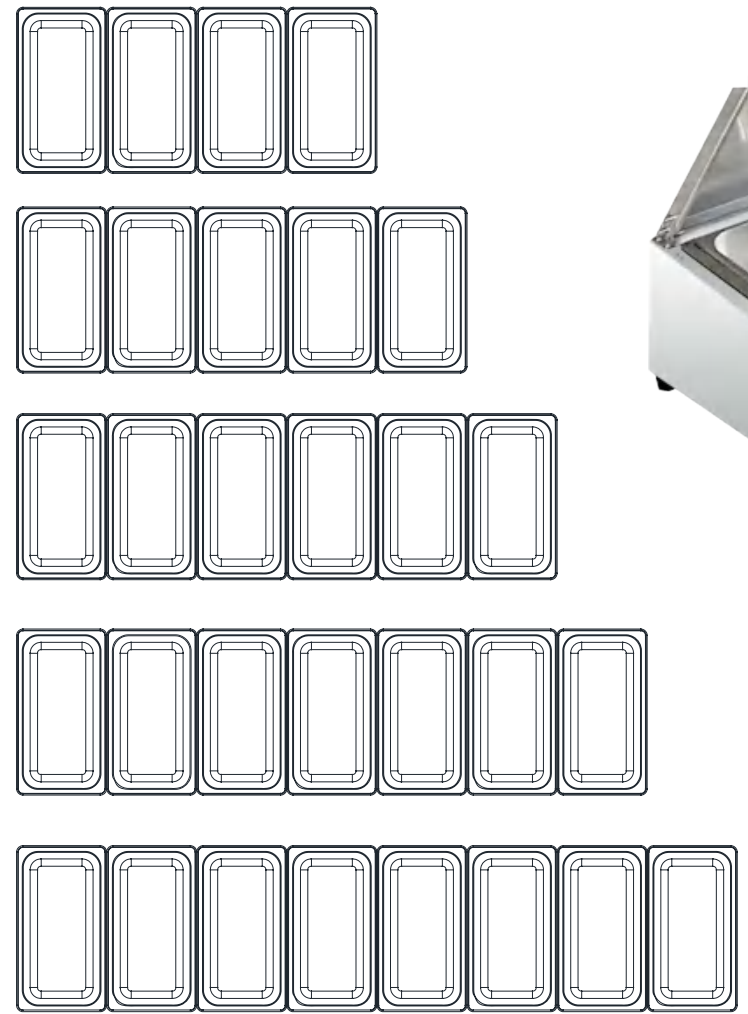

- fan-cooling frost free
- Smart thermostat
- Surrounding cooling
- All copper cooling
- Imported compressor
- Thickened stainless steel
- Efficient freshness
- Moisture proof and anti-corrosion
- Energy saving

Model	Classification	Dimensions (mm)	Power(W)	Net capacity(L)	Weight(KG)	Refrigerant	Temperature(°C)	Refrigeraton
SL900C2-GL	Salad prep table with curved glass	900x700x1250	250	220+1/1+3*1/3+3*1/6 GN	80	R134a	2°C~8°C	Static cooling
SL1365C3-GL	Salad prep table with curved glass	1365x700x1250	355	370+2*1/1+6*1/3 GN	92	R134a	2°C~8°C	Static cooling
SL900C2-S	Salad prep table with stainless steel cover	900x700x850	250	220+1/1+3*1/3+3*1/6 GN	78	R134a	2°C~8°C	Static cooling
SL1365C3-S	Salad prep table with stainless steel cover	1365x700x850	355	370+1/1+3*1/3+9*1/6 GN	88	R134a	2°C~8°C	Static cooling
SL900C2-GR	Salad prep table with marble top	900x700x1080	250	220+5*1/6 GN	105	R134a	2°C~8°C	Static cooling
SL1365C3-GR	Salad prep table with marble top	1365x700x1080	355	370+8*1/6 GN	120	R134a	2°C~8°C	Static cooling
SL900C2-S1	Salad prep table with stainless steel cover	900x700x980	250	220+5*1/6 GN	82	R134a	2°C~8°C	Static cooling
SL1365C3-S1	Salad prep table with stainless steel cover	1365x700x980	355	370+8*1/6 GN	94	R134a	2°C~8°C	Static cooling
SL900C2	Bottom-mounted workbench	900x700x850	250	220	75	R134a	2°C~8°C	Static cooling
SL1365C3	Bottom-mounted workbench	1365x700x850	355	370	85	R134a	2°C~8°C	Static cooling

Model	Classification	Dimensions (mm)	Power	Weight	Ref.	Temperature	Refrigeraton
TZ1115C-SL	Countertop Salad Table	1115*395*425	280W	25kg	R134a	2°C~8°C	Static cooling
TZ1295C-SL	Countertop Salad Table	1295*395*425	280W	30kg	R134a	2°C~8°C	Static cooling
TZ1475C-SL	Countertop Salad Table	1475*395*425	280W	35kg	R134a	2°C~8°C	Static cooling
TZ1655C-SL	Countertop Salad Table	1655*395*425	280W	40kg	R134a	2°C~8°C	Static cooling
TZ1835C-SL	Countertop Salad Table	1835*395*425	280W	45kg	R134a	2°C~8°C	Static cooling

EU | EU TYPE GN SERIES UPRIGHT CHILLER & FREEZER



SECOP COMPRESSOR FROM GERMANY

- ① High efficiency
- ② Low humidity
- ③ Low maintenance rate



SMART THERMOSTAT

- ① Digital temperature controller
- ② Precise temperature control
- ③ Accurate to 0.1°C



DIXELL CONTROLLER

- ① Digital temperature controller
- ② Precise temperature control



FIERCE FAN COOLING CIRCULATION

- ① Air-cooled frost-free
- ② Fast cooling
- ③ Uniform cooling



THICKENED ADJUSTABLE SHELF

- ① Adjustable shelf
- ② Flexible control of space



U-SHAPED DOOR HANDLE DESIGN

- ① Easy to switch on and off
- ② Out of the way



150MM HIGH ADJUSTABLE BULLET FOOT

- ① Adjustable bullet feet
- ② Stable even on uneven ground



EU | EU TYPE GN SERIES UPRIGHT CHILLER & FREEZER

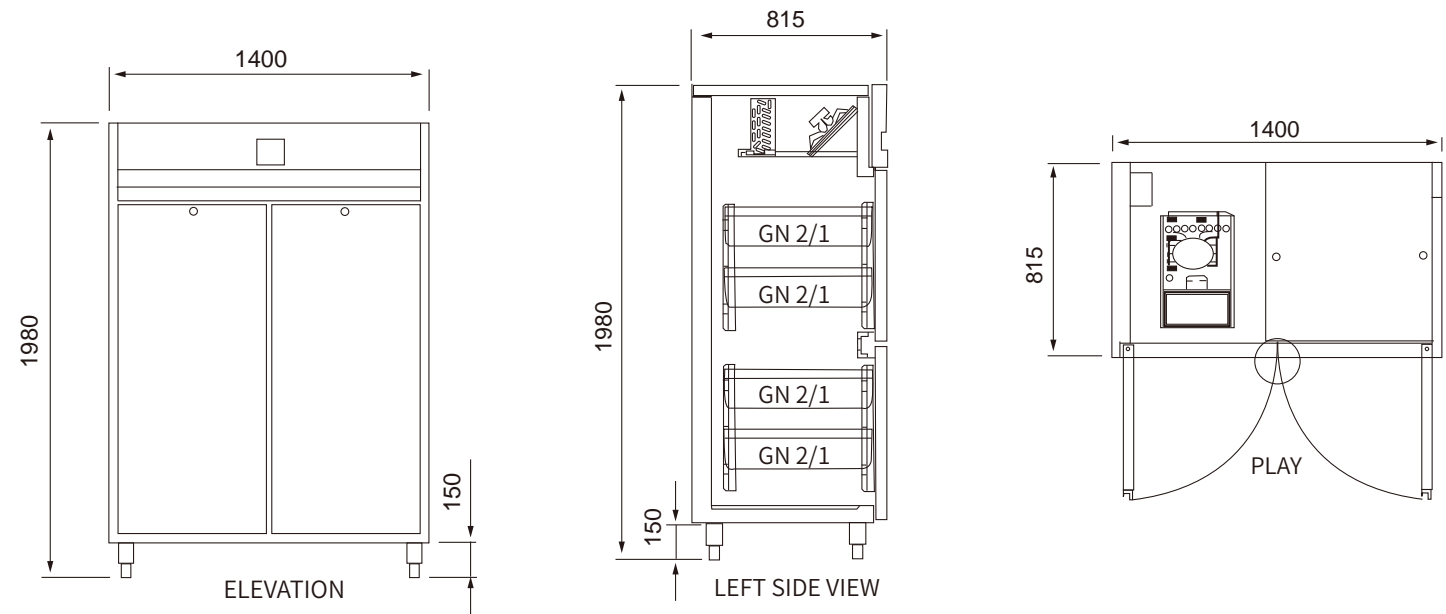

Model	Dimension (mm)	Titel	System	Temp °C	Voltage	Ref.	Volume
ALPS-0.5L1F	737*815*1980	1 door upright chiller	Air-cooled	+1~+4°C	220V/50Hz	R290	550L
ALPS-0.5L1FD	737*815*1980	1 door upright freezer	Air-cooled	-22~-18°C	220V/50Hz	R290	550L
ALPS-0.5L2F	737*815*1980	2 doors upright chiller	Air-cooled	+1~+4°C	220V/50Hz	R290	550L
ALPS-0.5L2FD	737*815*1980	2 doors upright freezer	Air-cooled	-22~-18°C	220V/50Hz	R290	550L
ALPS-1.0L2F	1415*815*1980	2 doors upright chiller	Air-cooled	+1~+4°C	220V/50Hz	R290	1170L
ALPS-1.0L2FD	1415*815*1980	2 doors upright freezer	Air-cooled	-22~-18°C	220V/50Hz	R290	1170L
ALPS-1.0L4F	1415*815*1980	4 doors upright chiller	Air-cooled	+1~+4°C	220V/50Hz	R290	1170L
ALPS-1.0L4FD	1415*815*1980	4 doors upright freezer	Air-cooled	-22~-18°C	220V/50Hz	R290	1170L
ALPS-1.0L2FL	1480*830*2010	4 doors upright freezer	Air-cooled	+1~+4°C	220V/50Hz	R290	1476L
ALPS-1.0L2FL	1480*830*2010	4 doors upright freezer	Air-cooled	-22~-18°C	220V/50Hz	R290	1476L

EU | EU TYPE GN SERIES COUNTER CHILLER & FREEZER



1/1GN COUNTER CHILLER & FREEZER

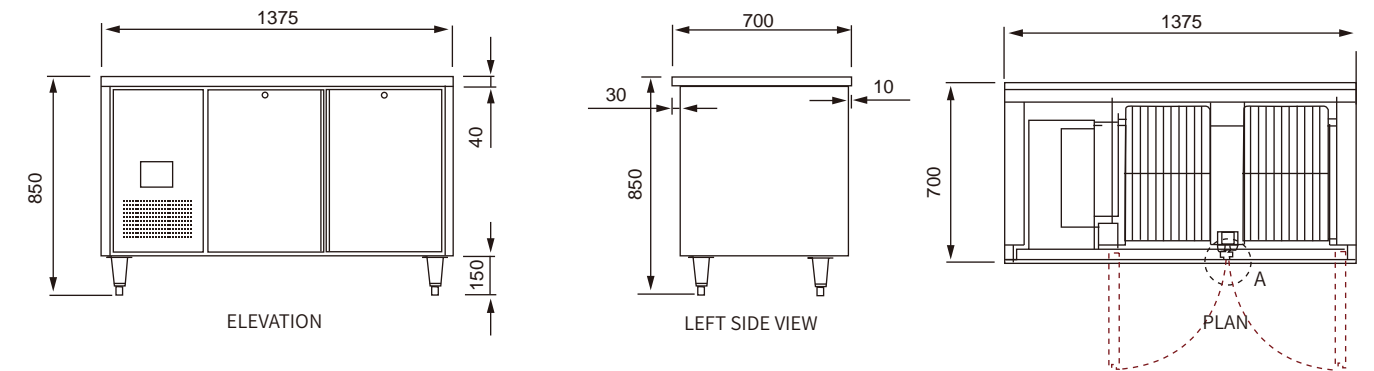

Model	Dimension (mm)	Titel	System	Temp °C	Voltage	Ref.	Volume
ALPS-0.1L1F	910*700*850	1/1gn counter chiller	Air-cooled	+1~+4°C	220V/50Hz	R290	128L
ALPS-0.1L1FD	910*700*850	1/1gn counter freezer	Air-cooled	-22~-18°C	220V/50Hz	R290	128L
ALPS-0.3L2F	1375*700*850	1/1gn counter chiller	Air-cooled	+1~+4°C	220V/50Hz	R290	280L
ALPS-0.3L2FD	1375*700*850	1/1gn counter freezer	Air-cooled	-22~-18°C	220V/50Hz	R290	280L
ALPS-0.4L3F	1840*700*850	1/1gn counter chiller	Air-cooled	+1~+4°C	220V/50Hz	R290	430L
ALPS-0.4L3FD	1840*700*850	1/1gn counter freezer	Air-cooled	-22~-18°C	220V/50Hz	R290	430L

2/1GN COUNTER CHILLER & FREEZER

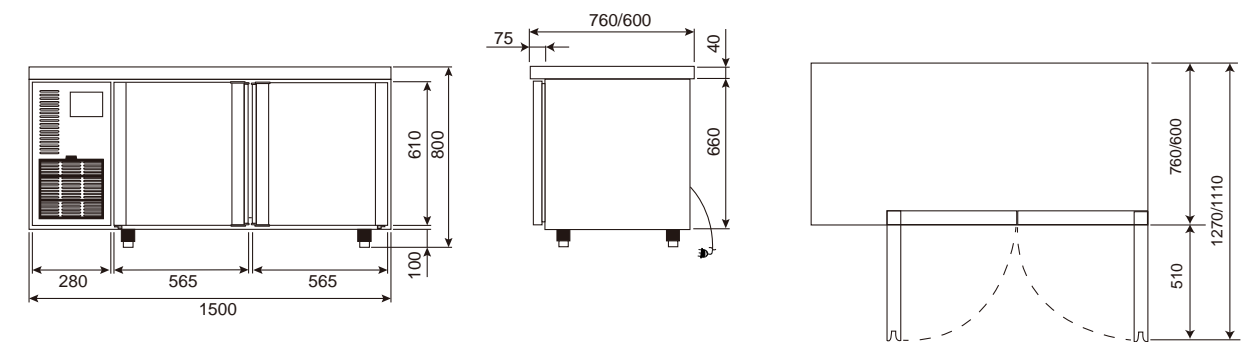

Model	Dimension (mm)	Titel	System	Temp °C	Voltage	Ref.	Volume
ALPS-0.2L1F	1115*770*850	2/1gn counter chiller	Air-cooled	+1~+4°C	220V/50Hz	R290	232L
ALPS-0.2L1FD	1115*770*850	2/1gn counter freezer	Air-cooled	-22~-18°C	220V/50Hz	R290	232L
ALPS-0.4L2F	1785*700*850	2/1gn counter chiller	Air-cooled	+1~+4°C	220V/50Hz	R290	492L
ALPS-0.4L2FD	1785*700*850	2/1gn counter freezer	Air-cooled	-22~-18°C	220V/50Hz	R290	492L

150MM HIGH ADJUSTABLE BULLET FOOT

- ①Adjustable bullet feet
- ②Stable even on uneven ground



PULL-OUT UNIT DESIGN

- ①Pull-out unit design
- ②Easy to clean and maintain



FILLET LINER

- ①Inner liner
- ②Easy storage
- ③Easy clean



DIGITAL TEMPERATURE CONTROL

- ①Digital temperature controller
- ②Precise temperature control
- ③Accurate to 0.1°C



AUTOMATIC EVAPORATION SYSTEM

- ①Automatically evaporates water
- ②No drain required



SECOP COMPRESSOR FROM GERMANY

- ①High efficiency
- ②Low humidity
- ③Low maintenance rate

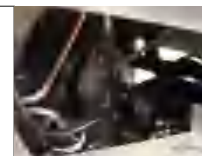

US | US TYPE US SERIES UPRIGHT CHILLER & FREEZER



EMBRACO

- ① High efficiency
- ② Low humidity
- ③ Low maintenance rate

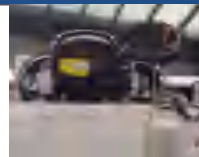

SMART THERMOSTAT

- ① Digital temperature controller
- ② Precise temperature control
- ③ Accurate to 0.1°C



FIERCE FAN COOLING CIRCULATION

- ① Air-cooled frost-free
- ② Fast cooling
- ③ Uniform cooling



THICKENED ADJUSTABLE SHELF

- ① Adjustable shelf
- ② Flexible control of space



360° UNIVERSAL WHEEL FOOT

- ① Universal wheel with brakes
- ② Easy to move and strong



BOTTOM COMPRESSOR UNIT

- ① Easier access to food
- ② A more stable center of gravity
- ③ Simpler appearance



US | US TYPE US SERIES UPRIGHT CHILLER & FREEZER



Models	Shelves	Voltage (V/Hz/Ph)	Exterior Dimensions	Capacity	Temperature
U-ALPS-0.5L1F	3	115/60/1	27x31.7x83.3(4'Castors)inch	8.3 Cu.Ft.	33~45 °F
			685x805x2115(4'Castors)mm	235 L	0~8°C
U-ALPS-0.5L1FD	3	115/60/1	27x31.7x83.3(4'Castors)inch	8.3 Cu.Ft.	-8~-1°F
			685x805x2115(4'Castors)mm	235 L	-22~-17°C
U-ALPS-1.0L2F	6	115/60/1	54.5x31.7x83.3(4'Castors)inch	43.2 Cu.Ft.	33~45°F
			1383x805x2115(4'Castors)mm	1222 L	0~8°C
U-ALPS-1.0L2FD	6	115/60/1	54.5x31.7x83.3(4'Castors)inch	43.2 Cu.Ft.	-8~-1°F
			1383x805x2115(4'Castors)mm	1222 L	-22~-17°C
U-ALPS-1.6L3F	9	115/60/1	81.9x31.7x83.3(4'Castors)inch	64.9 Cu.Ft.	33~45°F
			2079x805x2115(4'Castors)mm	1837 L	0~8°C
U-ALPS-1.6L3FD	9	115/60/1	81.9x31.7x83.3(4'Castors)inch	64.9 Cu.Ft.	-8~-1°F
			2079x805x2115(4'Castors)mm	1837 L	-22~-17°C

US | US TYPE US SERIES COUNTER CHILLER & FREEZER



AIR COOLED FROST FREE SYSTEM

- ① Air-cooled frost-free
- ② Fast cooling
- ③ Uniform cooling



WHEELS OPTIONAL

- ① Adjustable bullet feet
- ② Stable even on uneven ground



THICKENED ADJUSTABLE SHELF

- ① Adjustable shelf
- ② Flexible control of space



SMART THERMOSTAT

- ① Digital temperature controller
- ② Precise temperature control
- ③ Accurate to 0.1°C



REAR-MOUNTED COMPRESSOR UNIT

- ① Space-saving and Increased cooling capacity
- ② Sleeker appearance
- ③ Ease of maintenance and cleaning

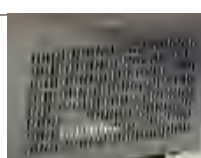

REMOVABLE SEALING STRIP

- ① Removable sealing strip
- ② Easy clean

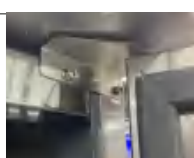

US | US TYPE US SERIES UPRIGHT CHILLER & FREEZER



Models	Shelves	Voltage (V/Hz/Ph)	Exterior Dimensions	Capacity	Temperature
U-ALPUS-0.1L1F	2	115/60/1	27.5×30×37.2/34.4(5'Castors /2'Castors)inch 698×760×929 mm	43.2 Cu.Ft 114 L	33~45°F 0~8°C
U-ALPS-0.1L1FD	2	115/60/1	27.5×30×37.2/34.4(5'Castors /2'Castors)inch 698×760×929 mm	4 Cu.Ft 114 L	-8~1°F 22~-17°C
U-ALPS-0.2L2F	2	115/60/1	48.2×30×37.2/34.4(5'Castors/2'Castors)inch 1225×760×929 mm	13.4 Cu.Ft. 379 L	33~45°F 0~8°C
U-ALPS-0.2L2FD	2	115/60/1	48.2×30×37.2/34.4(5'Castors/2'Castors)inch 1225×760×929 mm	13.4 Cu.Ft. 379 L	-8~1°F -22~-17°C
U-ALPS-0.3L2F	2	115/60/1	60.2×30×37.2/34.4(5'Castors /2'Castors)inch 1530×760×929 mm	17.2 Cu.Ft. 487 L	33~45 °F 0~8°C
U-ALPS-0.3L2FD	2	115/60/1	60.2×30×37.2/34.4(5'Castors /2'Castors)inch 1530×760×929 mm	17.2 Cu.Ft. 487 L	-8~1°F -22~-17°C
U-ALPS-0.4L3F	3	115/60/1	72.7×30×37.2/34.4(5'Castors/2'Castors)inch 1846×760×929 mm	21.1 Cu.Ft. 598 L	33~45 °F 0~8°C
U-ALPS-0.4L3FD	3	115/60/1	72.7×30×37.2/34.4(5'Castors/2'Castors)inch 1846×760×929 mm	17.2 Cu.Ft. 598L	-8~1°F -22~-17°C

CHEF BASE REFRIGERATOR SERIES



Product advantages

- 304 stainless steel shell and liner
- Galvanized bottom and back
- Suitable for 1/1GN
- Auto water evaporation system, no need drainage
- 110V/60Hz
- digital temperature control
- Pull-out unit design, easy to clean and maintain

Alternative configuration

- 304 stainless steel bottom
- 304 stainless steel back
- right unit
- Split unit optional

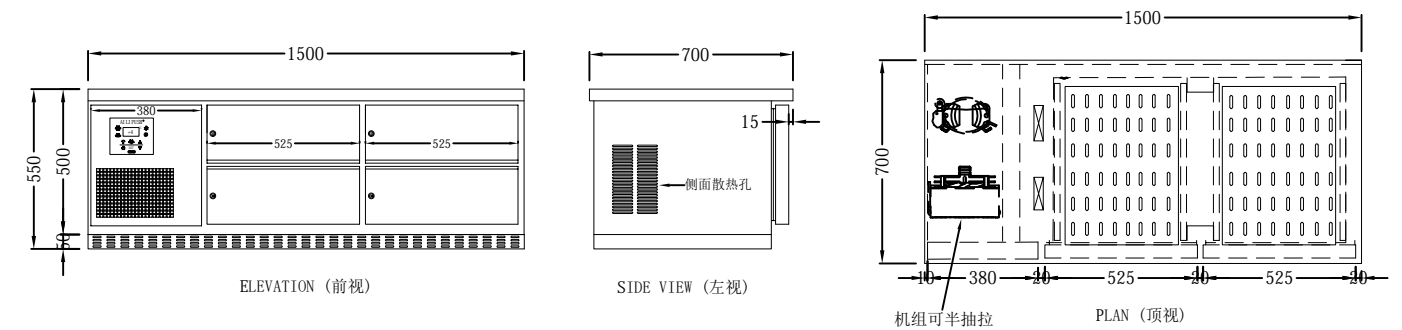

For Title : Dr=Drawer; Cb=Chefbase; R=Refrigerator; F=Freezer

Model	Dimension (mm)	Title	System	Temp °C	Voltage	Ref.	Volume
ALPS-1G1NF	1200*700*550	2Dr Cb R	Air-cooled	+1~+4°C	220V/50Hz	R134a	75L
ALPS-1G1NFM	1200*700*550	2Dr Cb R	Air-cooled	-2~+2°C	220V/50Hz	R134a	75L
ALPS-1G2NF	1500*700*550	4Dr Cb R	Air-cooled	+1~+4°C	220V/50Hz	R134a	180L
ALPS-1G2NFM	1500*700*550	4Dr Cb R	Air-cooled	-2~+2°C	220V/50Hz	R134a	180L
ALPS-1G3NF	1800*700*550	6Dr Cb R	Air-cooled	+1~+4°C	220V/50Hz	R134a	250L
ALPS-1G3NFM	1800*700*550	6Dr Cb R	Fan-cooling	-2~+2°C	220V/50Hz	R134a	250L



BLAST FREEZER

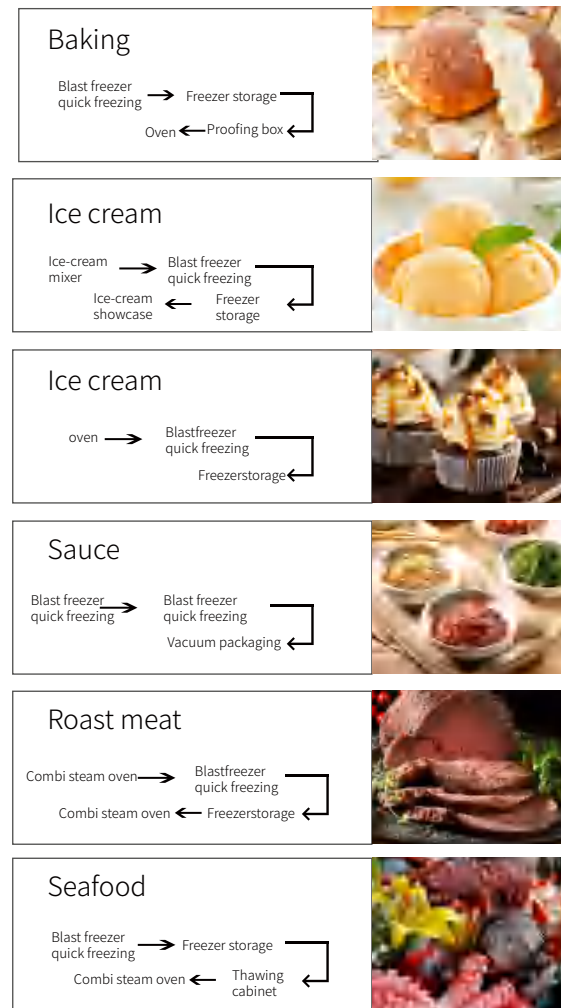

BLAST FREEZER



LN-E3B



LN-E5B

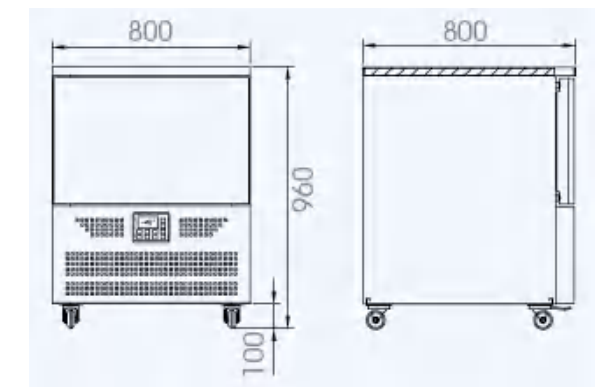

LN-E10B

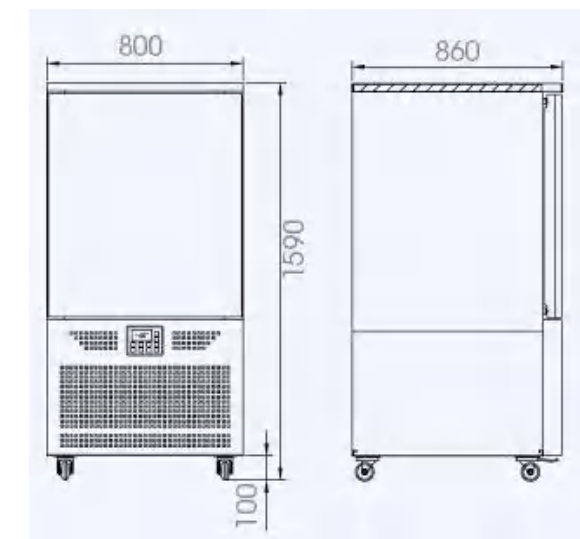



LN-E15B



LN-E15TB

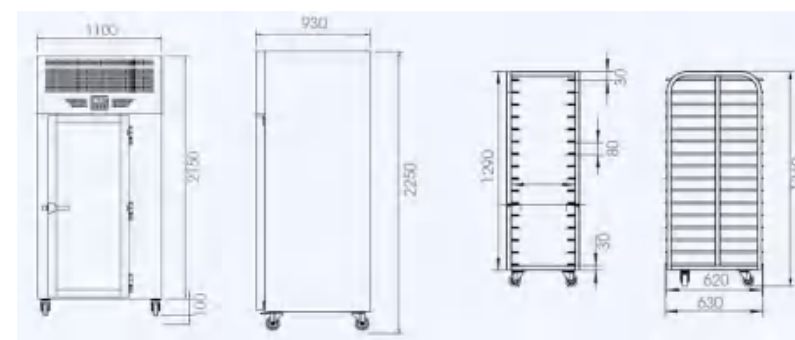

LN-E20B

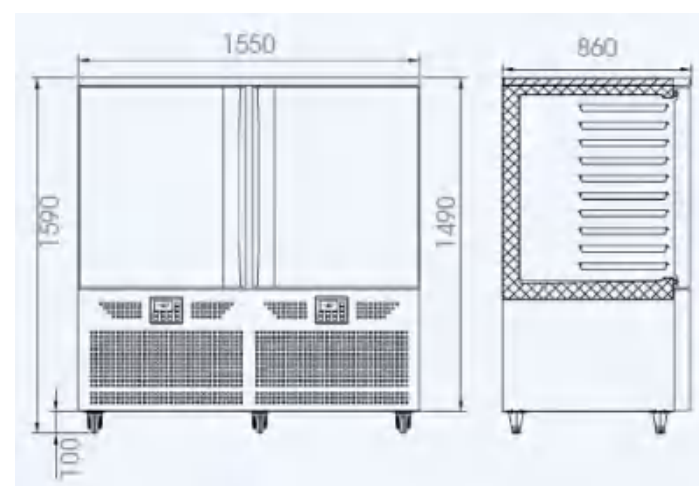

LN-E30T2B/LN-E36T2B

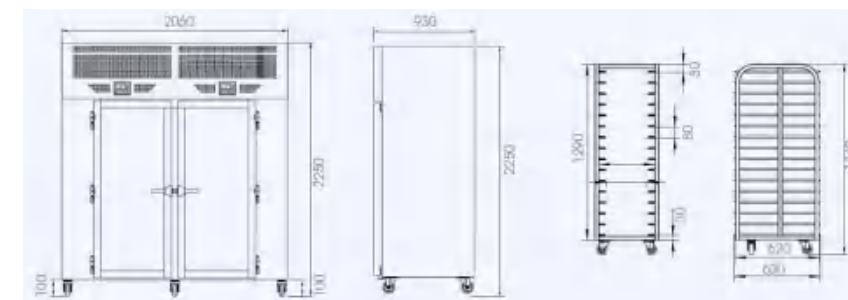

LN-E30B

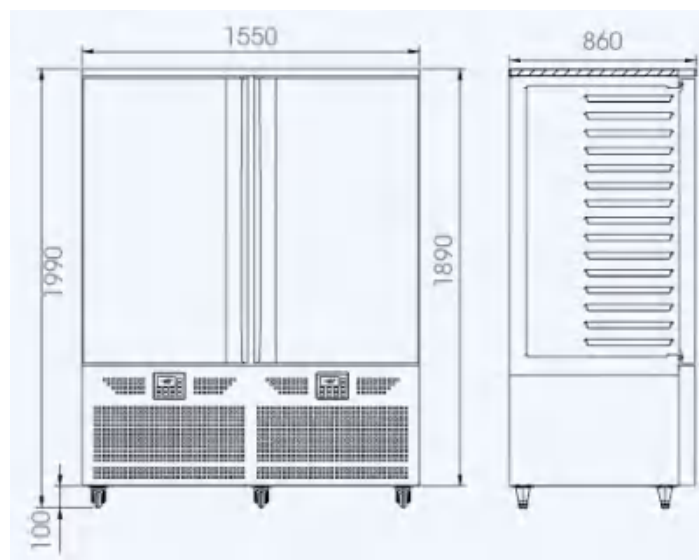

Model	Dimension (mm)	Title	System	Temp °C	Voltage	Ref.	trays
LN-E3B	860*800*586	Blast Freezer	Air-cooled	+3°C~-40°C	220V/50HZ	R290/R-404a	3trays
LN-E5B	800*870*960	Blast Freezer	Air-cooled	+3°C~-40°C	220V/50HZ	R290/R-404a	5trays
LN-E10B	800*870*1590	Blast Freezer	Air-cooled	+3°C~-40°C	220V/50HZ	R290/R-404a	10trays
LN-E15B	800*870*1990	Blast Freezer	Air-cooled	+3°C~-40°C	220V/380V/50HZ	R290/R-404a	15trays
LN-E20B	1550*870*1590	Blast Freezer	Air-cooled	+3°C~-40°C	220V/380V/50HZ	R290/R-404a	20trays
LN-E30B	1550*870*1990	Blast Freezer	Air-cooled	+3°C~-40°C	220V/380V/50HZ	R290/R-404a	30trays
LN-E15TB	1100*930*2150+100(wheel)	Blast Freezer	Air-cooled	+3°C~-40°C	220V/50HZ	R290/R-404a	15trays
LN-E30T2B	2060*930*2150+100(wheel)	Blast Freezer	Air-cooled	+3°C~-40°C	220V/50HZ	R290/R-404a	30trays
LN-E36T2B	2060*930*2150+100(wheel)	Blast Freezer	Air-cooled	+3°C~-40°C	220V/50HZ	R290/R-404a	36trays

STEAM OVEN TROLLEY BLAST FREEZER



FEATURES

- ① Fast freezing: +90 to +3 degrees/50-70minutes
- ② Deep freezing: +90 degrees to -18 degrees /120-180minutes
- ③ The equipment uses Tecumseh, BITZER and other brand compressors, special two-stage refrigeration technology, combined with mixed refrigerants and wide-fin evaporators, powerful exhaust fans, effective dynamic cooling with pressure change, uniform cooling and reduce product snow.
- ④ This product is suitable for catering, dessert, baking, ice cream, deep sea salmon and other industries.

Model	Dimension (mm)	System	Temp C	Voltage	Ref.	trays
LN-E20TZ	110*880*2300	Air-cooled	+3°C---40°C	AC380V 3N~50Hz	R-404a	20trays

BLAST CHILLER & FREEZER CABINETS

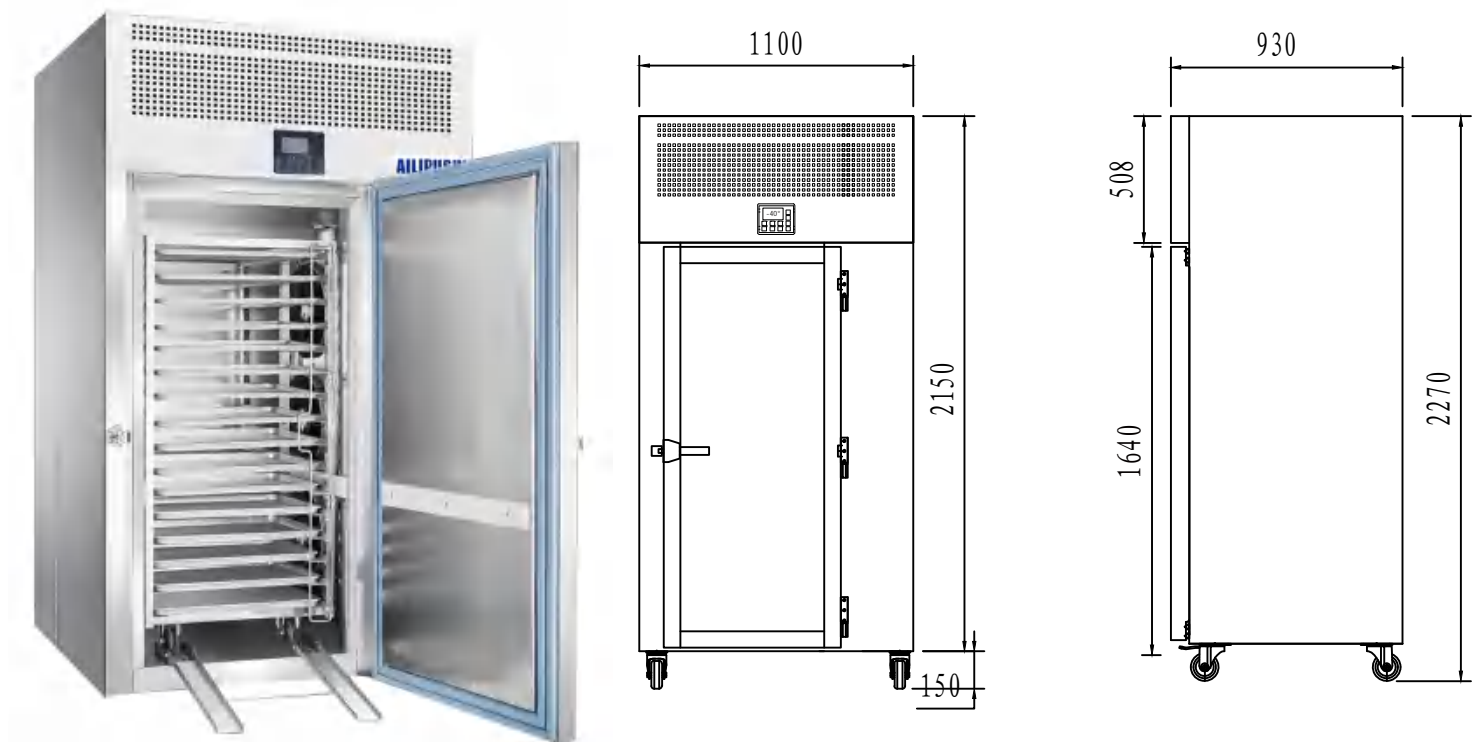

FEATURES

- ① Fast freezing: +90 to +3 degrees/50-70minutes
- ② Deep freezing: +90 degrees to -18 degrees /120-180minutes
- ③ The equipment uses Tecumseh, Embraco and other brand compressors, special two-stage refrigeration technology combined with mixed refrigerants and wide-fin evaporators, powerful exhaust fans, effective dynamic cooling with pressure change, uniform cooling and reduce product snow.
- ④ This product is suitable for catering, dessert, baking, ice cream, deep sea salmon and other industries.

Model	Dimension (mm)	System	Temp C	Voltage	Ref.	trays
LN-SCE22T	1450*1180*1940	Air-cooled	+3°C---80°C	AC380V 3N~50Hz	R-404a/R-23	20trays
LN-SCE30T	1450*1180*2240	Air-cooled	+3°C---80°C	AC380V 3N~50Hz	R-404a/R-23	30trays

PUSH-IN FRIDGE & FREEZER SERIES



Product advantages

Self evaporating, condensation water drainage not required

304 grade stainless steel exterior and interior

Accommodate 2/1 GN size

Digital Control

220~240V/50~60Hz

The liner arc design is convenient to clean

Alternative configuration

304 stainless steel back

With fluorescent or LED lights

Heated glass door in lieu of stainless steel door

Roll through door

1.5mm floor panel

Ramp with insulated floor

Latch door lock

110V/60Hz

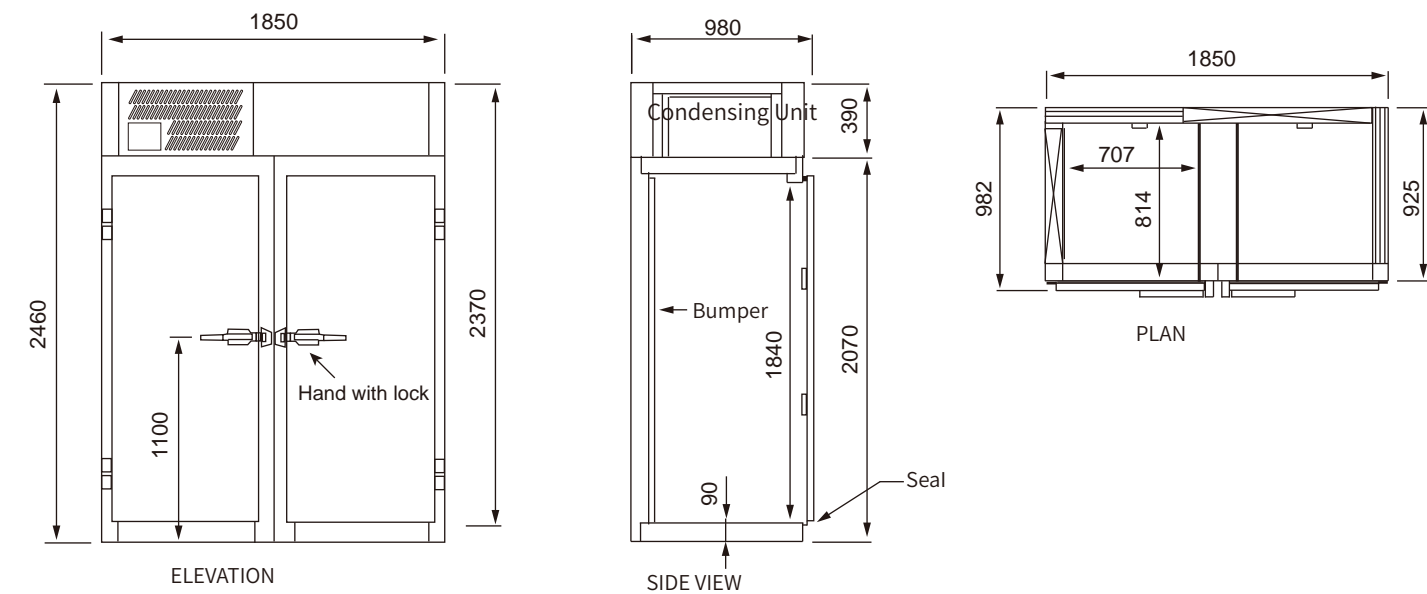

For Title: D=Door; PT=Pass Through; WI=ROLL-In; R=Refrigerator; F=Freezer

Model	Dimension (mm)	Title	System	Temp °C	Voltage	Ref.	Volume
ALPS-P1F	905*980*2460	1D WI R	Air-cooled	+1~+4°C	220V/50Hz	R134a	1035L
ALPS-P1FM	905*980*2460	1D WI R	Air-cooled	-2~+2°C	220V/50Hz	R134a	1035L
ALPS-P1FD	905*980*2460	1D WI F	Air-cooled	-22~-18°C	220V/50Hz	R404a	1035L
ALPS-P2F	1850*980*2460	2D WI R	Air-cooled	+1~+4°C	220V/50Hz	R134a	2450L
ALPS-P2FM	1850*980*2460	2D WI R	Air-cooled	-2~+2°C	220V/50Hz	R134a	2450L
ALPS-P2FD	1850*980*2460	2D WI F	Air-cooled	-22~-18°C	220V/50Hz	R404a	2450L
ALPS-P1F-PT	905*980*2460	1D PT WI R	Air-cooled	+1~+4°C	220V/50Hz	R134a	1090L
ALPS-P1FM-PT	905*980*2460	1D PT WI R	Air-cooled	-2~+2°C	220V/50Hz	R134a	1090L
ALPS-P1FD-PT	905*980*2460	1D PT WI F	Air-cooled	-22~-18°C	220V/50Hz	R404a	1090L
ALPS-P2F-PT	1850*980*2460	2D PT WI R	Air-cooled	+1~+4°C	220V/50Hz	R134a	2590L
ALPS-P2FM-PT	1850*980*2460	2D PT WI R	Air-cooled	-2~+2°C	220V/50Hz	R134a	2590L
ALPS-P2FD-PT	1850*980*2460	2D PT WI F	Air-cooled	-22~-18°C	220V/50Hz	R404a	2590L

BANQUET CART CHILLER & WARMER



SUITABLE FOR 2/1GN	
SMART THERMOSTAT ① Digital temperature control ② Precise temperature control	
304 STAINLESS STEEL SHELL AND LINER STEEL EXTERIOR AND INTERIOR	
150MM HIGH HEAVY-DUTY SWIVEL BRAKE WHEELS	
THE ARC DESIGN OF THE INNER TANK IS CONVENIENT FOR CLEANING	

ALTERNATIVE CONFIGURATION

Single door with 16 pairs of brackets

Double door with 32 pairs of brackets

220~240V/50~60Hz

110V/60Hz

BANQUET CART CHILLER & WARMER

BANQUET CART CHILLER

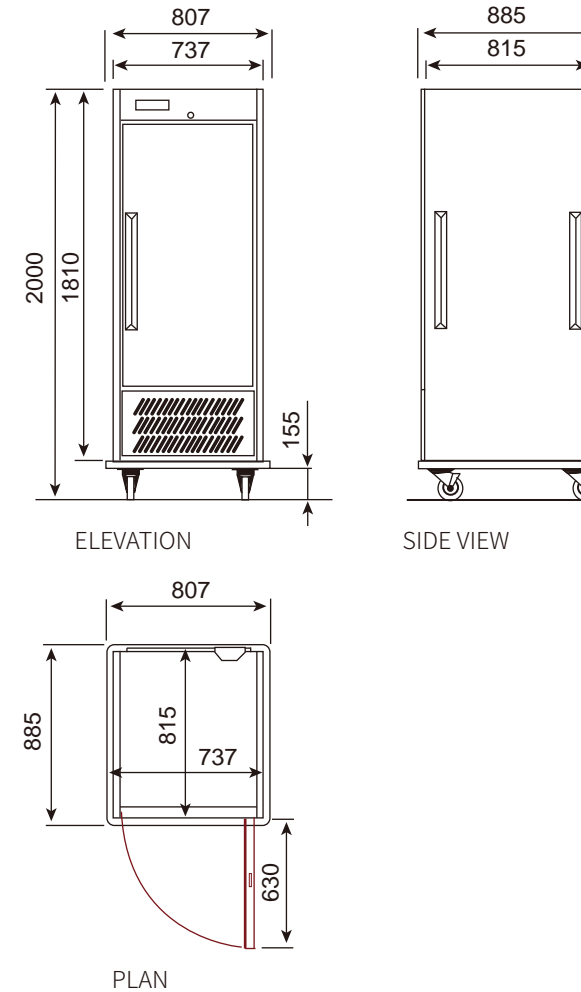

BANQUET CART WARMER

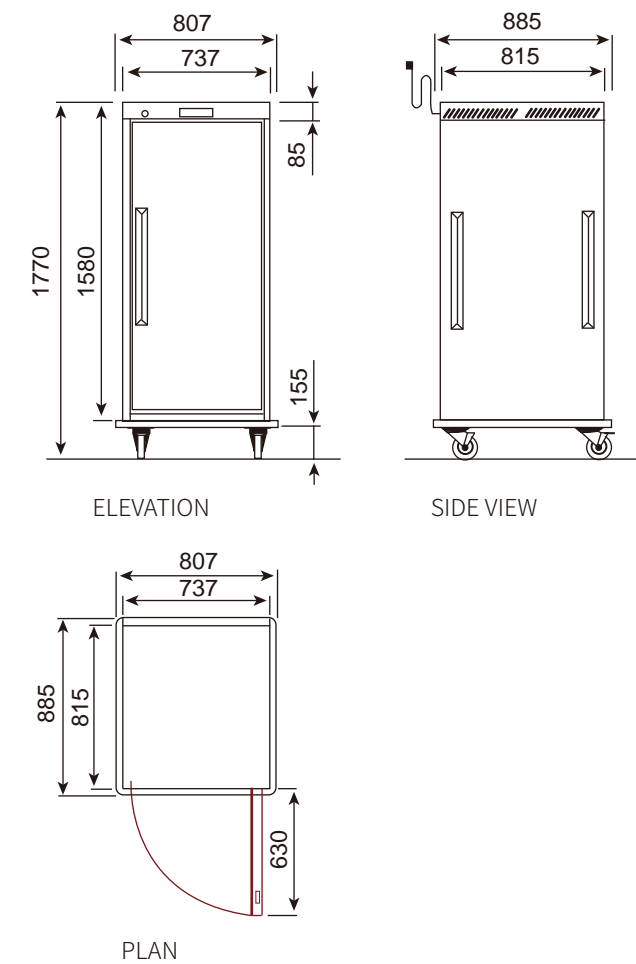

Model	Dimension (mm)	Title	System	Temp °C	Voltage	Ref.	Volume
ALPS-R1D	807*885*2000	banquet cart warmer	Air-cooled	+1~+4°C	220V/50Hz	R134a	495L
ALPS-R2D	1470*885*2000	banquet cart warmer	Air-cooled	+1~+4°C	220V/50Hz	R134a	1055L
ALPS-H1D	807*885*1770	banquet cart chiller	—	+78~+82°C	220V/50Hz	heating	525L
ALPS-H2D	1470*885*1700	banquet cart chiller	—	+78~+82°C	220V/50Hz	heating	1180L
ALPS-R16S	780*880*1760	banquet cart warmer	—	+78~+82°C	220V/50Hz	heating	550L
ALPS-C16S	780*880*2000	banquet cart chiller	Air-cooled	+4~+10°C	220V/50Hz	R134a	530L
ALPS-D16S	780*880*2000	banquet cart freezer	Air-cooled	-12~-18°C	220V/50Hz	R404a	530L
ALPS-R32S	1450*880*1760	banquet cart warmer	—	+78~+82°C	220V/50Hz	heating	1173L

B | AIR-COOLED STAINLESS STEEL BAR FRIDGE SERIES



CONCISE HANDLE

- ① Invisible door handle design
- ② Not hinder movement.



AIR COOLED FROST FREE SYSTEM

- ① Air-cooled frost-free
- ② Fast cooling
- ③ Uniform cooling



INTELLIGENT TEMPERATURE CONTROL

- ① Digital temperature controller
- ② Precise temperature control
- ③ Accurate to 0.1°C



SAFETY CHILD LOCK CONFIGURATION

- ① Prevent random opening
- ② Facilitate management.



B | AIR-COOLED STAINLESS STEEL BAR FRIDGE SERIES

- Ambient temperature :+28°C
- Refrigerant: R290/R134a/R404
- Condensate evaporates automatically

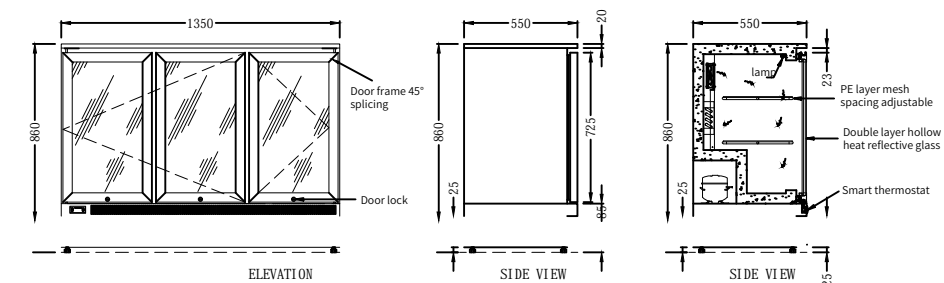
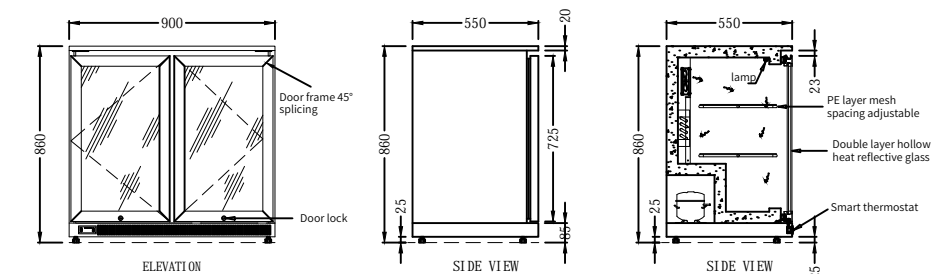
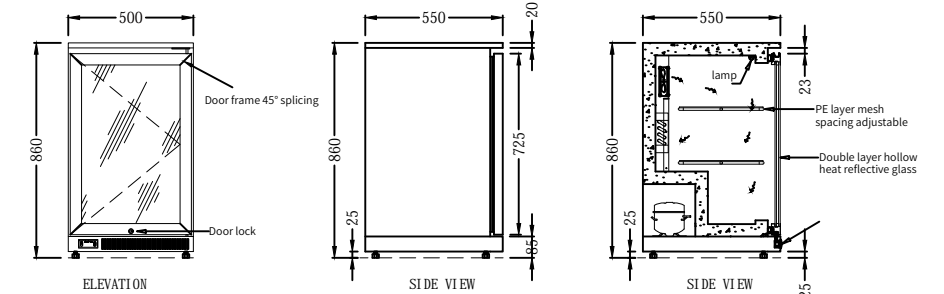

Note: freezer -10°C is optional

Model	Dimension (mm)	Title	System	Temp C	Voltage	power	volume
SHB-108LF	500*500*860	1 door bar fridge	Air-cooled	Fridge (2~8°C)	220v/50HZ	220W	108L
SHB-230L2F	900*550*860	2 doors bar fridge	Air-cooled	Fridge (2~8°C)	220v/50HZ	285W	230L
SHB-350L3F	1350*550*860	3 doors bar fridge	Air-cooled	Fridge (2~8°C)	220v/50HZ	385W	350L

B | AIR-COOLED STAINLESS STEEL BAR FRIDGE SERIES



CONCISE HANDLE

- ① Invisible door handle design
- ② Not hinder movement.



AIR COOLED FROST FREE SYSTEM

- ① Air-cooled frost-free
- ② Fast cooling
- ③ Uniform cooling



INTELLIGENT TEMPERATURE CONTROL

- ① Digital temperature controller
- ② Precise temperature control
- ③ Accurate to 0.1°C



SAFETY CHILD LOCK CONFIGURATION

- ① Prevent random opening
- ② Facilitate management.



B | AIR-COOLED STAINLESS STEEL BAR FRIDGE SERIES

■ Ambient temperature :+28°C

■ Refrigerant :R290/R134a/R404

■ Condensate evaporates automatically

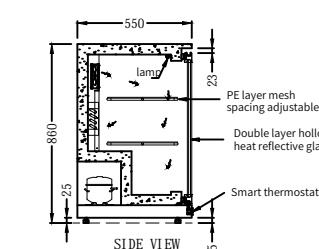
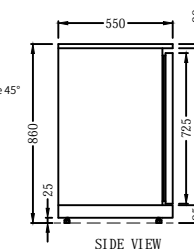
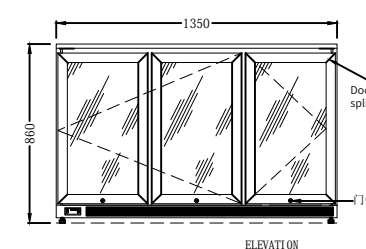
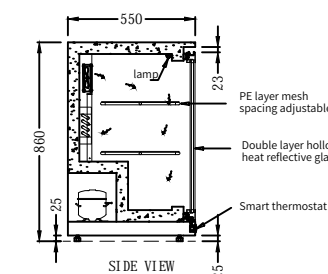
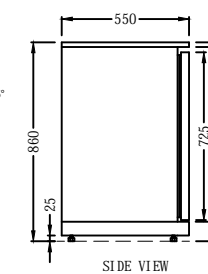
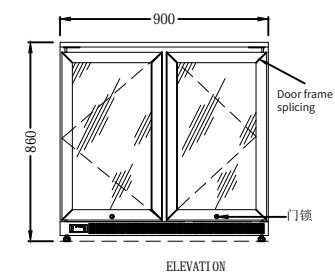
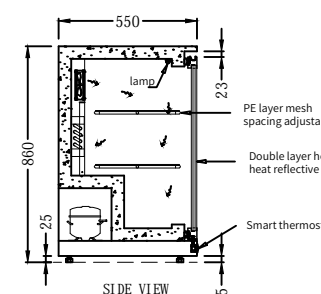
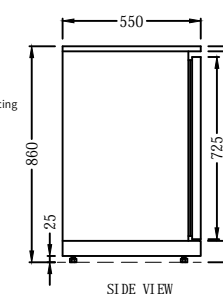
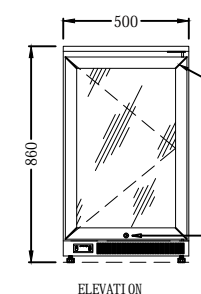

Note: freezer -10°C is optional

Model	Dimension (mm)	Title	System	Temp C	Voltage	power	volume
SGB-108LF	500*550*860	1 door stainless steel bar fridge	Air-cooled	Fridge (2~8°C)	220v/50HZ	220W	108L
SGB-230L2F	900*550*860	2 doors stainless steel bar fridge	Air-cooled	Fridge (2~8°C)	220v/50HZ	285W	230L
SGB-350L3F	1350*550*860	3 doors stainless steel bar fridge	Air-cooled	Fridge (2~8°C)	220v/50HZ	385W	350L

S | BEVERAGE DISPLAY FRIDGE



SECOP COMPRESSOR FROM GERMANY

- ① High efficiency
- ② Low humidity
- ③ Low maintenance rate



SMART THERMOSTAT

- ① Digital temperature controller
- ② Precise temperature control
- ③ Accurate to 0.1°C



FIERCE FAN COOLING CIRCULATION

- ① Air-cooled frost-free
- ② Fast cooling
- ③ Uniform cooling



DIVIDED SHELF

- ① Flexible control of space



ALUMINUM DOOR HANDLE

- ① Automatic rebound door
- ② Beautiful and not in the way



LED LIGHT

- ① Clear and beautiful display



S | BEVERAGE DISPLAY FRIDGE

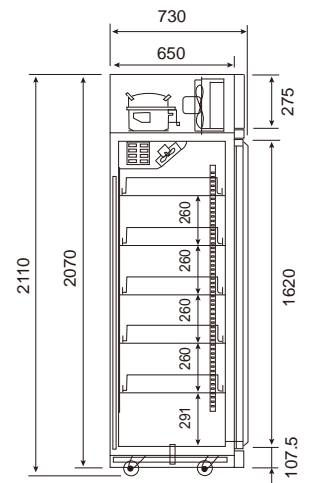
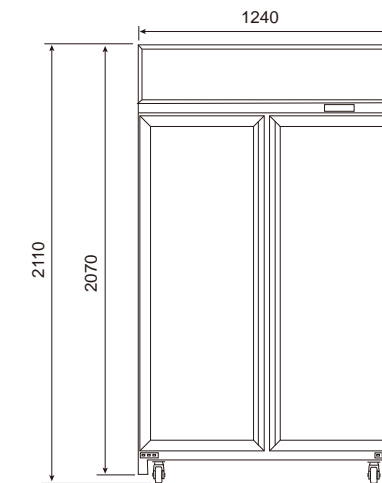

Model	Dimension (mm)	Temp C	System	Voltage	Doors	Ref.
LN-124	1240*730*2110	0~10°C	Air-cooled	220v/50HZ	2	R134a
LN-180	1800*730*2110	0~10°C	Air-cooled	220v/50HZ	3	R134a
LN-240	2400*730*2110	0~10°C	Air-cooled	220v/50HZ	4	R134a

S | BEVERAGE DISPLAY FREEZER



SECOP COMPRESSOR FROM GERMANY

- ① High efficiency
- ② Low humidity
- ③ Low maintenance rate



SMART THERMOSTAT

- ① Digital temperature controller
- ② Precise temperature control
- ③ Accurate to 0.1°C



FIERCE FAN COOLING CIRCULATION

- ① Air-cooled frost-free
- ② Fast cooling
- ③ Uniform cooling



DIVIDED SHELF

- ① Flexible control of space



Aluminum door handle

- ① Automatic rebound door
- ② Beautiful and not in the way

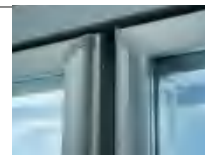

AUTOMATIC EVAPORATION SYSTEM

- ① Automatically evaporates water
- ② No drain required



ELECTRICALLY HEATED DEFOGGER DOOR (TRIPLE-LAYER GLASS)



S | BEVERAGE DISPLAY FREEZER

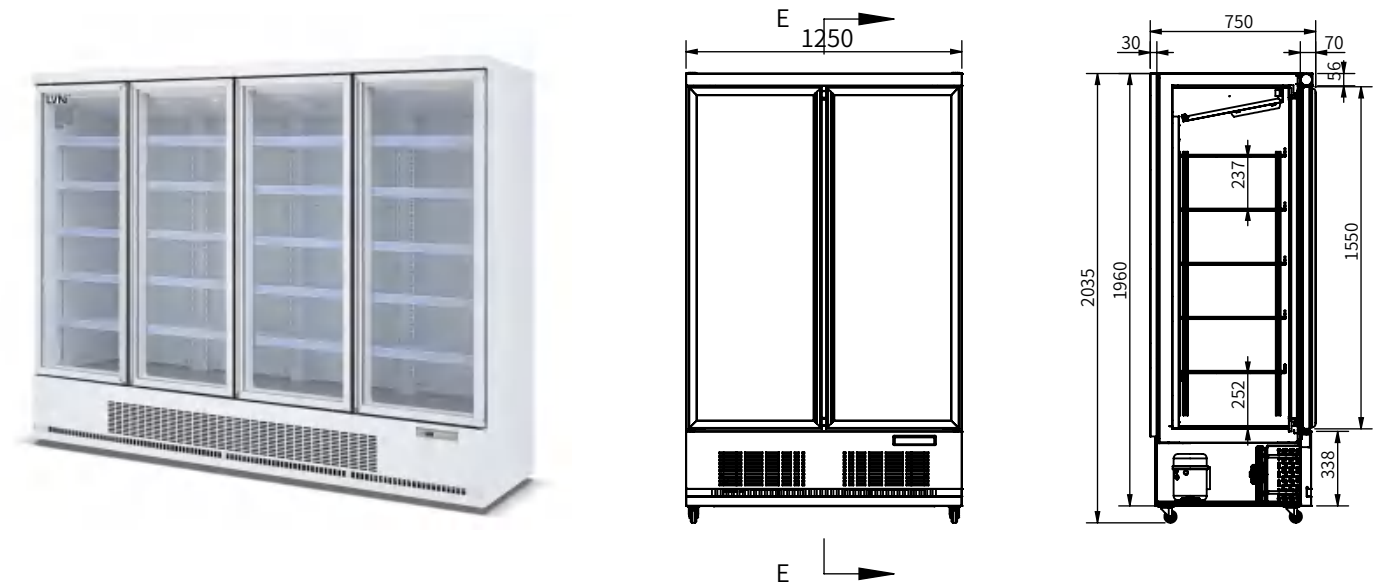

Model	Dimension (mm)	Temp C	System	power	Volume	Doors	Ref.
SD-500X	620*765*2035	-18~-22°C	Air-cooled	650W	435L	1	R290
SD-1000X	1250*765*2035	-18~-22°C	Air-cooled	1280W	990L	2	R290
SD-1500X	1880*765*2035	-18~-22°C	Air-cooled	1660W	1540L	3	R290
SD-2000X	2500*765*2035	-18~-22°C	Air-cooled	2000W	2080L	4	R290

WINE FRIDGE DISPLAY

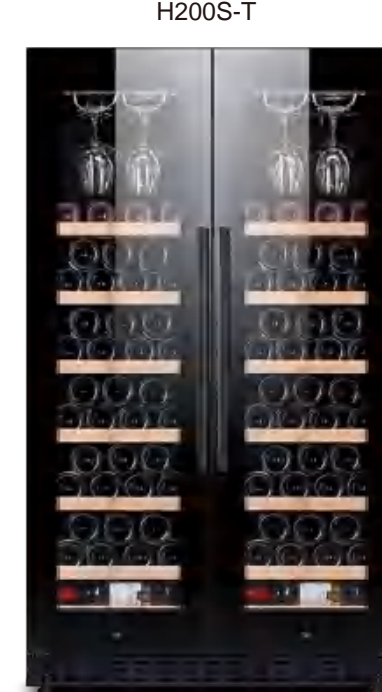

H320S-T

H320S-TD

Model	Dimension (mm)	Layers	System	Temp C	Humidity	Capacity
H200S-C	900*515*1640	8	air cooling	5~22°C Dual Temp	60-80%	200
H200S-T	900*515*1640	6	air cooling	5~22°C Dual Temp	60-80%	105
H320S-T	980*700*2000	9	air cooling	5~22°C Dual Temp	60-80%	274
H320S-TD	980*700*2000	5	air cooling	5~22°C Dual Temp	60-80%	274

WINE FRIDGE DISPLAY



PRODUCT FEATURES

- Built-in LED lighting
- Removable top evaporator section
- Digital controller for easy operation and fail-safe performance, featuring clear digital display
- Defrost water-Vvaporiser, drain connection not required
- Anti-condensation door/ drawer frame heaters
- Efficient forced air cooling system
- 220~240V/50~60Hz
- The liner arc design is convenient to clean
- Slanted chrome coated stainless steel wine rack (different orientations available)

ALTERNATIVE

- Available in remote or self-contained condensing unit
- Cylindrical lock, magnetic Lock or any customised Lock for door
- Floral pattern decorative glass in base section
- Different colors and finishes
- V-cut for all visible bends
- Choice of 1-, 25 3-or 4-sides glass
- Remote system for LED light
- Remote system for light intensity
- 110V/60Hz

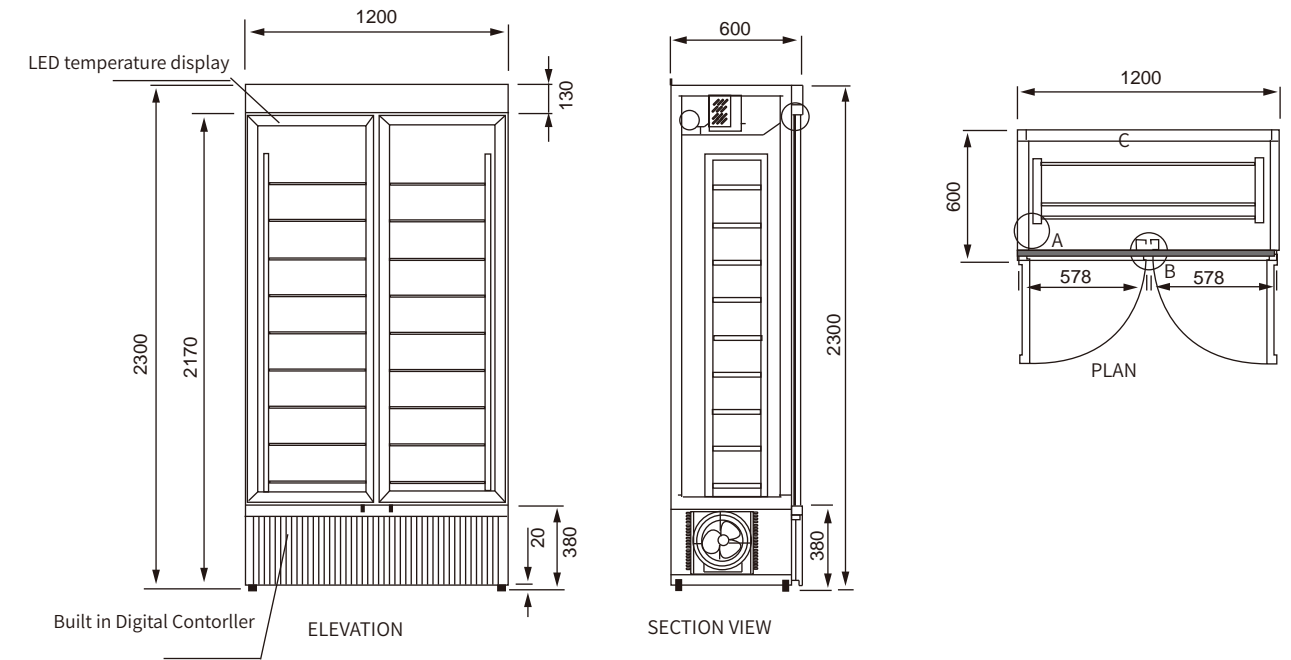

Model	Dimension (mm)	Title	System	Temp C	Voltage	Ref.	Volume
ALPS-WE1GD	600*600*2300	1 door wine cellar	Air-cooled	+12~+18°C	220V/50Hz	R134a	45Bottles
ALPS-WE2GD	1200*600*2300	2 door wine cellar	Air-cooled	+12~+18°C	220V/50Hz	R134a	117Bottles
ALPS-WE3GD	1800*600*2300	3 door wine cellar	Air-cooled	+12~+18°C	220V/50Hz	R134a	171Bottles

RIPENING

AGED BEEF

Aged beef, the choice of mature western restaurants

Delicate meat 01

During the aging process, protease slowly decomposes the fiber in the beef, the meat gradually softens, and the tenderness of the beef is improved.

Juicy 02

The mature beef juice is concentrated, so the beef is sweet and juicy, and it melts in the mouth.

Full-bodied flavor 03

The dry-aged beef has the fresh aroma of mushrooms, the sweetness of milk, and the rich aroma of cheese.

Crispy 04

Bar-aged beef is easier to color, and produces a crispy outer skin, achieving a crispy outside and tender inside.



RIPENING

BEEF AGING TECHNOLOGY

Beef with more flavor and better texture

Accurate and stable temperature control system

Beef maturation needs to be under constant temperature (-1.5°C-4°C is a suitable temperature), humidity (60%-85%) and ventilation conditions, and slowly improve the quality of beef over time. The constant electronic temperature control of the beef aging cabinet is -5~10°C adjustable temperature control range, and can be kept at a certain temperature within 1°C error.



Independent Humidity Control

Constant internal humidity, the humidity is between 80% and 85%, and there is a water level observation terminal at the front, so it is clear at a glance whether to add water.

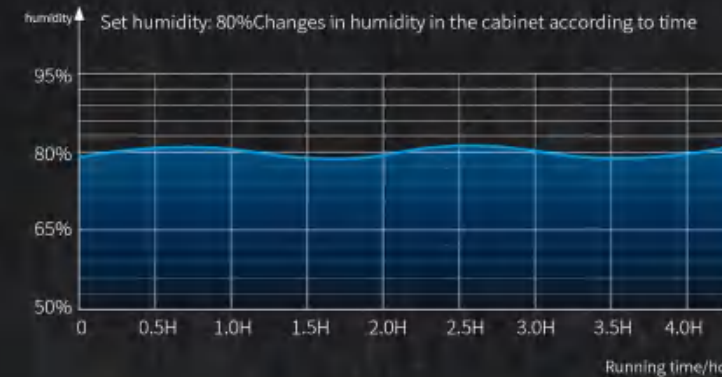

BEEF AGING CABINET HOST A GOOD BEEF AGING JOURNEY

The color of the surface layer of Aged beef gradually becomes dull

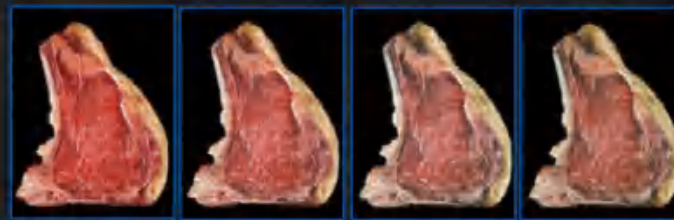

Aging for 7 days Aging for 14 days Aging for 21 days Aging for 30 days

Short-wave UVC powerful sterilization

Professional UVC sterilizing effect, with fully automatic working state, automatically start the sterilization for one hour every day, when the cabinet door is opened, this function will be turned off, to avoid human skin from radiation, protect personal safety, and automatically start the sterilization when the cabinet door is closed without manual operation.

Ultraviolet rays with a spectral wavelength of 254nm belong to short-wave UVC sterilizing ultraviolet rays, which are easily absorbed by the DNA of organisms and are a good choice for disinfection and sterilization.

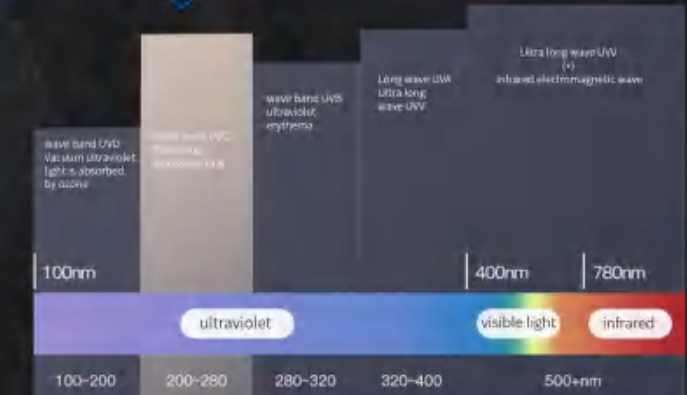
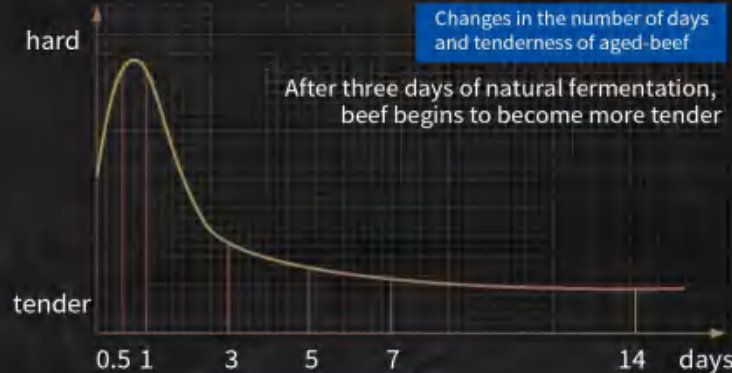

WET AGING BEEF DISPLAY



Optional custom content

According to different individual needs, choose from different styles of wine cabinets

This style can be customized:

Constant temperature wine cabinet, fruit and vegetable cabinet, roast meat air drying cabinet, Thawing cabinets, frozen product display cabinets, etc.

Work environment

- ① Temperature 32°C Humidity 65%
- ② Bottom-mounted refrigeration system design, extremely convenient for installation and maintenance
- ③ 60mm thick high-density environmental protection heat insulation layer, saving energy and electricity
- ④ Environmentally friendly fluorine-free refrigerant R134a
- ⑤ Mirror surface/black titanium/stainless steel plate can be selected for inner and outer cabinets
- ⑥ High-efficiency and energy-saving imported compressor
- ⑦ Intelligent digital temperature controller with humidity display
- ⑧ 4D uniform cooling technology, back-type air-out hollow electric heating defogging glass door
- ⑨ Intelligent defrosting system
- ⑩ Up and down adjustable shelf design, automatic drainage and evaporation system
- ⑪ Inner box rounded corners and sunken floor design, easy to clean
- ⑫ Automatic return door body design

Model	Dimension (mm)	Name	Temperature	volume	power	Ref.	System
ALPS07C1	700*760*2100	Wet Aging Beef Display	5°C~-5°C	503L	1050	R404a	Air-cooled
ALPS07D1	700*760*2100	Wet Aging Beef Display	-12°C~-18°C	503L	1200	R404a	Air-cooled
ALPS12C2	1200*760*2100	Wet Aging Beef Display	5°C~-5°C	980L	1680	R404a	Air-cooled
ALPS12D2	1200*760*2100	Wet Aging Beef Display	-12°C~-18°C	980L	1800	R404a	Air-cooled
ALPS15C2	1500*760*2100	Wet Aging Beef Display	5°C~-5°C	1280L	2080	R404a	Air-cooled
ALPS15D2	1500*760*2100	Wet Aging Beef Display	-12°C~-18°C	1280L	2205	R404a	Air-cooled
ALPS18C3	1800*760*2100	Wet Aging Beef Display	5°C~-5°C	1530L	2270	R404a	Air-cooled
ALPS18D3	1800*760*2100	Wet Aging Beef Display	-12°C~-18°C	1530L	2395	R404a	Air-cooled

DRY AGING BEEF DISPLAY



- ① Air-cooled frost-free system special air duct design makes the temperature and humidity inside the cabinet more uniform and stable
- ② Food grade 304 stainless steel is used inside and outside the cabinet
- ③ Integrated blister liner, waterproof, environmentally friendly, antibacterial, more suitable for maturation environments with high humidity and salt
- ④ Precise temperature and humidity control system, temperature: +1/+4°C, humidity: 60%6-90%, best environment for aged beef
- ⑤ Automatic humidity control system, no external water source required
- ⑥ UVC sterilization system, sterilizes the air in the cabinet without any dead spots Highly transparent tempered glass door
- ⑦ Highly transparent tempered glass door
- ⑧ Embraco compressor, long life, low noise
- ⑨ Activated carbon air filtration has strong adsorption power and effectively removes harmful gases in the air.
- ⑩ Himalayan salt bricks effectively improve the air quality in the cabinet and make beef more flavorful
- ⑪ LED waterproof lamp, less heat, does not affect the temperature of the beef

Model	Dimension (mm)	Temperature	System	volume	power	Ref.
ALPS-S100	700*825*1650	1°C~4°C	Air-cooled	400L	160W	R134a

ICE CREAM DISPLAY

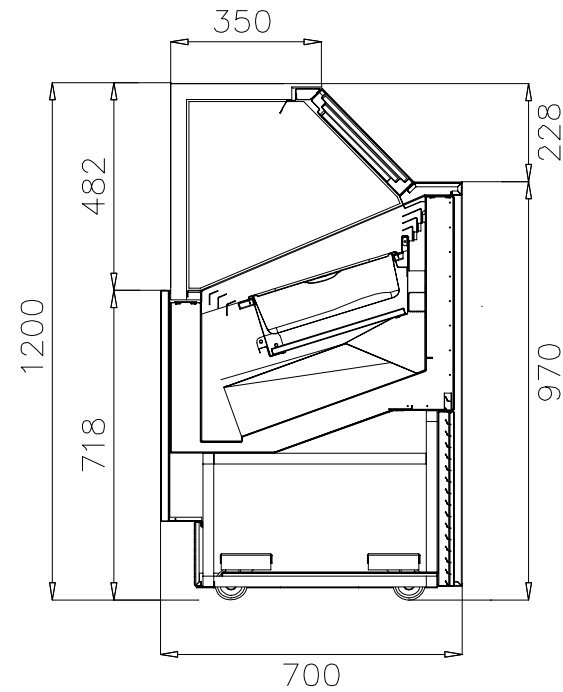

-18°C ~ -22°C

R-404A

NATURAL PERMEABILITY

Highly transparent glass, which brings out the best of food.

ICE CREAM DISPLAY

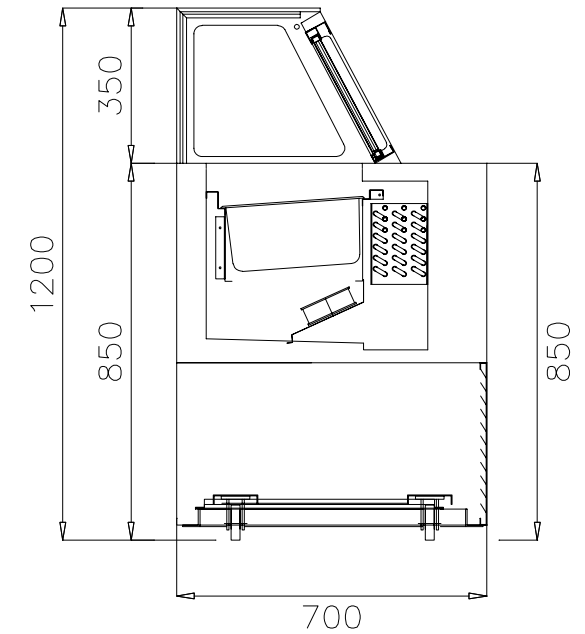

-18°C ~ -22°C

R-404A

SMOOTH AND DELICATE
Fresh food advantages can be fully reflected just by displayed in a simple way.

Model	Dimension (mm)	Title	System	Temp C	Ref.	Voltage	Capacity
IV-B5	1080*700*1200	Ice cream showcase with 5 pans	Air-cooled	-22°C-18°C	R404a	220V/50Hz	148L
IV-B6	1250*700*1200	Ice cream showcase with 6 pans	Air-cooled	-22°C-18°C	R404a	220V/50Hz	165L
IV-B7	1420*700*1200	Ice cream showcase with 7 pans	Air-cooled	-22°C-18°C	R404a	220V/50Hz	182L
IV-B8	1590*700*1200	Ice cream showcase with 8 pans	Air-cooled	-22°C-18°C	R404a	220V/50Hz	199L
IV-B9	1760*700*1200	Ice cream showcase with 9 pans	Air-cooled	-22°C-18°C	R404a	220V/50Hz	216L

Model	Dimension (mm)	Title	System	Temp C	Voltage	Ref.	Capacity
IB-B4	850*700*1200	Ice cream showcase with 4 pans	Air-cooled	-18°C~-22°C	220V/50Hz	R404a	90L
IB-B5	1000*700*1200	Ice cream showcase with 5 pans	Air-cooled	-18°C~-22°C	220V/50Hz	R404a	110L
IB-B6	1200*700*1200	Ice cream showcase with 5 pans	Air-cooled	-18°C~-22°C	220V/50Hz	R404a	130L
IB-B7	1400*700*1200	Ice cream showcase with 5 pans	Air-cooled	-18°C~-22°C	220V/50Hz	R404a	150L

CAKE DISPLAY

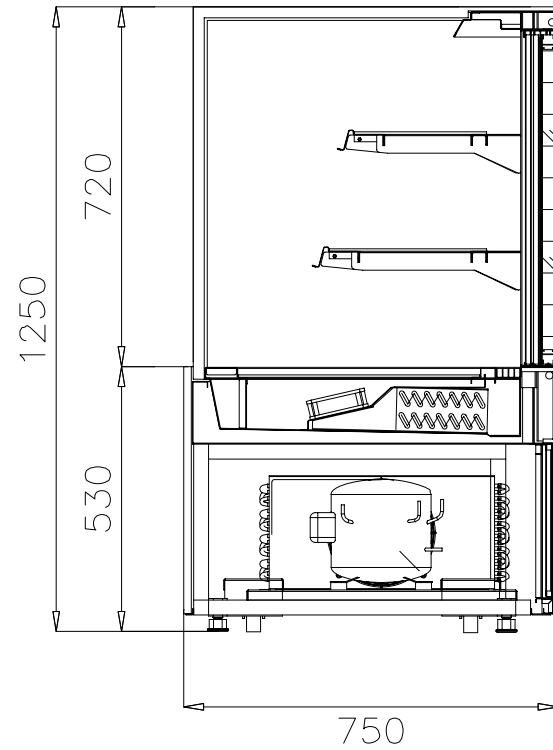

2°C~8°C

R-404A

PURE COPPER TUBE DESIGN

Much better cooling and moisturizing effect, much longer usage life, keep food fresh in long time.

CAKE DISPLAY

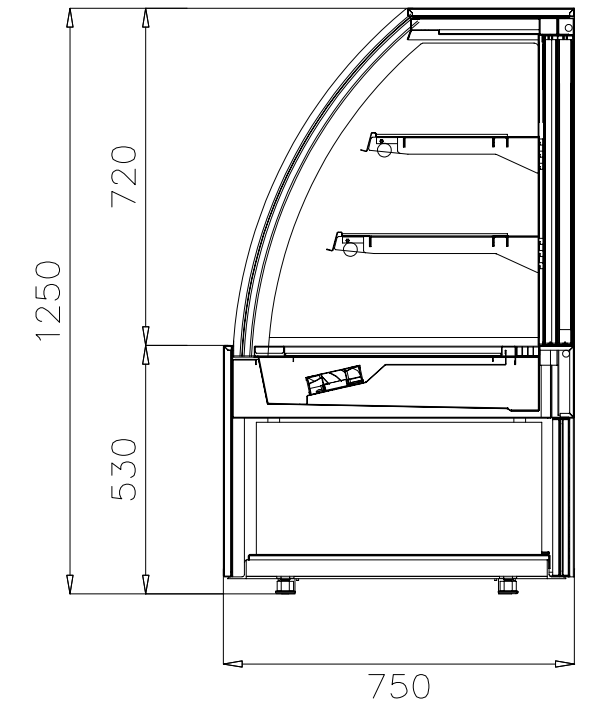

2°C~8°C

R-404A

PURE COPPER BEARING FAN

Use all copper bearing fan, corrosion resistance, longer usage life and better mute effect.

Model	Dimension (mm)	Title	System	Temp C	Voltage	Ref.	Capacity
QS730V-M/S	900*660*1220	Three-layer cake showcase	Air-cooled	2°C~8°C	220V/600W	R134a/ R404a	305L
QS740V-M/S	1200*660*1220	Three-layer cake showcase	Air-cooled	2°C~8°C	220V/730W	R134a/ R404a	405L
QS750V-M/S	1500*660*1220	Three-layer cake showcase	Air-cooled	2°C~8°C	220V/850W	R134a/ R404a	505L
QS760V-M/S	1800*660*1220	Three-layer cake showcase	Air-cooled	2°C~8°C	220V/980W	R134a/ R404a	605L

Model	Dimension (mm)	Title	System	Temp C	Voltage	Ref.	Capacity
SD730A-M/S	900*690*1220	Three-layer curved glass cakeshowcase	Air-cooled	2°C~8°C	220V/580W	R134a/ R404a	270L
SD740A-M/S	1200*690*1220	Three-layer curved glass cakeshowcase	Air-cooled	2°C~8°C	220V/700W	R134a/ R404a	350L
SD750A-M/S	1500*690*1220	Three-layer curved glass cakeshowcase	Air-cooled	2°C~8°C	220V/860W	R134a/ R404a	430L
SD760A-M/S	1800*690*1220	Three-layer curved glass cakeshowcase	Air-cooled	2°C~8°C	220V/980W	R134a/ R404a	510L

FOUR-LAYER CAKE SHOWCASE

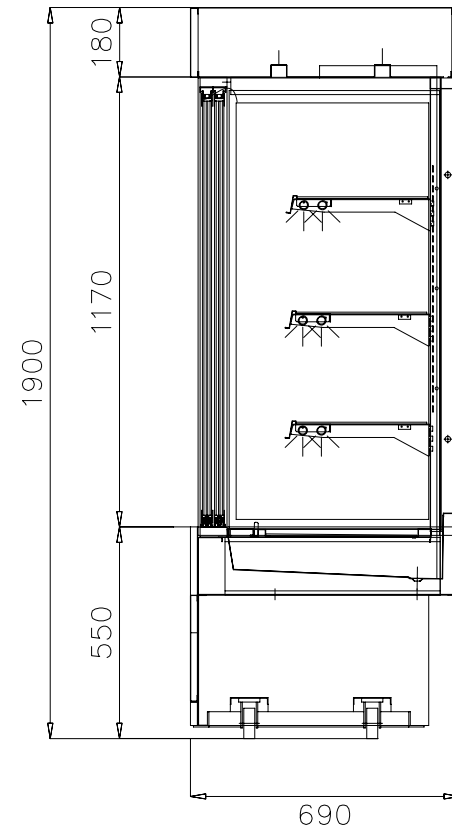

2°C~8°C

R134A/R-404A

ELEGANT WHITE

Brand new fresh and elegant white, peaceful and elegant with its own healing color, adding a touch of soothing to beauty stores of urban.

COMBI SHOWCASE

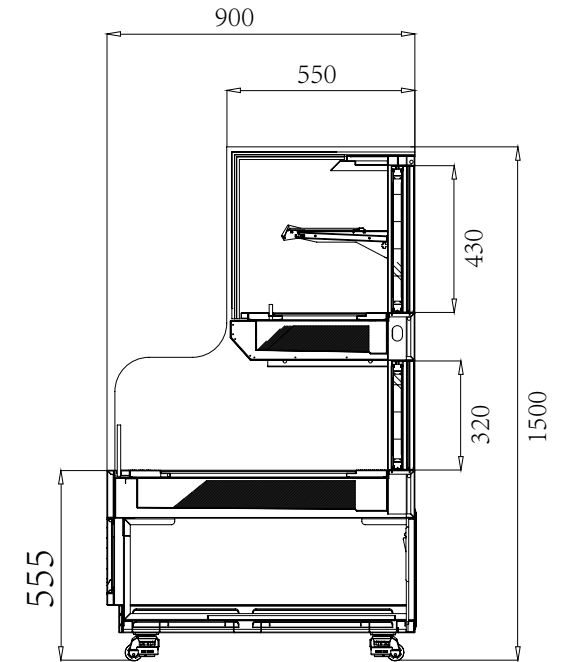

8°C~2°C / 10°C~5°C

R134A/R-404A

LARGE DISPLAY SPACE

Solve the trouble of having too many products that no place to place them, Three-layer storage space, there is no need to worry about insufficient space for new products. The high-definition glass window has a very good display effect, and customers can see things at a glance.

Model	Dimension (mm)	Title	System	Temp °C	Voltage	Ref.	Capacity
Q730VF-M/S	900*690*1900	Four-layer cake showcase	Air-cooled	2°C~8°C	220V/580W	R134a/R404a	490L
Q740VF-M/S	1200*690*1900	Four-layer cake showcase	Air-cooled	2°C~8°C	220V/700W	R134a/R404a	664L
Q750VF-M/S	1500*690*1900	Four-layer cake showcase	Air-cooled	2°C~8°C	220V/860W	R134a/R404a	808L
Q760VF-M/S	1800*690*1900	Four-layer cake showcase	Air-cooled	2°C~8°C	220V/980W	R134a/R404a	1010L
Q770VF-M/S	2100*690*1900	Four-layer cake showcase	Air-cooled	2°C~8°C	220V/860W	R134a/R404a	1183L
Q780VF-M/S	2400*690*1900	Four-layer cake showcase	Air-cooled	2°C~8°C	220V/980W	R134a/R404a	1357L

Model	Dimension (mm)	Title	System	Temp °C	Voltage	Ref.	Capacity
D-ZM940VN-S	1200*900*1500	Combi showcase	Air-cooled	2°C~8°C/ 5°C~10°C	220V/50Hz	R134a/R404a	230L+180L
D-ZM950VN-S	1500*900*1500	Combi showcase	Air-cooled	2°C~8°C/ 5°C~10°C	220V/50Hz	R134a/R404a	295L+230L
D-ZM960VN-S	1800*900*1500	Combi showcase	Air-cooled	2°C~8°C/ 5°C~10°C	220V/50Hz	R134a/R404a	350L+280L
D-ZM970VN-S	2100*900*1500	Combi showcase	Air-cooled	2°C~8°C/ 5°C~10°C	220V/50Hz	R134a/R404a	400L+300L
D-ZM980VN-S	2400*900*1500	Combi showcase	Air-cooled	2°C~8°C/ 5°C~10°C	220V/50Hz	R134a/R404a	450L+380L

CHOCOLATE DISPLAY CABINET (HUMIDITY CONTROL)

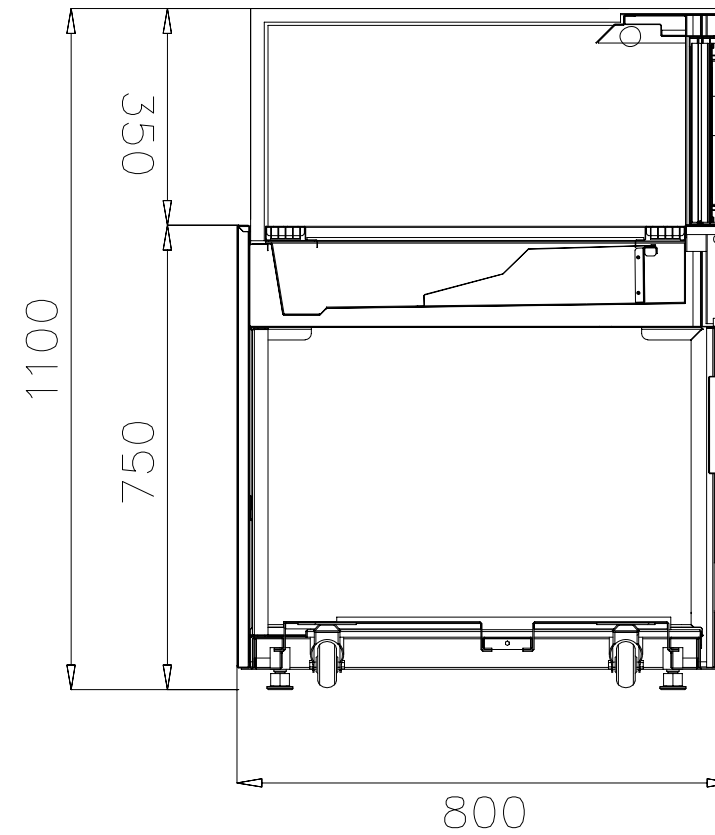

APPLICABLE TO ALL
KINDS SCENARIOS

Any food can be handled with ease

Model	Dimension (mm)	Title	Capacity(L)	Temp °C	Humidity	System	Ref.
ALPS-R830V-M/S	900x800x1100	Chocolate Display Cabinet	170	13°C~18°C	40%-55%	Air-cooled	R134a/ R-404A
ALPS-R840V-M/S	1200x800x1100	Chocolate Display Cabinet	230	13°C~18°C	40%-55%	Air-cooled	R134a/ R-404A
ALPS-R850V-M/S	1500x800x1100	Chocolate Display Cabinet	290	13°C~18°C	40%-55%	Air-cooled	R134a/ R-404A
ALPS-R860V-M/S	1800x800x1100	Chocolate Display Cabinet	360	13°C~18°C	40%-55%	Air-cooled	R134a/ R-404A
ALPS-R870V-M/S	2100x800x1100	Chocolate Display Cabinet	420	13°C~18°C	40%-55%	Air-cooled	R134a/ R-404A
ALPS-R880V-M/S	2400x800x1100	Chocolate Display Cabinet	480	13°C~18°C	40%-55%	Air-cooled	R134a/ R-404A

DUCK DRYING CABINET



Work environment

- ① Temperature 32°C Humidity 65%
- ② European integrated refrigeration system design, easy installation and maintenance
- ③ 60mm thick high-density environmental protection heat insulation layer, saving energy and electricity
- ④ Environmentally friendly fluorine-free refrigerant R134a
- ⑤ Inner and outer box 201# stainless steel plate
- ⑥ Up and down adjustable shelf design
- ⑦ High-efficiency energy-saving compressor, intelligent digital temperature controller and high-speed low-noise fan
- ⑧ Intelligent defrosting automatic evaporation system
- ⑨ LED lighting and light box that can be switched on and off at any time
- ⑩ Automatic return glass door, luxury 2-layer hollow glass door
- ⑪ Removable and easy-to-clean sealing strip

Model	Dimension (mm)	Temperature	System	volume	power	Climate type	Ref.
ALPS-700	700*800*2080	+5°C~+10°C	Air-cooled	550L	682	N	R290(R134a/R404aoptional)
ALPS-1200	1200*800*2080	+5°C~+10°C	Air-cooled	1050L	860	N	R290(R134a/R404aoptional)
ALPS-1800	1800*800*2080	+5°C~+10°C	Air-cooled	1600	1255	N	R290(R134a/R404aoptional)

DUCK DRYING CABINET



Work environment

- ① Temperature 32°C Humidity 65%
- ② European integrated refrigeration system design, easy installation and maintenance
- ③ 60mm thick high-density environmental protection heat insulation layer, saving energy and electricity
- ④ Environmentally friendly fluorine-free refrigerant R134a
- ⑤ 201# stainless steel plate inside and outside the box
- ⑥ Up and down adjustable shelf design
- ⑦ Intelligent defrosting automatic evaporation system
- ⑧ LED lighting and light boxes that can be switched on and off at any time
- ⑨ Automatic return glass door, luxury 2-layer hollow glass door
- ⑩ Removable and easy-to-clean sealing strip
- ⑪ High-efficiency energy-saving compressor, intelligent digital temperature controller and high-speed low-noise fan

Model	Dimension (mm)	Temperature	System	volume	power	Climate type	Number of disks	Number of hanging rods	Ref.
ALPS-LP680	700*800*2300	+2~+8	Air-cooled	700	400	N(32)	1	6	R134a
ALPS-LP1400	1400*800*2300	+2~+8	Air-cooled	1200	980	N(32)	2	6	R134a
ALPS-LP2100	2100*800*2300	+2~+8	Air-cooled	1200	980	N(32)	3	6	R134a

COLD ROOM SERIES



Stainless steel cold room



Rear supplement cold storage



Color steel plate cold room



Blast freezing room



Frequency conversion unit



EVI unit



Air-cooled open type unit



Air-cooled box unit

