

## Saddleworth and the Peak District

The Boarshurst Centre is located in Greenfield, one of the villages which make up the area known as Saddleworth. Situated in the north of the Peak District NP, the centre makes an ideal base for exploring the gritstone edges of Chew Valley and the local moorland. There are low-level walking routes in the valleys and alongside canals and reservoirs.



The traditional villages of the locality have great historical interest. Alternatively Manchester, with its wide variety of attractions, can be reached by a 20-minute train journey from Greenfield station.

Greenfield has several public houses and cafes, a large supermarket and several smaller shops including a newsagent/post office and a pharmacy.

## Saddleworth Outdoor

### Pursuits Association

(Registered charity no. 702185)

Saddleworth Outdoor Pursuits Association (SOPA) was formed in 1969 to provide accommodation for organised groups. The Boarshurst Centre is available to hire by groups of all ages undertaking outdoor pursuits or educational activities. One of the major aims of SOPA is to promote camaraderie and responsibility through shared experiences and adventure.



## The Boarshurst Centre

The centre is a traditional stone single-storey building which was originally the village school. It provides warm, clean, well-maintained accommodation and is comparable to a Youth Hostel but with the advantage of being for the exclusive use of the visiting group. The centre is accessible to disabled visitors but, due to fire regulations, wheelchair users are not allowed to stay overnight.

### Building Layout

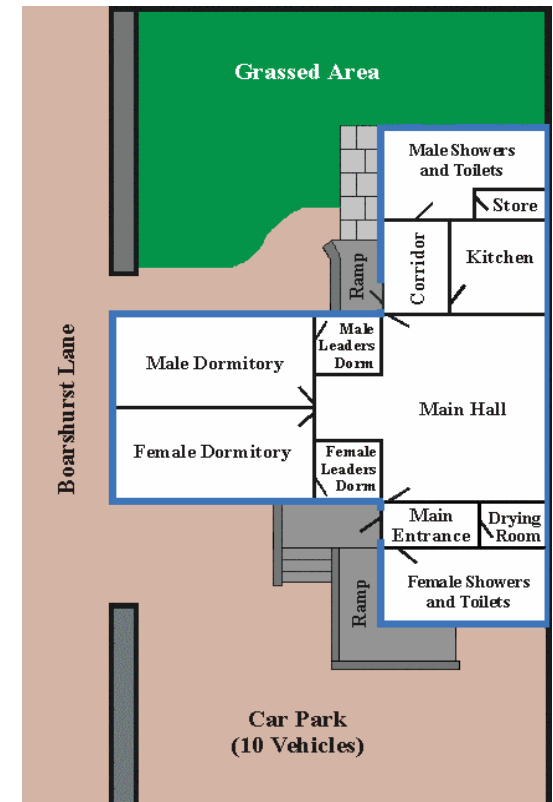

## Location

### Accommodation

- 2 separate dormitories (bunkhouse style) each sleeping 12 people.
- 2 attached leaders' dormitories each for 4 people.
- Pillows, pillowcases and base sheets provided.
- Male and female toilets and showers with disabled access are situated at opposite ends of the building.
- Large capacity washer and dryer.
- Large fully-equipped kitchen.
- Large dining/recreation area.
- Drying room/boot room.
- Wheelchair accessible at the front and rear entrances.
- Car park.
- Grassed recreation area/garden.

For current prices and to make bookings please see our website:

[www.boarshurstcentre.org](http://www.boarshurstcentre.org)

Email: [theboarshurstcentre@gmail.com](mailto:theboarshurstcentre@gmail.com)

Mob. 07979864472



Grid ref: SE002045

OS Outdoor Leisure 1 (1:25,000)  
The Peak District – Dark Peak area

Landranger maps (1:50,000)

109 Manchester  
110 Sheffield & Huddersfield

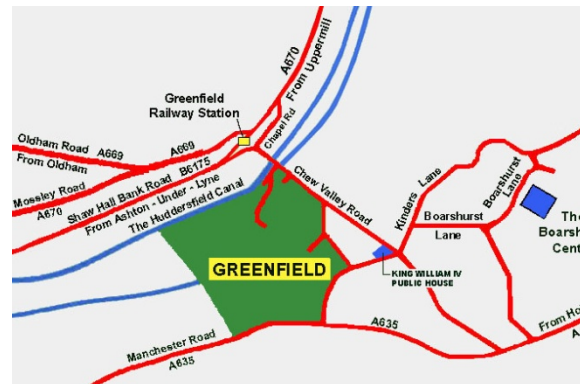

[www.boarshurstcentre.org](http://www.boarshurstcentre.org)

Self-catering accommodation  
for up to 32 people

Greenfield  
Saddleworth  
Oldham  
OL3 7EA

Contact:  
[theboarshurstcentre@gmail.com](mailto:theboarshurstcentre@gmail.com)