

2-Way Power Divider - 0°

Model PD180400A2S

Specifications.

Frequency Range	18~40GHz	Finish	Epoxy Paint
Insertion Loss	≤1.5dB (Above 3dB Split)	Connector Body	Passivated Stainless Steel
VSWR	Input ≤1.60:1 Output ≤1.60:1	Housing	Aluminum, 6061 T6 Clear Chem Conversion Film
Isolation	≥18dB	Connector Pin	2.92-Female
Amplitude Balance	≤±0.3dB	Solder	Lead Free, RoHS Compliant
Phase Balance	≤±4.0°	Operating Temperature	-35°C~+105°C
¹Power Handling	Forward ≤20 Watt; Reversed ≤3 K Watt	Operating Humidity	Up to 95%,Non- Condensing
Impedance	50Ω	Weight	100g
Port Connectors	2.92-Female		

¹Power Handling guaranteed when load's VSWR within 1.60:1.

Mechanical Outline.

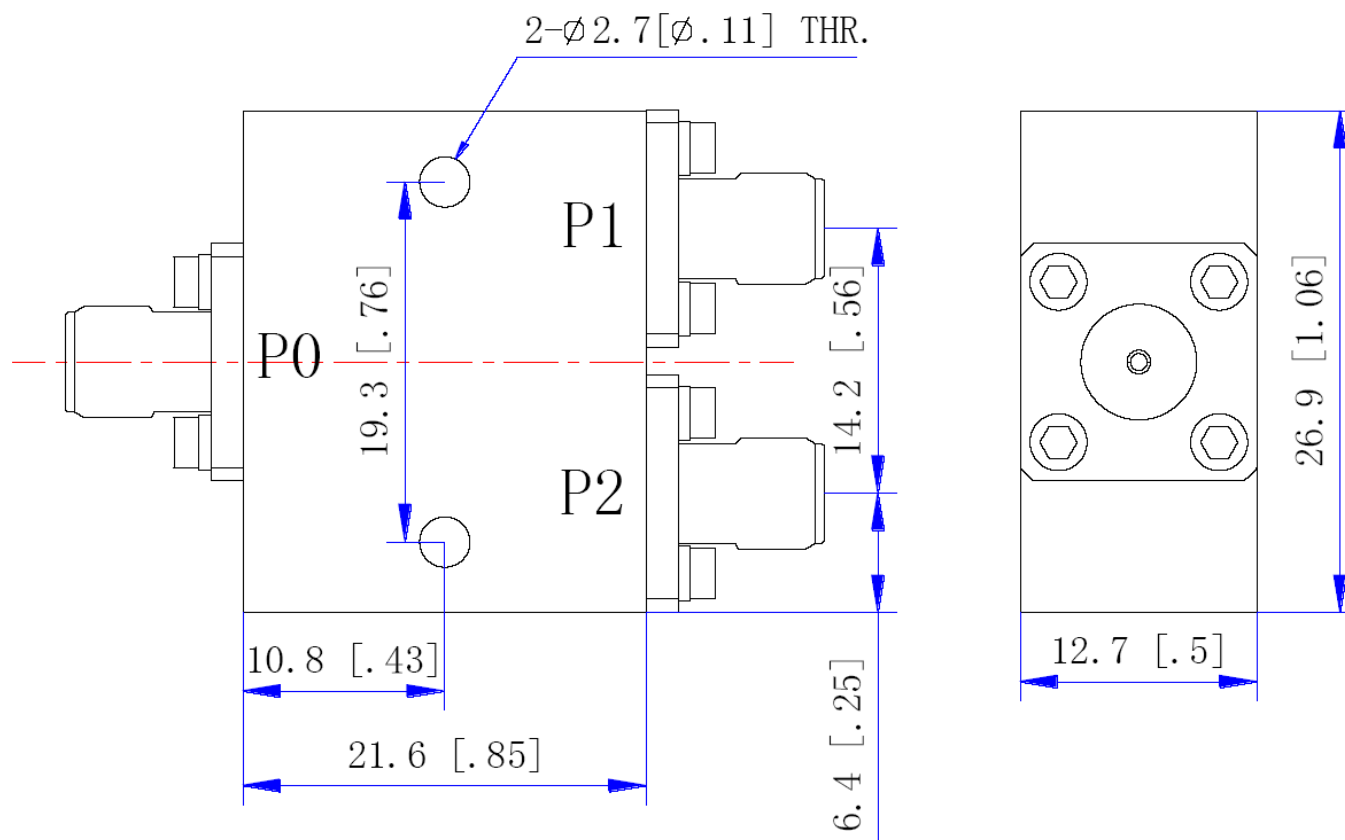

*Units in m'm

Tolerance: ± 0.2 mm

Test performance:

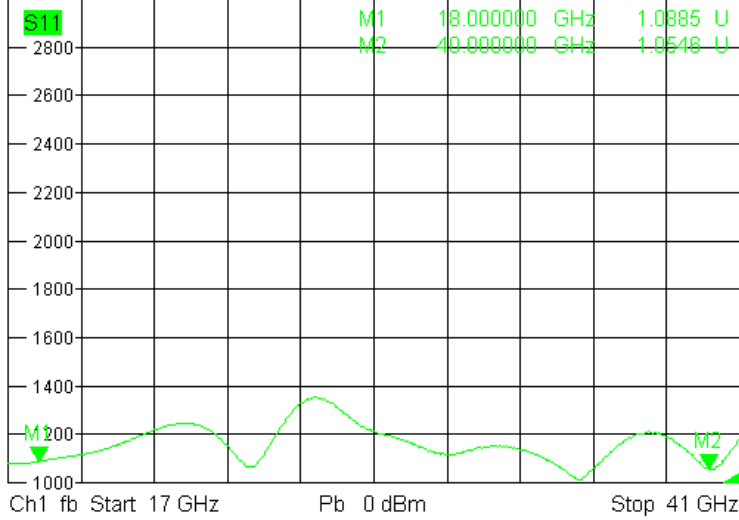
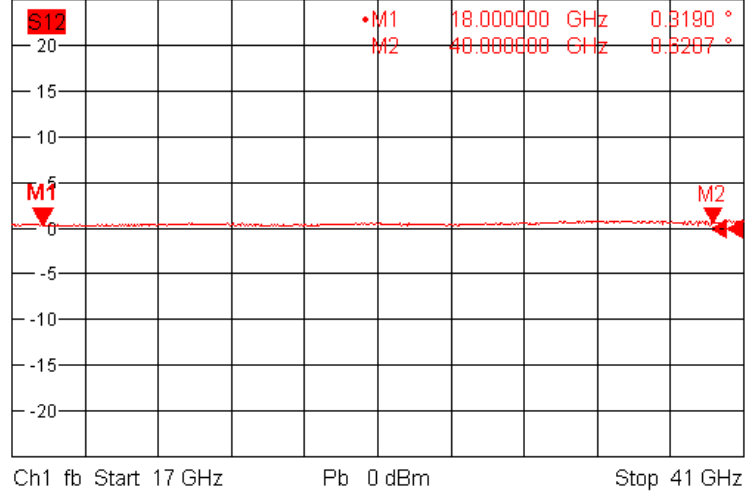
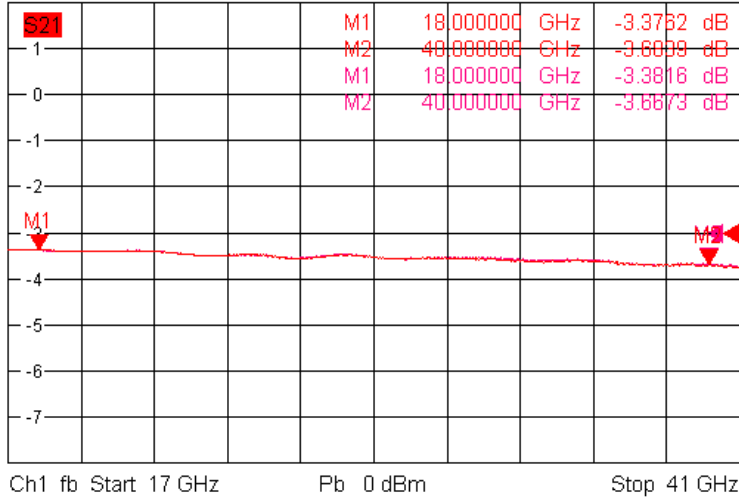
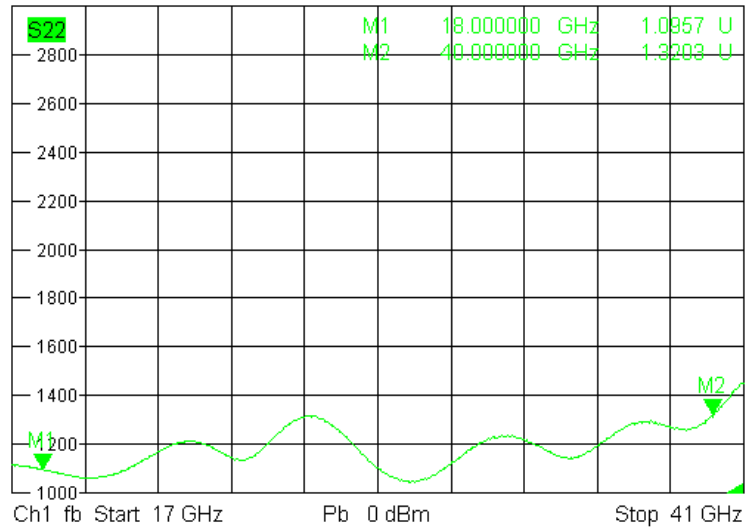
 Trc1 **S11** SWR 200 mU/ Ref 1 U Cal 1

 Trc2 **S12** Phase 5° / Ref 0° Cal Math 2
 Mem5[Trc2] **S12** Phase 5° / Ref 0° Invisible

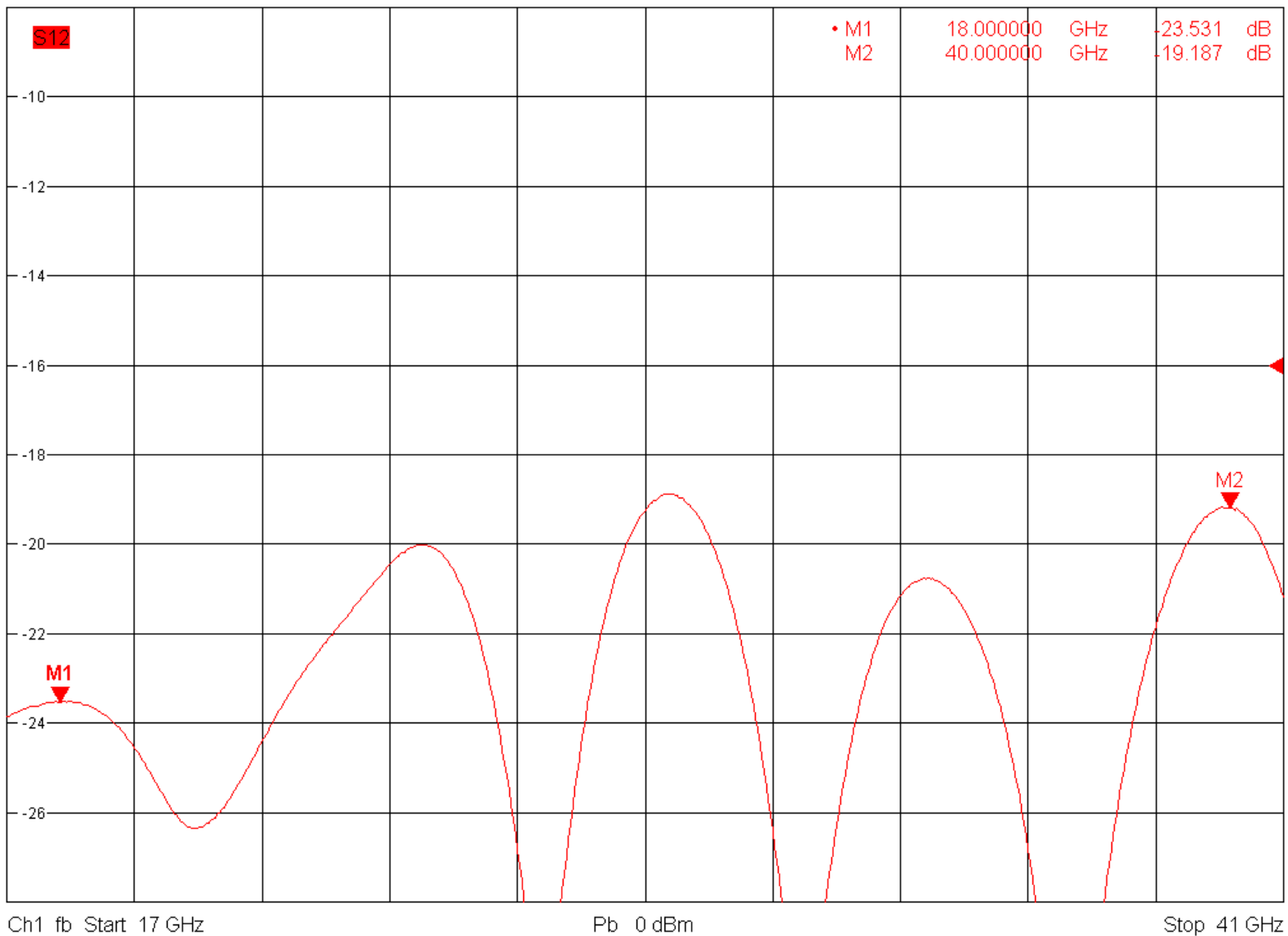
 Trc3 **S21** dB Mag 1 dB / Ref -3 dB Cal 3
 Mem6[Trc3] **S21** dB Mag 1 dB / Ref -3 dB

 Trc4 **S22** SWR 200 mU/ Ref 1 U Cal 4

3/9/2019, 9:52 AM

 Trc2 **S12** dB Mag 2 dB / Ref -16 dB Cal 2 (Max)

3/9/2019, 9:54 AM