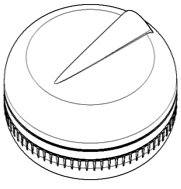
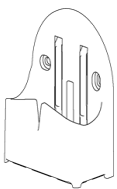
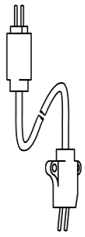
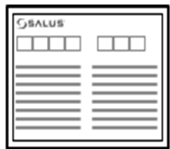
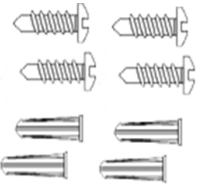
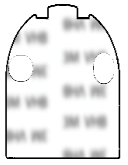
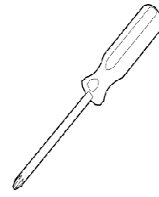

In the Box

					
Water Leak Sensor w/ Battery (1x CR2, 3V Lithium)	Stand	Sensor Cable	Installation/ Quick-start Guide	Screws and Anchors	Adhesive Pad

Tools Needed

#1 Phillips Screwdriver

Note:

Additional equipment may be required due to building construction or materials, or other radio interference that may reduce the radio range.



PAIRING INSTRUCTIONS

- Follow your System's App instructions to prepare to add devices to the App's Platform.
- Remove the Face Plate from the sensor by turning the Face Plate counter-clockwise and pull the battery tab to start the pairing process.
- When the sensor is detected and added to the system, replace the Face Plate by aligning the dots and turning the Face Plate clockwise.
- **Make sure the dots are fully aligned for a proper seal, then proceed to the sensor installation.**

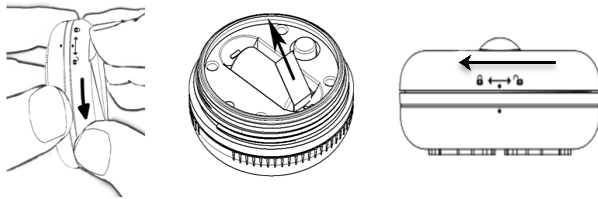

INSTALLATION INSTRUCTIONS

- Identify a level surface for the sensor, where water will likely accumulate in the event of a leak. If the sensor is too wide for placement at the desired location, the stand can be used for a narrower profile.

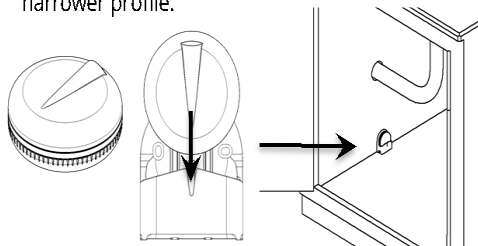

For tighter locations or locations with radio problems, use the included Sensor Cable.

INSTALLING THE SENSOR CABLE (OPTIONAL)

- To install the Sensor Cable, first run the cable to the desired location, and fasten the winged end of the Sensor Cable into place. Note that the tips are angled to improve the sensing ability when the tips are near a surface.

Surface Install

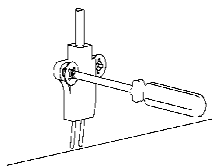

Sump Install

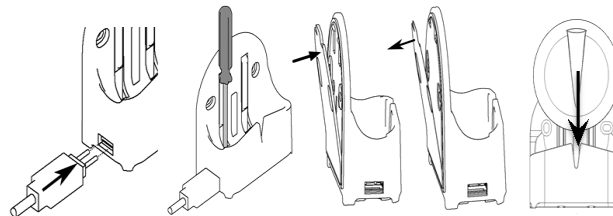
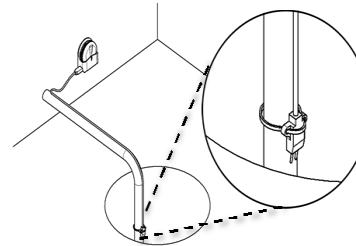

- Insert the square end of the Sensor Cable into the terminals on the stand.
- Screw down both terminals until the cable is firmly held in place
- Mount the Stand to the wall or other surface using the supplied double-sided adhesive pad or screws.
- Insert the Water Leak Sensor into the stand to begin operation.

TESTING THE SENSOR

- To test the sensor, remove it from the stand or floor
- Insert the sensor into the stand 90 degrees from upright in either direction to short the contacts on the sensor.
- The sensor will send a message to the connected home system indicating a water leak. The LED will not light up to preserve battery life.

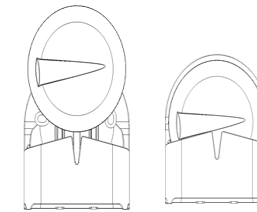

REPLACING THE BATTERY

- Grasp the top of the sensor Face Plate, rotate counter-clockwise and lift from the sensor Body.
- Grasp the battery from both ends and lift to remove the battery from the sensor.
- Insert a new battery into the sensor, observing the proper polarity.
- **Position the sensor Face Plate over the Sensor Body, aligning the dots on the Face Plate and Body, then rotate clockwise to align the dots again to close.**

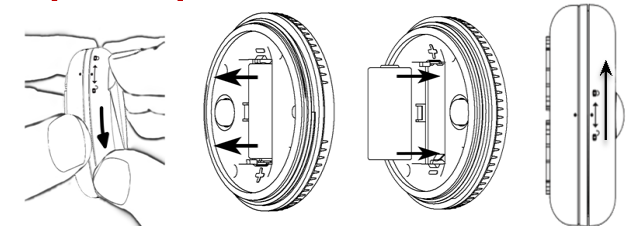

FACTORY RESETTING THE SENSOR

- Remove the sensor Face Plate.
- Remove the battery.
- Press and hold the Tamper Switch while re-inserting the battery.
- Release the Tamper Switch when the LED lights on the front of the sensor. The sensor is reset to factory defaults and will respond to pairing requests.
- After pairing, replace the Face Plate, **making sure the dots are fully aligned for a proper seal.**
- Position the Water Leak Sensor where desired.

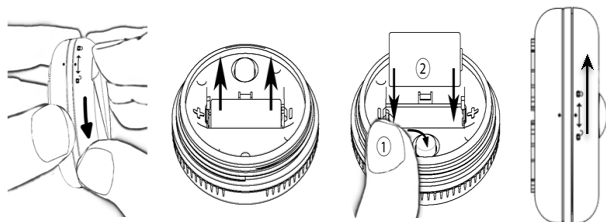

LED INDICATIONS

Solid at power up: Initializing, checking for Factory Reset

3 red flashes then pause: Searching for network to join

SPECIFICATIONS

Operating Conditions	32-104°F / 0-40°C 20-90% humidity (non-condensing)
Storage	-4-185 °F / -20-85°C 20-95% humidity (non-condensing)
Protocols Supported	ZigBee HA 3.0
RF Freq.	2.4 GHz
Battery	3V Lithium CR2
IP rating	IP 57
Size	<i>Sensor:</i> Ø 2.17" x 0.98" / Ø 55.0 mm x 24.9 mm <i>Stand:</i> 2.31" x 2.59" x 1.18" / 58.8 mm x 65.9 mm x 30.0 mm <i>Sensor Cable Length:</i> 78" / 2 m

FCC STATEMENTS

WARNING: Changes or modifications to this unit not expressly approved by the party responsible for compliance could void the user's authority to operate the equipment.

This device complies with Part 15 of the FCC Rules. Operation is subject to the following two conditions: (1) this device may not cause harmful interference, and (2) this device must accept any interference received, including interference that may cause undesired operation.

NOTE: This equipment has been tested and found to comply with the limits for a Class B digital device, pursuant to Part 15 of the FCC Rules. These limits are designed to provide reasonable protection against harmful interference in a residential installation. This equipment generates, uses and can radiate radio frequency energy, and if not installed and used in accordance with the instructions, may cause harmful interference to radio communications. However, there is no guarantee that interference will not occur in a particular installation. If this equipment does cause harmful interference to radio or television reception, which can be determined by turning the equipment off and on, the user is encouraged to try to correct the interference by one or more of the following measures:

- Reorient or relocate the receiving antenna.
- Increase the separation between the equipment and receiver.
- Connect the equipment into an outlet on a circuit different from that to which the receiver is connected.
- Consult the dealer or an experienced radio/TV technician for help.

FCC AND INDUSTRY CANADA

RF Radiation Exposure statement: This equipment complies with FCC and Industry Canada RF radiation exposure limits set forth for an uncontrolled environment. This equipment should be installed and operated with a minimum distance of 20 centimeters between the antenna and all persons.

INDUSTRY CANADA

This device complies with Industry Canada licence-exempt RSS standard(s). Operation is subject to the following two conditions: (1) this device may not cause interference, and (2) this device must accept any interference, including interference that may cause undesired operation of the device.

Le présent appareil est conforme aux CNR d'Industrie Canada applicables aux appareils radio exempts de licence. L'exploitation est autorisée aux deux conditions suivantes : (1) l'appareil ne doit pas produire de brouillage, et (2) l'utilisateur de l'appareil doit accepter tout brouillage radioélectrique subi, même si le brouillage est susceptible d'en compromettre le fonctionnement.

WARRANTY INFORMATION:

WARRANTY REGISTRATION

FOR 2 YEARS FROM THE DATE OF INSTALLATION WHEN REGISTERED WITHIN 60 DAYS OF THE INSTALLATION DATE OR 26 MONTHS FROM THE ORIGINAL PURCHASED DATE (THIS WARRANTY EXCLUDES CONSUMABLES SUCH AS BATTERIES) WILL BE FREE FROM DEFECTS IN MATERIAL AND WORKMANSHIP UNDER NORMAL USE AND REGULAR SERVICE AND MAINTENANCE.

FOR WARRANTY ISSUES, PLEASE CONTACT THE HVAC PROFESSIONAL THAT INSTALLED THIS PRODUCT.

YOU CAN REGISTER YOUR PRODUCT BY SENDING THE WARRANTY REGISTRATION FORM BELOW EITHER BY MAIL OR ELECTRONICALLY.

EMAIL:

WARRANTYREGISTRATION@HABITAT.SUPPORT

MAIL:

**HABITAT TECHNOLOGIES WARRANTY REGISTRATION DEPT.
330 EAST 38TH STREET, SUITE 530
NEW YORK, NY 10016-0444**

Warranty Registration Form

Name _____

Address _____

City, State, Zip _____

EMAIL: _____

Model _____ Serial Number _____

Installed Date _____