

# F18

## Fingerprint Standalone Access Control

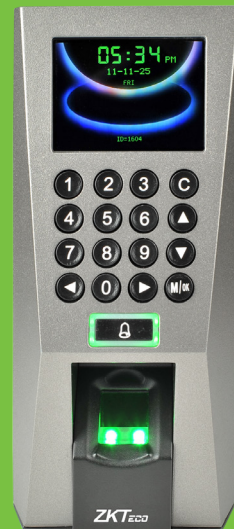

F18 is an innovative biometric fingerprint reader for access control application. Offering unparalleled performance by using an advanced algorithm for reliability, precision and excellent matching speed. The F18 features the fastest commercial-based fingerprint matching algorithm and ZK high-performance, high-image quality infrared detection fingerprint sensor. The device offers flexibility to be installed standalone or with any third party access control panels that support standard Wiegand signal. All the operations can be done on the TFT-LCD color screen. The fingerprint image will be displayed on it. That will guide user to put finger on proper position and increase recognition rate. TCP/IP and RS485 are available that the device can be used in different network.



### TFT Color Screen

- Audio-visual indication for acceptance and rejection of valid/invalid fingerprints
- More simple and convenient operation



### Slim and Elegant Design

- Streamlined and slim design for narrow spaces



### Fast and Accurate Fingerprint Algorithm

- 1 touch a-second user recognition
- Store 3,000 fingerprint templates, 30,000 cards and 100,000 transactions



### Easy Installation and Connectivity

- Wiegand input & output
- Network interface by TCP/IP or RS485



### Full Access Control Features

- Webserver
- Anti-passback
- Access control interface for 3rd party electric lock, door sensor, exit button, alarm and doorbell



### Easy Operation and Management

- Work with computer
- Buzzer, 4x4 keypads and doorbell
- Built-in serial and Ethernet ports
- Built-in USB port allows for manual data transfer

# Specifications

Fingerprint Capacity	3000 Templates
Transaction Capacity	30,000 Transactions
Sensor	ZK Optical Sensor
Algorithm Version	ZK Finger V9.0&10.0
Communication	RS232/485, TCP/IP, USB-host
Access Control Interface	3rd Party Electric Lock, Door Sensor, Exit Button, Alarm, Doorbell
Wiegand Signal	Input and Output
Display	TFT LCD Color Screen
Interface Styles	Common, Matrix and Magic styles
Standard Function	Webserver, Anti-passback
Optional Function	ID Card, Mifare Card
Power Supply	12V DC,3A
Operating Temperature	0 °C- 45 °C
Operating Humidity	20%-80%
Dimension(WxDxH)	80×183×42mm

## Optional Accessories



FR1200



RFID Reader



Exit Button



Electric Lock



Alarm



Sensor

## Configuration

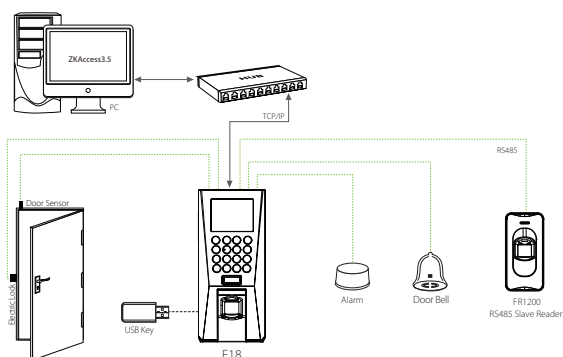

## Dimensions (mm)

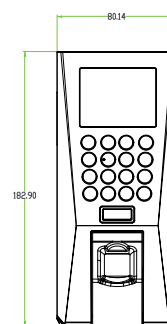
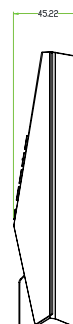

### ZKTeco Inc.

ZK Mansion, Wuhe Rd, Gangtuo, Bantian, Buji Town,  
Longgang District, Shenzhen China 518129  
Tel: 86-755-8960 2345/46/47/48  
E-mail: sales@zkteco.com  
www.zkteco.com

### Global Offices:

USA: + 1 732-412-6007  
EU: +34 916532891  
Brazil: +55 31 2515-8326  
Thailand: +66-027199154  
Mexico: +52-55-52928418

South Africa: +27 12 259 1047  
Egypt: +201110444134  
Dubai: +971 4 6091 310  
India: +91 8123536788  
Indonesia: +62 21 2921 8949

Vietnam : +84-0169-5813007  
Philippines: +63 9084118832  
Russia: +8 915 178-46-81