

# Xtratone Addressable Combined Sounder Beacon (MKII-AXTB/R & MKII-AXTB/W)

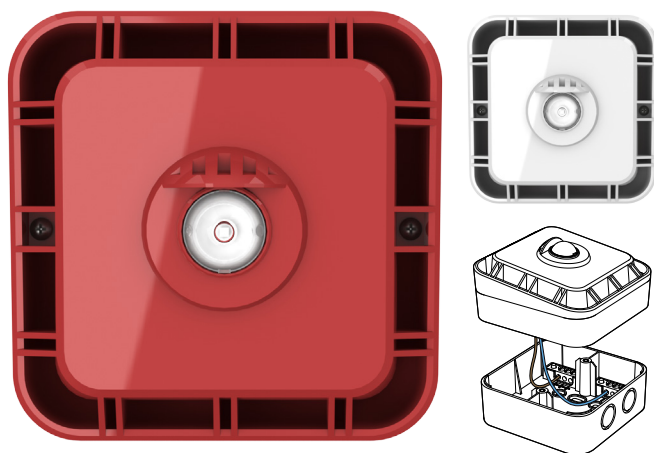

## Description

The new Xtratone addressable wall sounder with beacon has been designed to make an “electronics free” first fix and is available in red or white. The beacon has a coverage pattern of W-3.1-9.1 and the sounder part has 16 tones selectable at the control panel.

## Features

- 100dB @ 1m sound output
- 16 tones\*\* can be selected from control panel
- Flash rates between 0.33Hz and 1.5Hz
- Hard addressed via 8 way dip-switch OR
- Soft addressed via MKII Handheld Programmer
- Flush or surface fixing
- Housed in UL V0 flame retardant ABS
- 4 x 20mm cable entries (2 top, 2 bottom)
- First fix, wire to back box technology

## Dimensions & Weight

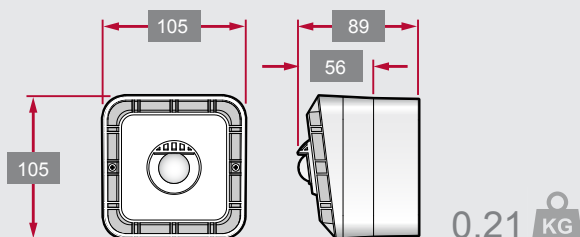

## Technical Specification

Model	MKII-AXTB/R	MKII-AXTB/W
Part Number	42-617	42-618
Operating Voltage	17 – 28V DC	
Quiescent Current	1.5mA	
Alarm Current	18 to 43mA	
Sound Output	*98.2dB	
Colour	Red body, Clear Flash	White body, Clear Flash
Minimum Continuous Operating Temperature	0°C	
Operating Temperature	-10°C To +55°C	
Max Humidity	95% Rh Non Condensing	
IP Rating	IP21C	
Size mm (with back box)	105x 105 x 56mm (105 X 105 X 89mm)	
Weight	210g	

\* This applies to TONE 0 in reverberant conditions.

\*\* Approved tones are Tone 0 and Tone 8.

## Coverage

