

INSTALLATION INSTRUCTIONS

Shower Arm

1 Technical Dimension

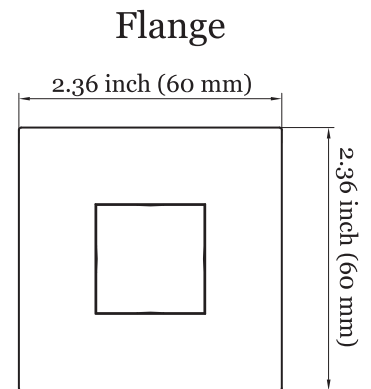
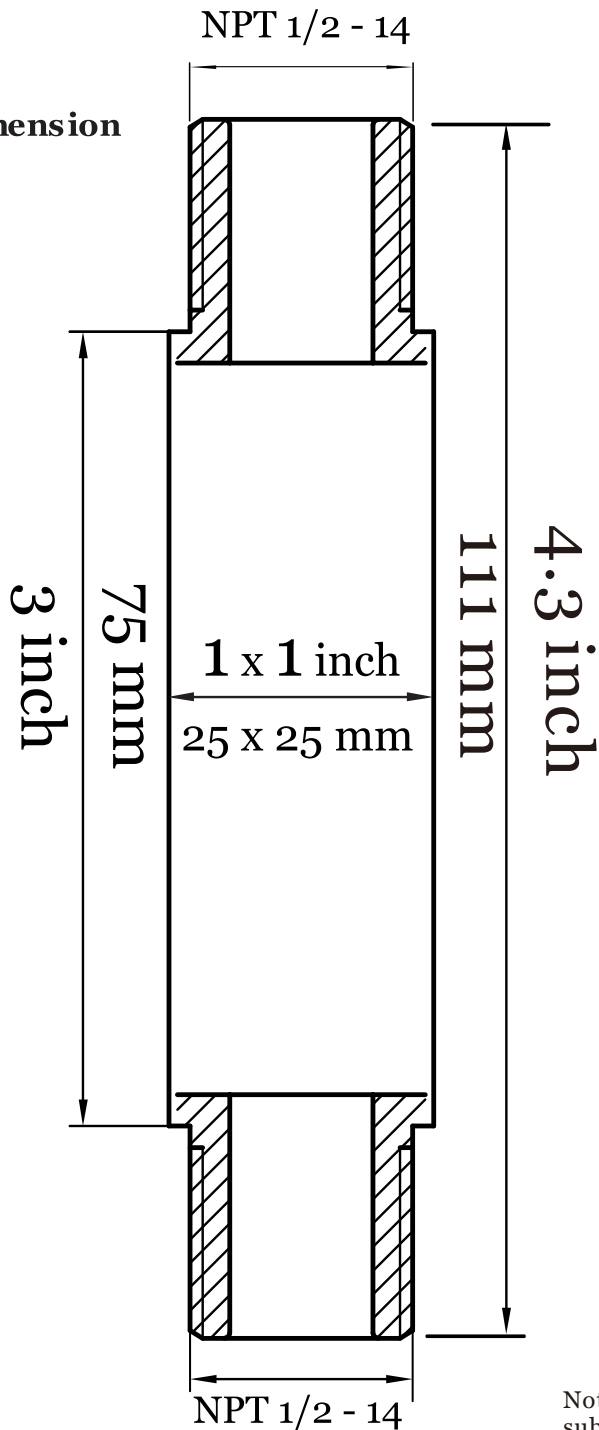

Note: These dimensions and specifications are subject to change without notice.

Approximate measurements for comparison only.

2 INSTALL SHOWER ARM WITH FLANGE

Note: Apply sealant or Teflon Tape to shower arm thread.

- Shut off the water supplies to the fitting.
- Install SHOWER ESCUTCHEON / flange onto SHOWER ARM.
- Apply sealant or Teflon tape to threads on both ends of SHOWER ARM.
- Thread SHOWER ARM into shower elbow.

Important: Do not overtighten shower arm much.

*** Inspect packing box before disposing as the Escutcheon / flange may get stuck at either ends. ***

