

KPG series



KPG01-20

Features

- Increased efficiency design with piston at the bottom
- Sensor is applicable with embedded neodymium magnet on the piston
- Improved hardness and lubrication with no magnet on the guide rack
- With pin hole for body and jaw positioning

How to order

KPG01 - 20 K + A93 x 2

① ② ③ ④ ⑤

① Series

KPG01	Compact type parallel gripper
-------	-------------------------------

③ Cover type

Nil	Standard (Without dust cover)
K	With dust cover

② Bore size

16	Ø16
20	Ø20
25	Ø25

⑤ Quantity of sensor parts

#	Quantity of sensor
---	--------------------

④ Auto switch

Reed A/S	Model	Solid state A/S	Model	Notes
A93(V)	D-A93(V)K	F-9□(V)	D-F9□(V)K	□ = N, P, B
A93N	D-A93KN	F-9□(V)	D-F9□(V)K	
A93(V)S	D-A93(V)K-S	F-9□(V)	D-F9□(V)K	
Z72K	D-72K	Y59A	D-Y59AK	
Z73K	D-Z73K	Y7P	D-Y7PK	
Z82K	D-Z82K	Y59B	D-Y59BK	

※ Refer to Auto Switch Catalogue for more information.

Specifications

		KPG01-16	KPG01-20	KPG01-25
Fluid		Compressed air		
Operating Pressure		1~7kgf/cm ² (0.1~0.7MPa)		
Ambient Temperature		0~60℃		
Stroke(mm)		2x4	2x6	2x8
Port size		M5		
Air consumption(CC/Cycle)		1.2	2.8	6.0
Max. gripping point(mm)		32	40	50
Frequency(Cycle/min)		60	45	30
Repeat Accuracy(mm)		±0.1 (After initial 100 operation) / ±0.2 (After 1 million operation)		
Gripping force(N) ※ P = Mpa, L=mm	Open	$\frac{224.84xP}{1+0.032xL}$	$\frac{356.81xP}{1+0.025xL}$	$\frac{516.64xP}{1+0.022xL}$
	Close	$\frac{168.63xP}{1+0.032xL}$	$\frac{267.6xP}{1+0.025xL}$	$\frac{397.6xP}{1+0.022xL}$
Weight(kg)		0.13	0.27	0.46

Structure

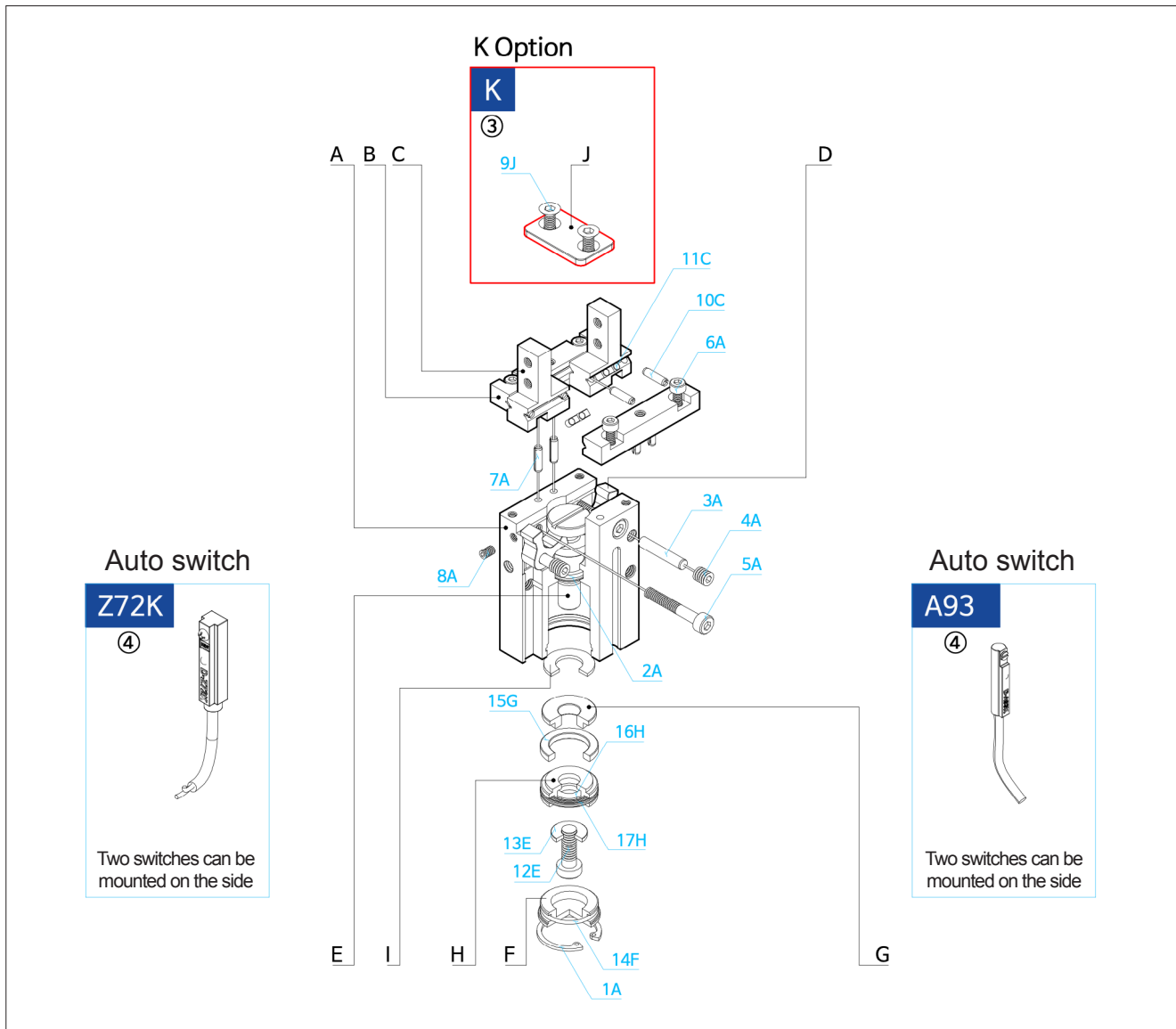

No	Parts	Material	Remark
A	Gripper Body	Aluminum alloy	Hard Anodizing
B	JAW Guide	Steel alloy	
C	JAW	Steel alloy	
D	Link lever	Steel alloy	
E	Plunger	Steel alloy	
F	End cover	Aluminum alloy	White Anodizing
G	Magnetic cover	Aluminum alloy	White Anodizing
H	Piston	Aluminum alloy	White Anodizing
I	Damper	Urethane rubber	
J	Dust cover	Aluminum alloy	Cover type - K

No	Parts	Remark
1A	Snap ring	
2A	Rod packing	
3A	Dowel pin	
4A	Headless bolt	
5A	Wrench bolt	
6A	Wrench bolt	
7A	Pin	
8A	Headless bolt	
9J	Countersunk bolt	Cover type - K
10C	Spring pin	
11C	Cross roller	
12E	Piston Fastening bolt	
13E	Washer	
14F	O-ring	
15G	Neodymium Magnet	
16H	O-ring	
17H	Piston packing	

Dimensions

KPG01-16

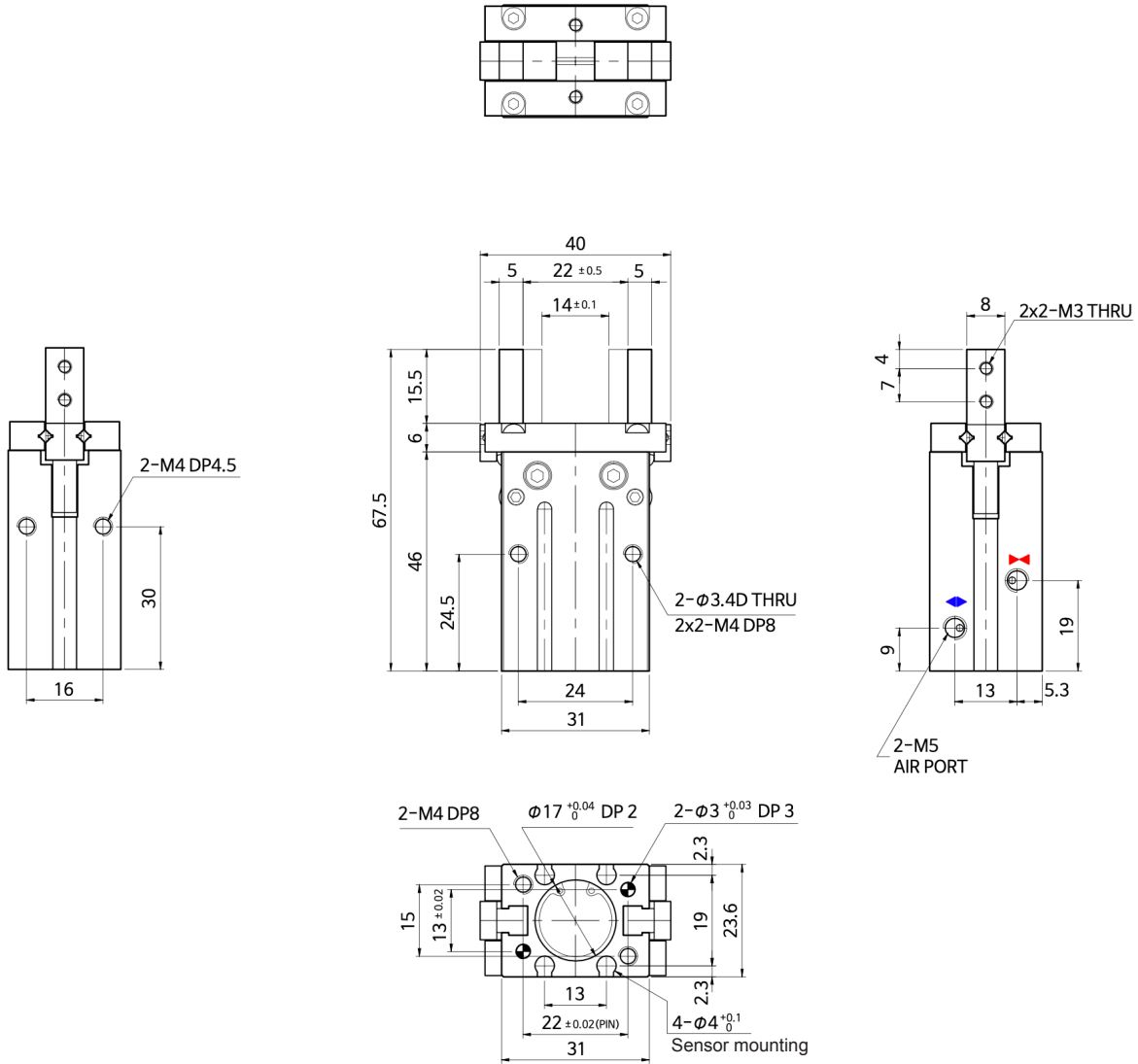

KPG01-16K
③

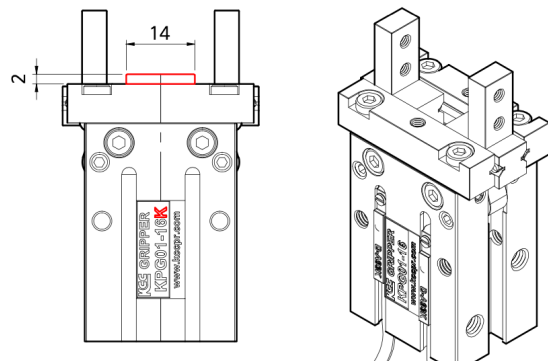
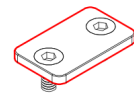

Dimensions

KPG01-20

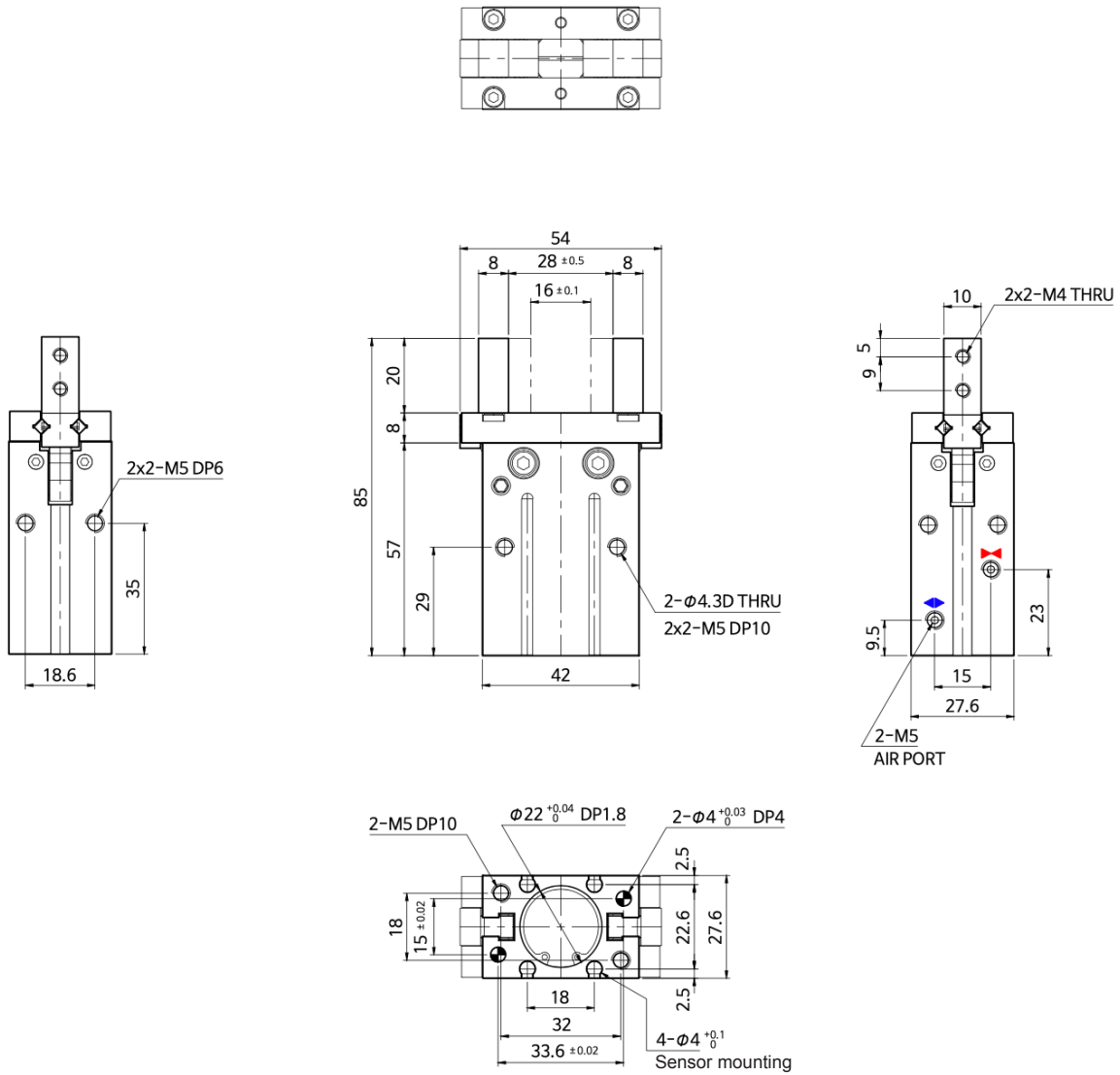

KPG01-20K ^③

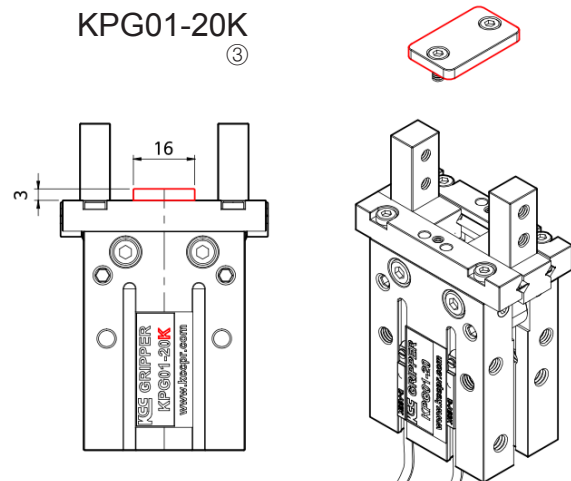

Effective gripping force

Gripping force [N] (Pressure = 0.5[MPa])

◆ : Open | ● : Close

◆ KPG01-16

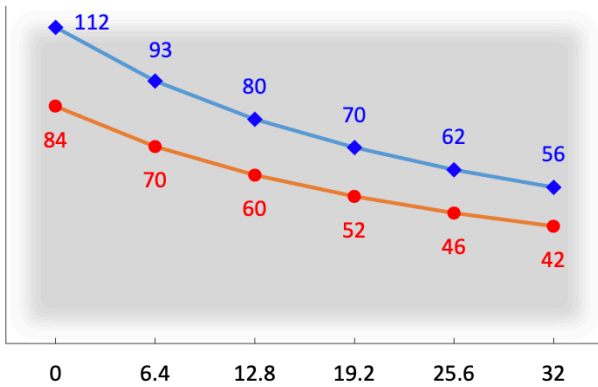

◆ KPG01-20

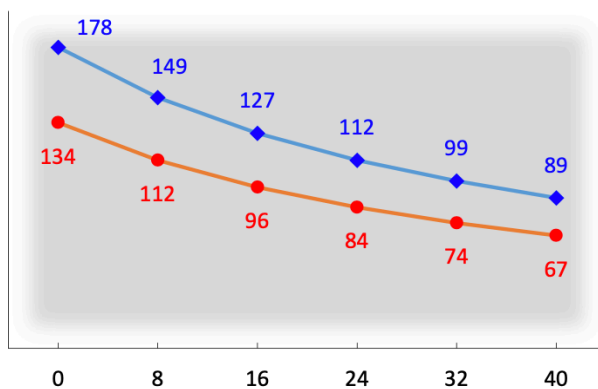

◆ KPG01-25

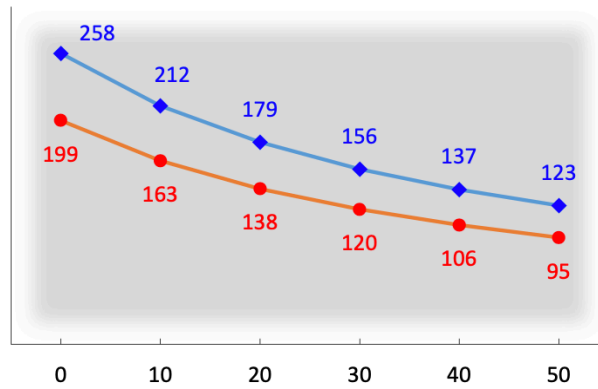

WORK weight by condition when closed [kg] (Pressure = 0.5[MPa])

(Condition of use)
 — : Fixed or slow moving
 — : General deceleration and acceleration such as linear motion
 — : Rapid deceleration and acceleration such as robot attachment or rotation

