

# KLCS series

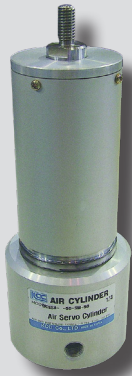

KLCS CA 50-50

### Features

- Seal is not applied this ensures smooth and sensitive movement to minor load variation.
- Due to the high efficiency, almost 100% of the supply pressure is used as driving force. It is also applicable with low pressure.

### Symbol

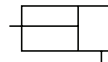

Single Acting / Single Rod

## How to Order

KLCS - CA - 50 - 50

①                      ②                      ③                      ④

### ① Series

|     |                    |
|-----|--------------------|
| LCS | Labyrinth cylinder |
|-----|--------------------|

### ③ Bore size

|     |     |     |     |     |     |      |
|-----|-----|-----|-----|-----|-----|------|
| 20  | 30  | 40  | 50  | 63  | 80  | 100  |
| Ø20 | Ø30 | Ø40 | Ø50 | Ø63 | Ø80 | Ø100 |

### ② Mounting style

|    |               |
|----|---------------|
| CA | Single clevis |
| CB | Double clevis |

### ④ Cylinder stroke

|                 |     |     |     |     |     |     |      |
|-----------------|-----|-----|-----|-----|-----|-----|------|
| Bore size       | Ø20 | Ø30 | Ø40 | Ø50 | Ø63 | Ø80 | Ø100 |
| Standard stroke | 50  | 50  | 50  | 64  | 78  | 108 | 144  |

## Specifications

|                             |   |
|-----------------------------|---|
| Action                      | Single acting   |
| Fluid                       | Clean air (for 5 $\mu$ m Filter & Oil remove filter)                            |
| Max. stroke                 | 300mm   |
| Min. operating pressure     | 0.02 ~ 0.4kgf/cm <sup>2</sup> (0.002 ~ 0.04MPa)                                 |
| Ambient & fluid temperature | -10 $^{\circ}$ C ~ 40 $^{\circ}$ C<br>(Contact KCC for higher temperature type) |
| Lubrication                 | Not required (Do not lubricate)   |
| Standard stroke             | Refer to the standard stroke table above  |
| Internal leakage            | 300 l/min (ANR) (for Ø50 cylinder at 0.4kgf/cm <sup>2</sup> )                   |
| Attachment direction        | Vertical (within 15 $^{\circ}$ from vertical axis)                              |

## Application

- Film winder tension control.
- Control the tension of textile machinery.
- To maintain balance of electric servo mechanism.

Dimensions

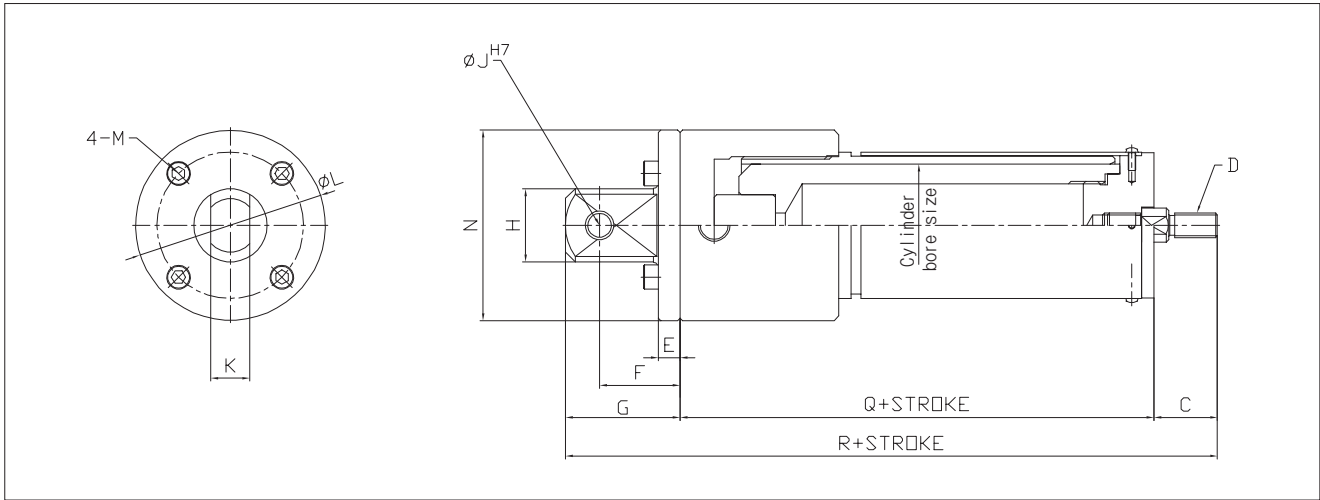

Unit : mm

| Bore size | A  | B | C  | D        | E  | F  | G  | H   | J  | K  | L   | M    | N   | P          | Q   | R   |
|-----------|----|---|----|----------|----|----|----|-----|----|----|-----|------|-----|------------|-----|-----|
| Ø20       | 20 | 5 | 25 | M8X1.25  | 0  | 11 | 21 | Ø22 | 8  | 12 | 0   | 0    | 38  | Rc(PT) 1/8 | 89  | 135 |
| Ø30       | 20 | 5 | 25 | M10X1.5  | 0  | 13 | 25 | Ø26 | 10 | 14 | 0   | 0    | 48  | Rc(PT) 1/8 | 124 | 174 |
| Ø40       | 27 | 5 | 25 | M10X1.5  | 0  | 14 | 27 | Ø30 | 10 | 16 | 0   | 0    | 59  | Rc(PT) 1/8 | 136 | 195 |
| Ø50       | 20 | 6 | 26 | M10X1.5  | 9  | 33 | 47 | Ø30 | 10 | 16 | 60  | 7    | 78  | Rc(PT) 1/4 | 144 | 217 |
| Ø63       | 23 | 7 | 30 | M12X1.75 | 10 | 38 | 54 | Ø35 | 12 | 18 | 70  | 9    | 90  | Rc(PT) 1/4 | 143 | 227 |
| Ø80       | 32 | 8 | 40 | M16X2.0  | 12 | 44 | 64 | Ø40 | 15 | 22 | 80  | 9    | 100 | Rc(PT) 1/4 | 190 | 294 |
| Ø100      | 40 | 8 | 48 | M18X1.5  | 14 | 60 | 90 | Ø56 | 18 | 26 | 100 | 12.5 | 130 | Rc(PT) 1/4 | 312 | 450 |