

NOTES:

1. TOLERANCES INDICATED ADVISORY ONLY; FINAL TO BE AGREED
2. RADIUS ON FORMED SECTION IS ACCEPTABLE
3. THINNING OF WALL THICKNESS DURING FORMING TO BE AVOIDED
4. ENDS TO BE CUT SQUARE TO TUBE

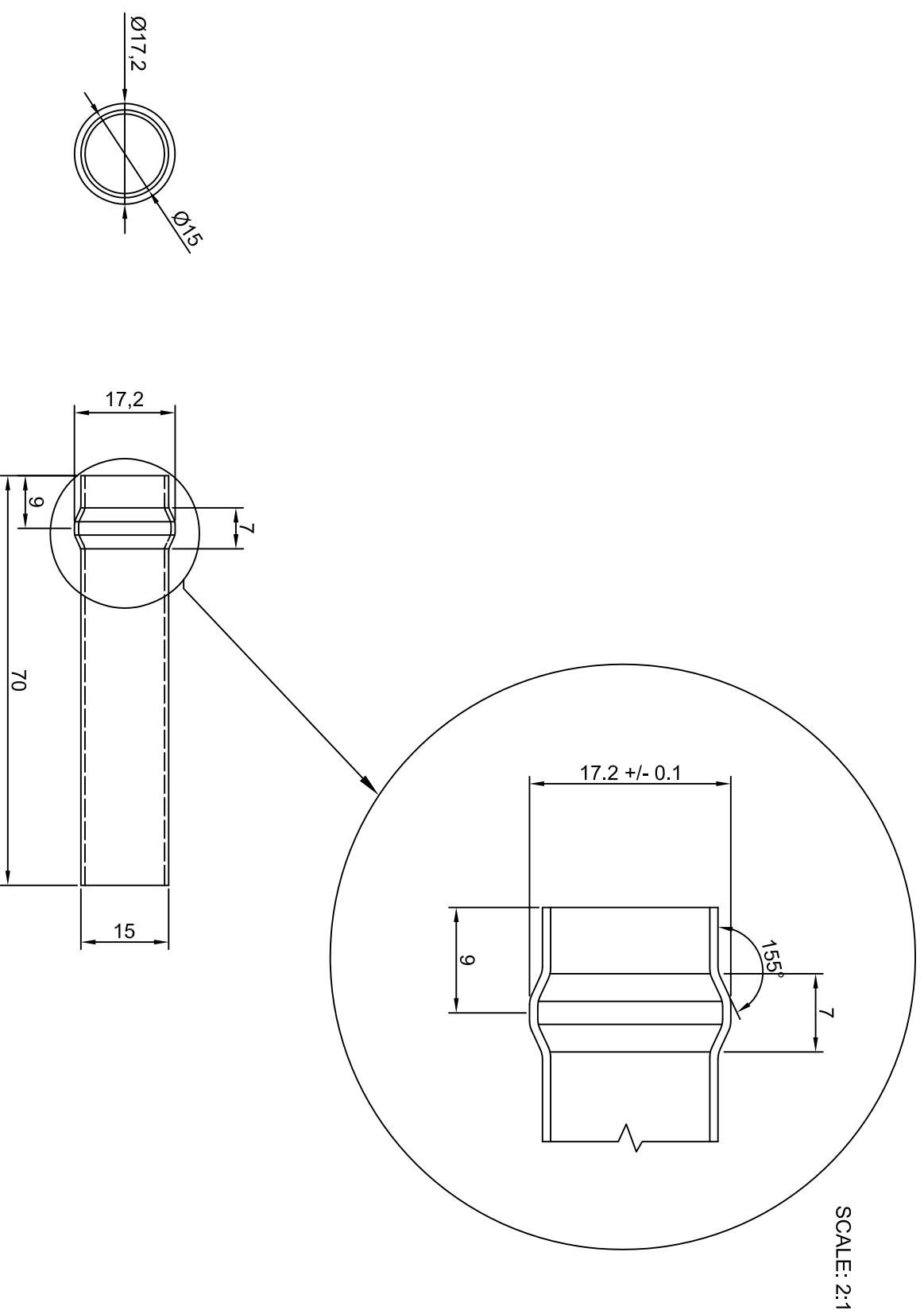

SCALE: 1:1

SCALE: 2:1

MATERIAL: 15mm COPPER TUBE EN1057;
TABLE Y; BS2871 Pt1; HALF HARD

FINISH: REMOVE ALL SHARP EDGES,
DEGREASE

Rev	DATE	REVISION HISTORY	Desg	Dwn	Chk	App
C	12/01/15	REVISED DIMENSIONS				
B	11/07/14	REVISED DIM. END TUBE TO FORMING				
A	09/05/14	FIRST ISSUE FOR MANUFACTURE				

ALL REVISIONS

ORIGINATOR

 Woodford Heating & Energy Ltd
 Unit 17, Forest trading Estate
 Pilestley Way, Walthamstow,
 London, E17 6AL
 Tel: 0208 531 0004; www.woodfortheating.com

DRAWING TITLE
FORMED OLIVE PIPE SECTION
15mm DIAMETER

Name	Signature	Date
Designed by AK NEAVE		08/05/2014
Drawn by		
Checked		
Approved		

SCALE	FILE NAME
1:1 & 2:1	
PROPOSED STATUS	

DRAWING NUMBER	REV
WHE - 14001 - C	C