

Wardrobe Lifter

Installation Instruction for G08

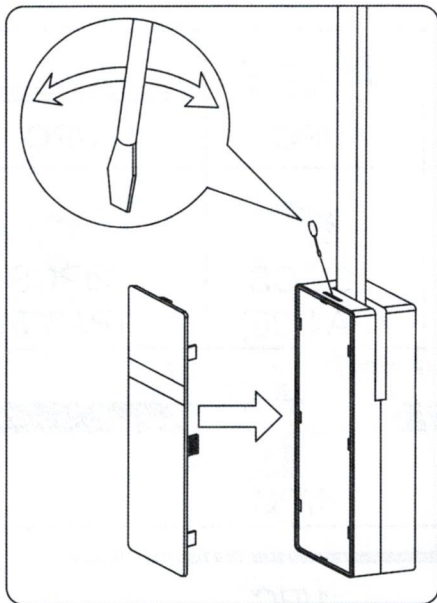

2. After installation, align and flatten the decorative cover. Insert a slotted screwdriver into the removal hole and pry it forward to remove the decorative cover.

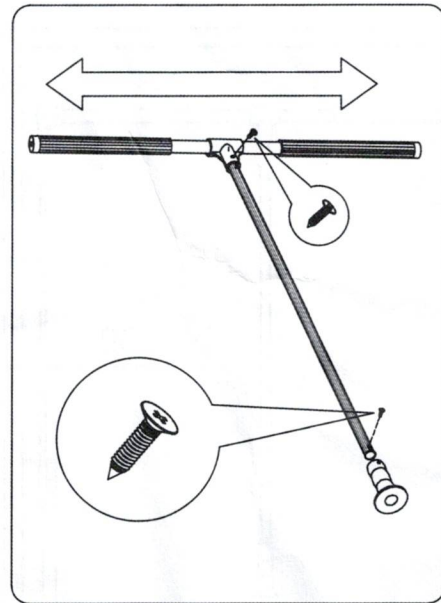

3. Use st3*5 pan head screw to fix bar and handle, adjusting hanger rod to suitable width

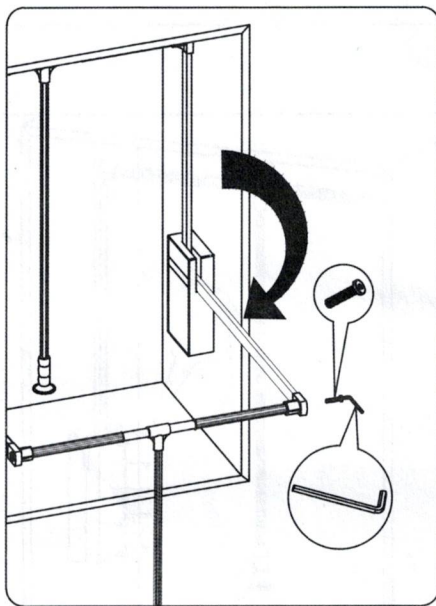

4. pull down the wardrobe lift and install connector and hanger rod as photo showed, and fix then by M8*35 hexagon head screw

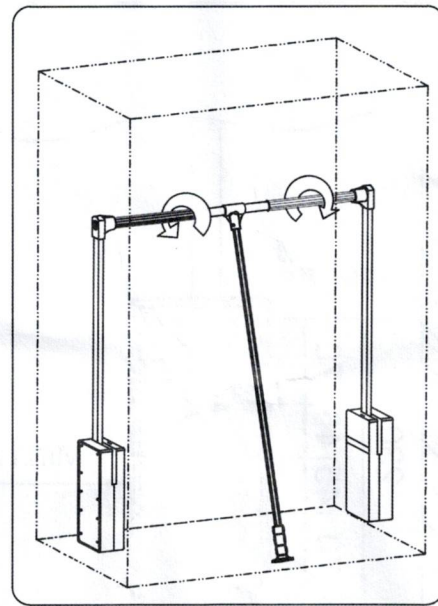

5. Adjust the bar to the suitable position and revolve it till tighten point according to direction of photo showed. Then fasten the hexagonal head screw