

Middle School Drop-off/Pick-up Procedures

Thank you for enrolling your child(ren) in the Holy Trinity CCD program. Our records indicate that your child(ren) are attending the 6:30PM Wednesday Evening session and will be in the **Coldwater Middle School building**.

Drop-off/Pick-up

Please enter the parking lot on the south side of the school (Rusty parking lot) using the entrance on North street. Drive up along the building in the lane marked on the parking lot and exit through the exit on Market street. For the safety of all students and drivers, please do not pull out of the curbside lane early, wait your turn to avoid any accidents. Students will enter through doors 23 & 25 only.

We will have a monitor watching the curbside lane to let students who are walking get across and watch for safety. Please be safe and be aware of all traffic and people walking.

Middle School parking

Parents, if you are parking, please park in the lot on the South side of the school (Rusty parking lot). Students will enter through doors 23 & 25 only.

Please avoid parking on Market Street, in the Methodist church parking lot, or in the small parking lot on Market Street (this is for religion staff) so that students do not need to cross the street. Adhere to all signs in the parking lot for entrances and exits.

1st grade parents

Please bring your child to their room and pick them up in their room. Do not use the curbside drop-off or allow them to walk themselves. Thank you.

A map of the rooms is on the reverse side.

Middle School 1st Floor

- OFF-Stalder
- OF1-Pohlman
- OF2-Nurse
- OF3-Bills
- OF4-Conference
- OF5-Record Storage
- OF6- open office
- OF7-Clinic
- OF8-Work/Copy room

-  Restrooms
-  Copier

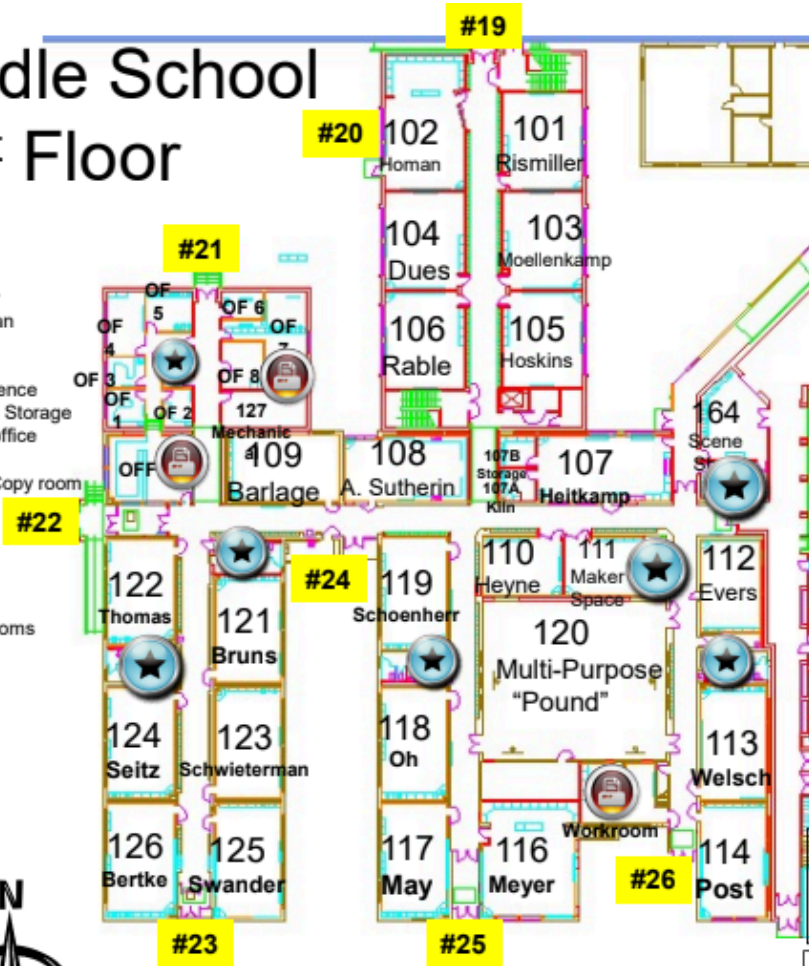

Middle School 2nd Floor

Choir Room
Wendel

Band Room
Ruckman

