

Magic

Magic Polo Plast Ltd.

Design, Development & Injection Molding



Catalogue
2023

Construction
Product
Solutions



Spacer for Walls, Column & Beams

Spacers for Reinforced Concrete

DH - Round spacer

Units per bag	Concrete cover (mm)	Total Dia (mm)	For bar Ø (mm)	Type	Ø	No.
250	20	48	6-18	Round		DH-20
500	25	56	6-18	Round		DH-25
500	30	62	6-18	Round		DH-30
			See down table: STAR-40			DH-40
			See down table: STAR-40			DH-50

Universal spacer for bars of varying thickness
Compatible with horizontal bars

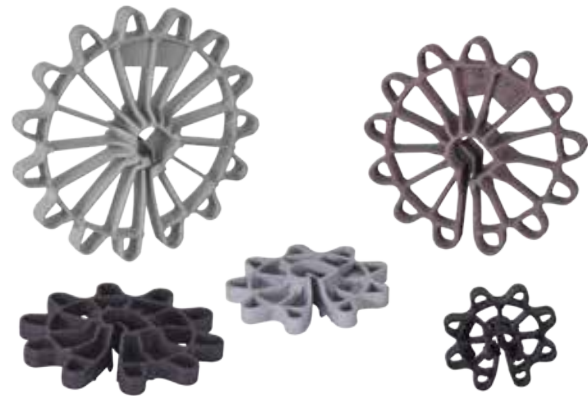

STAR - shaped spacer

Units per bag	Concrete cover (mm)	Total Dia (mm)	For bar Ø (mm)	Type	No.
1000	20	50	6-10	Star	STAR-20
1000	25	60	6-18	Star	STAR-25
500	30	73	6-18	Star	STAR-30
250	40	92	6-18	Star	STAR-40
150	50	112	6-18	Star	STAR-50

Recommend use: 4 spacers/sqm
Optimum contact point with the formwork.
Prevents corrosion and leaves a clean finish on the concrete surface.



Point & Large area type

Ladder-shaped spacer for walls reinforcements

Units per box	Length (mm)	For bar Ø (mm)	Concrete cover (mm)	No.
500	220	UP TO 14	20	SULAM-20
500	220	UP TO 14	25	SULAM-25
500	220	UP TO 14	30	SULAM-30
350	220	UP TO 14	35	SULAM-35

* Recommended use: 2 spacers/sqm

Hung to a horizontal bar by its hook
Supports a large area, Remains stable during casting



RING - spacer

Units per beg	Dia Rings (mm)	For bar Ø (mm)	Concrete cover (mm)	No.
100	222	6-25	25	RING-25
100	222	6-25	30	RING-30
80	222	6-25	40	RING-40

* Recommended use: 2 spacers/sqm

Hung to a horizontal bar by its hook
Available on request in extra-strong plastic for heavy duty loads

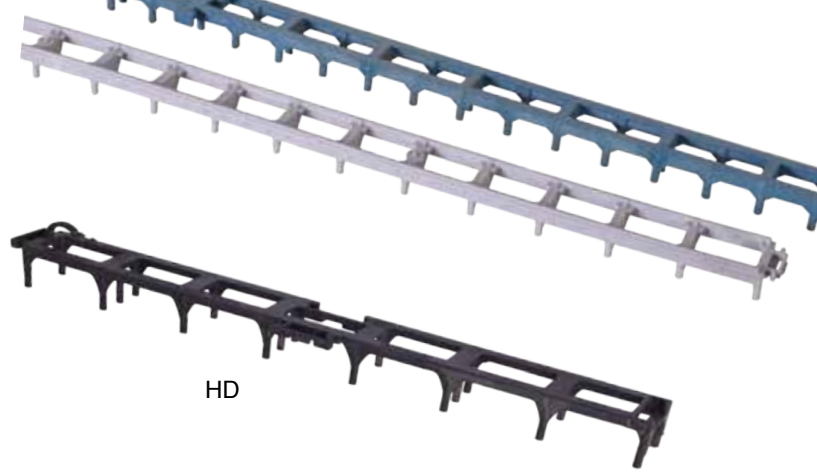

Multi-Legged "NADAL"

Spacer for supporting lower reinforcements in ceilings, beams and walls

Palette M.	Meter per bundle	Units per bundle	Length (cm)	Liner Width (mm)	Concrete cover (mm)	No.
4000/4800	100	96-66	104.3-151.6	36	25	NADAL-25
4000/4800	100	96-66	104.3-151.6	36	30	NADAL-30
3200	100	100	100	6	35	NADAL-35
2800	100	100	100	36	40	NADAL-40
1200	50	100	50	51	50	NADAL-50HD
1000	50	100	50	51	60	NADAL-60HD
1000	50	100	50	51	70	NADAL-70HD

* Heavy duty type with a vertical Hanging hook



Support liner "zorro"

Has one leg in a "zigzag" shape



Palette M.	Meter per bundle	Units per bundle	Length (cm)	Liner Width (mm)	Concrete cover (mm)	No.
6000	100	96	104	34	25	ZORRO-25
6000	100	96	104	34	30	ZORRO-30

- * Easy to apply (compared to single spacers)
- * Avoids the formation of corrosion moisture of moisture to corrosion developments
- * A good flow of the concrete around the ribs is possible
- * No segregation due to good pouring around the one-sided rib
- * elegant solution for compacting concrete without segregation
- * Available in white/gray colors for architectural concrete

- Laying - "Zero" only parallel to the direction of tension
- The Zorro can be extended using an "outlet plug" at the edges
- Use in prefabricated parts



Spacer type "M" for walls, ceilings & beams

Units per box	Concrete cover (mm)	For bar Ø (mm)	Type	No.
3000	15	5-6	Leg	NT 5-6
1000	20	6-10	Flat	M 8/20
500	20	12-20	Flat	M 14/20
500	25	6-10	Flat	M 8/25
250	25	12-20	Flat	M 14/25
250	25	18-25	Flat	M 20/25
500	30	6-10	Flat	M 8/30
250	30	12-20	Flat	M 14/30
250	30	18-25	Flat	M 20/30
500	30	6-16	Level	M 12/30
500	35	6-16	Level	M 12/35
500	40	6-16	Level	M 12/40
500	50	6-16	Level	M 12/50

 * Suitable for carrying human weight

Clipston

Stone board holding element for a wall made with marble

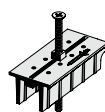
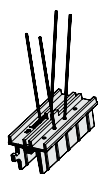

Units per sack	Length (mm)	concrete cover(mm)	Description	No.
400	80	25	Seat	Clipston-25
400	80	30	Seat	Clipston-30

Method for fixing stone boards to the formwork using a plastic base fastened with a screw (4-5mm) or galvanized wire

* sparing use of iron

* Additionally, functions as a spacer



fixation using thin wire binding



fixation using screw



Spacer standing on a soft surface

Units per bag	Concrete cover (mm)	For bar Ø (mm)	Dia. Base (mm)	No.
200	30/40	UP TO 12	85	MK 30-40
100	50/60	UP TO 12	115	MK 50-60

* Recommended use: 4 spacers/sqm

Spacer with a larger contact area base, especially for soft surfaces. Suitable for: styrofoam boxes, honeycomb slabs & sealing layers. Can "clip on" from two angles for two different heights.

"Leg" Spacer for elevating Styrofoam boxes

Massive Heavy-duty spacer for pile foundation works



Units per bag	Concrete cover (mm)	No.
200/150	5-10,12	SK

* Recommended use: 4 spacers/sqm



Custom spacer:

* Customized leg of varying height for controlled elevation

* Anchoring spike for fixed support



Pile sliding wheel spacer

Massive Heavy- duty spacer for pile foundation works

Units per bag	Concrete cover (mm)	For bar Ø (mm)	Wheel Width (mm)	Dia. Wheel (mm)	No.
200	50	6-10	33	110	CS-110L
80	65	6-12	24	140	CS-140
100	70	6-10	38	150	CS-150
90	78	6-10	38	165	CS-165 (6-10)
90	73	12-16	38	165	CS-165 (12-16)
50	90	6-10	47	190	CS-190
40	104	6-10	48	220	CS-220(6-10)
40	100	12-18	48	220	CS-220(12-18)

* Fixed on the lateral tie or spiral reinforcement only!

* Every 300 cm install 4 wheels around a single tie.

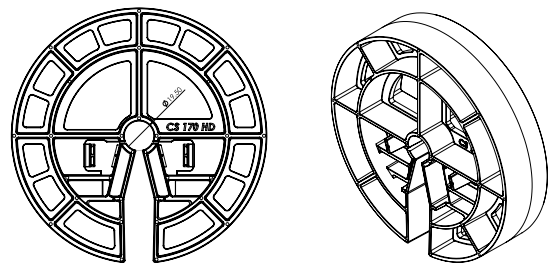
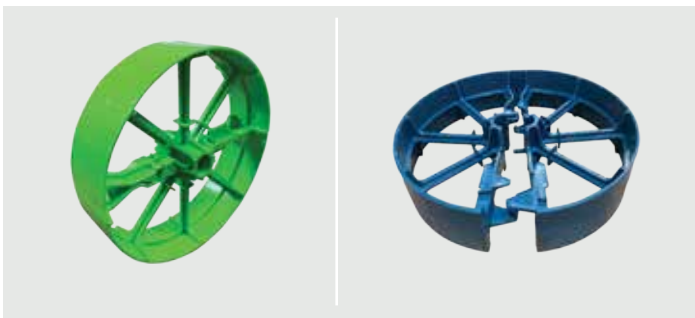

Plastic Spacer Anchors

for Bolt Systems or Tension Cables
in Soil & Rock Drilling

Tension Strand Separator



Pie. per bag	Inner Dia Ø (mm)	Outer Dia Ø (mm)	No. of cables	No.
500	21	53	7	SOS-53/21
200	25	67	7	SOS-67/25
200	35	67	7	SOS-67/35

Plastic Separator spacer for tension stands anchoring system
Used to bind around it the tension stands inside ribbed pipe and allows inserting the grouting tube from the center hole of the spacer, all along, for quality grouting.



"Zahal" Segmental spacer for strand anchor

Tension stand separation

Pie per bag	Arc lenght (mm)	Arc height (mm)	No. of arch's	Dia. ribbed sheath	No.
60	165	10	5	75-90	F-16
40	220	35	7	75	ZAHAL-75
40	220	35	8	90	ZAHAL-90
40	220	35	12	125	ZAHAL-125
60	348	18	4	-	ZAHAL-SUPER

1. Cutting to size that can assemble to round bolts.
2. Outer base spacer, assists in guiding the ribbed sheath and maintaining distance from the sides of the drilled hole, Suitable for drilling diameters 120-150mm.

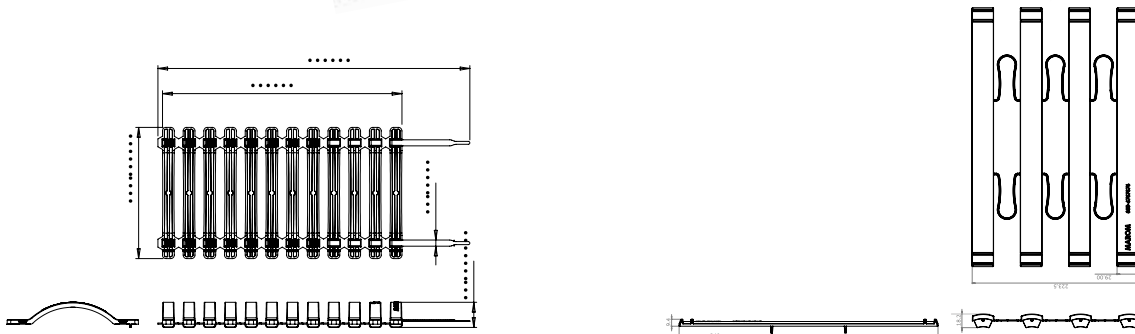

Anchors Circular Spacer "GEORGE"

Spacer for rock Anchoring bolts

Pie per bag	Inner Dia Ø (mm)	Outer Dia Ø (mm)	No. of wings	Type	No.
150	22-28	104	4	Rock	GEORGE-104
50	32-36	136	4	Rock/Soil	GEORGE-136

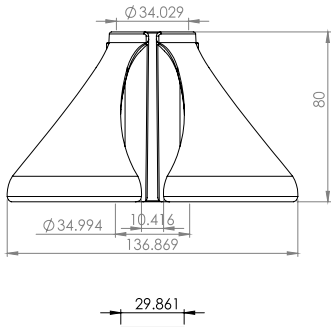

Soffit

Funnel-shaped anchor head for grout tube and its ribbed sheath



Pie per bag	Grouting pipe Ø (mm)	Dia. Ribbed sheath Ø (mm)	No.	מק"ט
100	20-21	75		Soffit-75

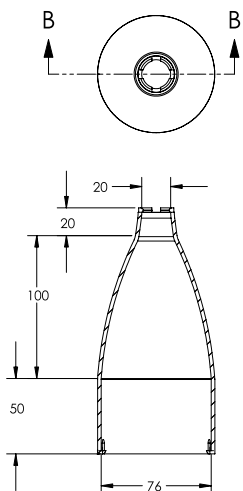

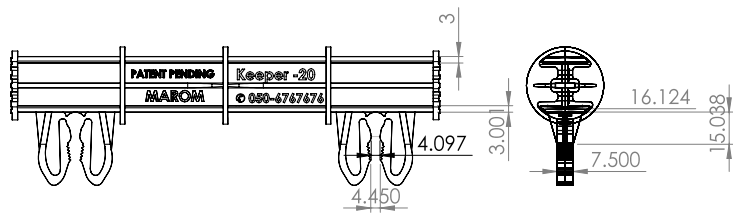

Keeper

Form work Spacer

HD Spacer made of ABS
 Securer the spacing between reinforcement mesh
 and concrete cover

Unit per bag	Concrete coverage (mm)	Spacing between	bar (mm)	Wall thick (mm)	No.
100	20	140	6-12	200	Keeper-20
100	25	190	6-12	250	Keeper-25
100	30	230	6-12	300	Keeper-30

* Can be Ordered for different Sizes.

Compressive Strength of 600 Kg (SII)

- Waterproof
- Prevents Corrosion
- Time Saving
- Uniform finish without deformation and crack (wooden spacer) of rust spots on concrete.



Plastic Shims

Spacing shim for grid adjacent to a wall,
 used for placing wall tiles

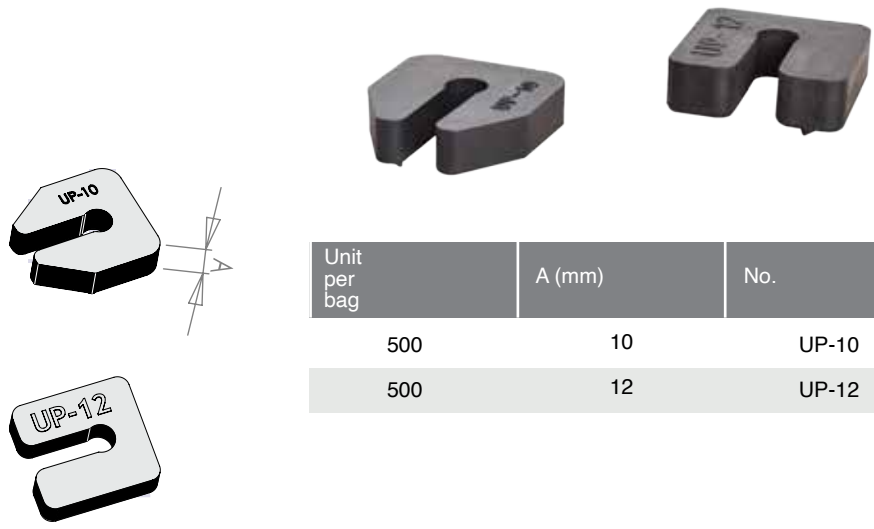

Unit per bag	A (mm)	No.
500	10	UP-10
500	12	UP-12

Support Cones

Edge support cones compatible with tube spacer

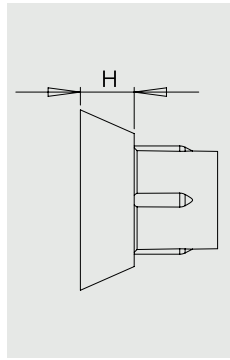

Units per bag	Tube Dia Ø (mm)	Height (mm)	No.
500	22	10	CSA
250	22	30	CSA-22/30
500	26	10	CSA-125
100	26	20	CSA-26/20
250	22	50	CSA-22/50
250	26	50	CSA-26/50

T-shaped Spinner hand tool for removing CSA cones

Spinner

Sealing Plugs

PLUG is meant for watertight sealing of hollow of DYWIDAG formwork tie rods



Units per Bag	Color	Description	No.
500	Grey	Plastic Knock cone plug 22 mm	KP-1
500	Grey	Plastic Knock cone plug 26 mm	KP-2
500	Transparent	Soft PVC compressed plug 22mm	KP-3
500	Transparent	Soft PVC compressed plug 26mm	KP-4
100	Blue/Gray	nylon impact-proof plug & Soft water swellable sealing	KP-10
100	Green	MARBLE PLUG: Soft sealing and water expandable rubber	KP-11
100	Gray	PLASTIC Knock plug 22mm for Hexagon	KP-12



500	Black/Gray	Plastic plug with circumferential ,22 mm	CP-25
500	Orange	Plastic, flat cap for sealing Metal form tie holes which are not required 22-24mm	P-25
500	White	Protection nylon ring for formwork tie-rod holes	T-P-25
100	Blue	Connector strip 15mm	STRAP 15/17

Dochfa Adjustable handle Insertion Tool

The efficient device for installing KP-PLUGS in the outdoor walls of

Special design for installing sealing plugs in holes at
Allows full control of the depth of cork fixation

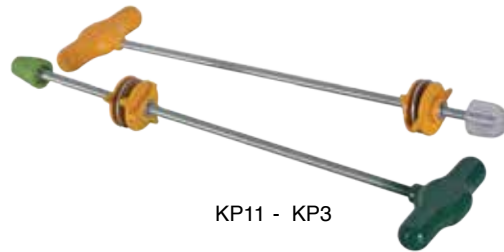

KP11 - KP3

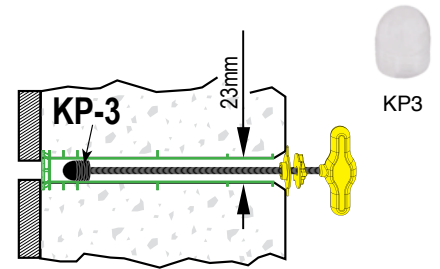
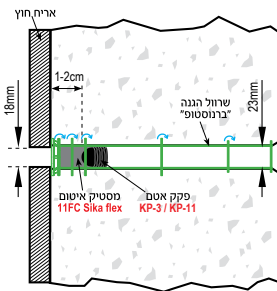
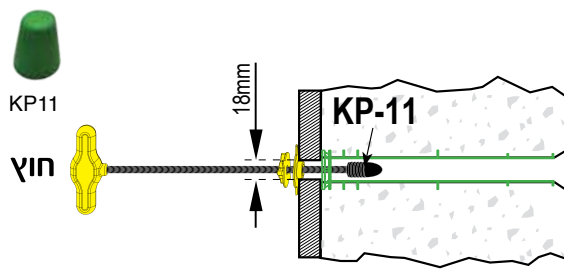
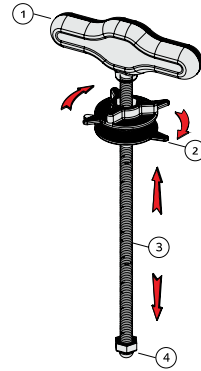

Insertion stages



Push in

Insert in

Plug in

Adjusting

marking

SAFETY

Protective Strip



A protective strip made of reinforced polymer interlocking with metallic core. Used to protect workers against injuries from bars edges in case of falling.

The protection strip can be easily assembled horizontal or vertical. Resistance to variable weather conditions and can be reusable. Suitable for bars with a diameter of 8 - 40 mm. Protection tested from a height of 3.0m up to 100kg

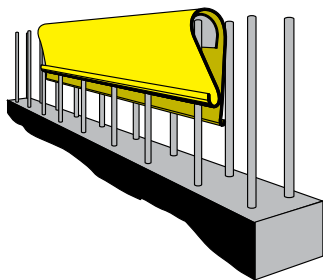

Protective Cap

Protective Cap - in bright colors for securing iron ends that may cause serious injury

Units per box	Color	Type	Dia. Bar (mm)	Ø	No.
500	Yellow/Orange	Small	6-18		MR 6-18
200	Yellow/Orange	Large	12-28		MR 12-28
100	Orange	Large	10-25		MGS 10-25



Protective Cap with Steel Core

צינור הגנה הֶקְסָגוֹן HEXAGON

צינור הגנה לשמירת מרחק בין הטפסות ליציקת קירות

מצוייד בקונוס תמיכה מובנה שביר בקצה. טבעות מכשול מים בצורת מְשָׁשָׁה (HEXAGON, הֶקְסָגוֹן) מתאים לעבודה בקירות בטון, קירות מרתף, מאגרי מים וקירות בשיטת ברנבו'ץ.



Pie. per Bag	Outer Dia. (mm)	Inter Dia. (mm)	Wall thickness (mm)	No.
100	24	22	150	Hexagon-15
100	24	22	180	Hexagon-18
100	24	22	200	Hexagon-20
100	24	22	250	Hexagon-25
100	24	22	300	Hexagon-30
100	24	22	350	Hexagon-35
100	24	22	400	Hexagon-40



Spinner in action

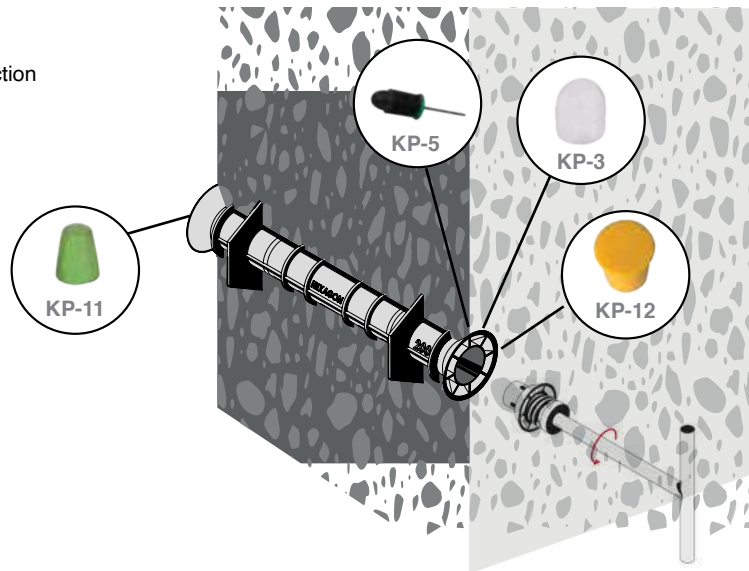

שימוש בפקקי אטימה שונים



Plastic Box For Latch



Plastic box for creating sockets in concrete walls. These serve to hold scaffolds in elevator shafts, and as a latch for hanging scaffolds between walls.



Units per bag	Dimensions (mm)	No.
70	145/160/73	PER-BOX
48	205/205/140	DOK-BOX

H-BLOCK Shuttering for concrete lintel

A simple installation of a plastic stand above a row of blocks for casting a continuous concrete beam

Unit per bag	Size H (mm)	block width cm	No.
70	150	70	H - BLOCK7
80	200	100	H - BLOCK10

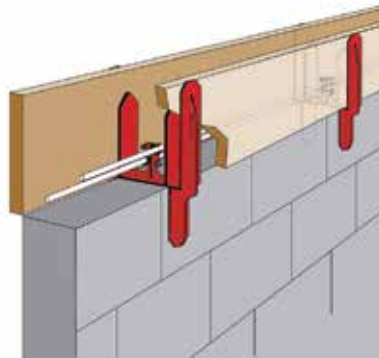
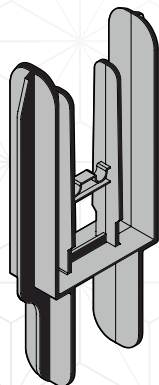

Cavity slab plug

Prevents the concrete filling in slabs hollows
Easy to install and remains fixed in place

Per Pallet	Unit per bag	Plug Depth (mm)	Slabs thickness	Dia. Cavity Ø (mm)	Type	No.
	200	55	200	120	Round	LOHAD-120/55
	100	50	250	150	Round	LOHAD-150/50
2800	175	55	300	180	Round	LOHAD-180/50
	-	60	350	180	Round	LOHAD-350/60

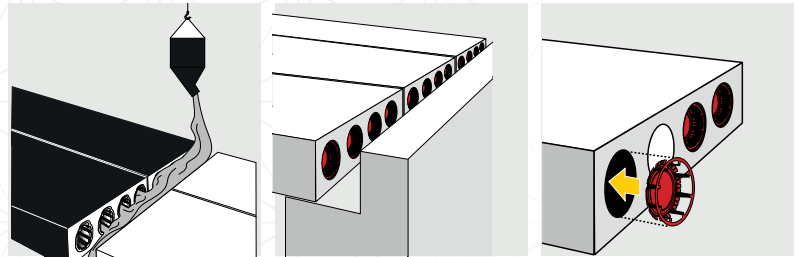

Per Pallet	Unit per bag	Plug Depth (mm)	Slabs thickness	Dia. Cavity Ø (mm)	Type	λ10	No.
5184	144	100	200-250	-	oval		LOHAD-200/250
2720	170	100	300-350-400	-	oval		LOHAD-300/350



Leveling System



A new model of tile spacer, which combines two functions in one product

- Tile spacer
- Leveling straight between tiles.



Unit per bag	'n'	Tile thick. mm	Color	Size A (mm)	No.
250		6-12	צהוב yellow	2	LS-2
250		6-12	ירוק green	3	LS-3
250		6-12	אדום red	4	LS-4
250		6-12	כחול blue	5	LS-5

Clamping pliers

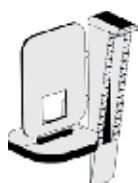

Stone wedges

Heavy Duty wedges for stone covering

A special design of wedge for Stone walls

- Heavy Duty
- Ergonomic fingers grip create uniform spacing

Leveling of stone board layer

Adjusting to the required depth between stone

Unit per bag	Size B (mm)	Size A (mm)	No.
250	18	10	SHAMP-10/18
250	18	15	SHAMP-15/18
250	18	20	SHAMP-20/18

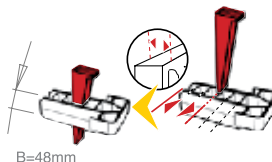
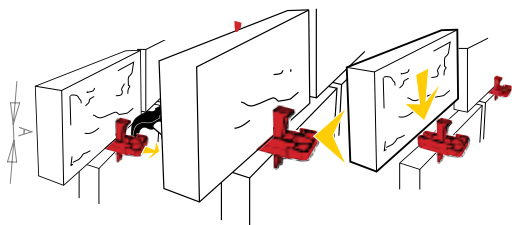

Clipster-S screed Fastener™



Patent Pending

The ideal solution for plastering using leveling flatness guides.

You can attach the flatness guides quickly and easily. No need to wait for the glue to dry out. Allows a maximum finishing accuracy.



Unit per bag	Width screed mm	No.
250	21	CLIPSTER-S

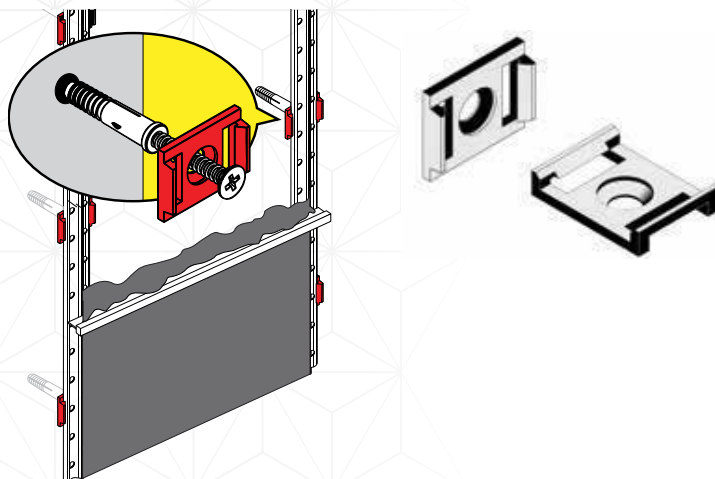

CLIPSTER-T corner plaster profile

Simple connection in 90° corners for leveling the "Corner profile - indoor plaster"

Adjustable fixation corner strip for quick and easy attachment.

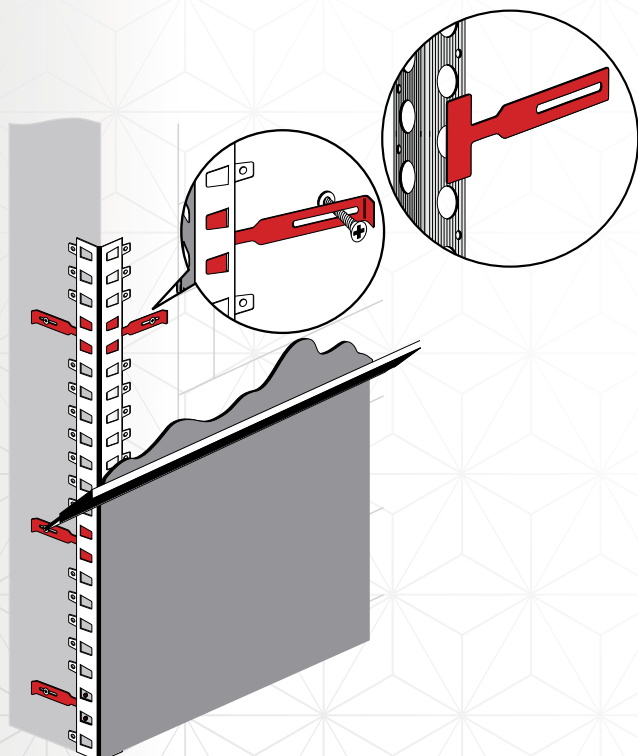

Unit per bag	Arm length mm	No.
250	100	CLIPSTER-T



CLIPSTER-U Profile Gripper Profile

During construction process, one must attach elongated profiles (normally made of metal) to a surface, such as a wall, for decoration or anyother purposes.

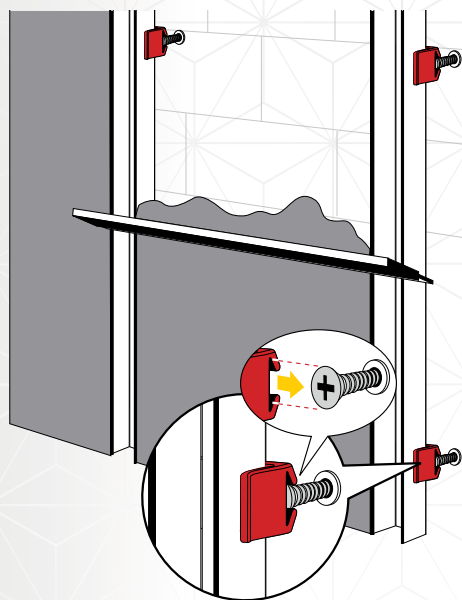

Unit per bag	Profile size mm	No.
250	10/10	CLIPSTER-U

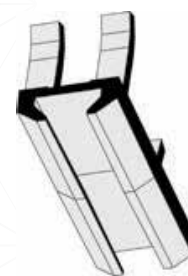
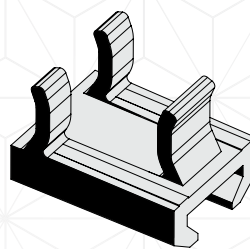

Heavy duty flexible tubs

- Uv protected
- Flexible
- Washable
- Lightweight
- Extra strong & durable
- Super strong handles

Our tubs are useful for many different jobs in the house and the garden: transport plants and plant bulbs, carry leaves & wood, watering & feeding livestock and many other farm uses. They are also suitable for washing cars, laundry, party buckets and more. Our heavy-duty tubs are can also be used on building sites and other professional uses.

Available in a wide variety of assorted fashionable colors.



60L/15.8Gal



42L/11Gal



28L/7.4Gal

Item No.	Description	Price per Unit	Product Dim cm/inch		Weight per Unit Kg/Lbs	Qty Per Master	Packaging Details Master cm/inch		Master Pack Weight Kg/Lbs	Pallet Dim cm/inch	Qty per pallet 20"	Qty per pallet 40HC"	20' Container load	40HC' Container load
			H	Ø			H	Ø						
T1028	28L tub		36 / 14.1	40 / 15.7	0.67 / 1.57	10	56 / 22.0	40 / 15.7	6.8 / 15	80x120 / 31.5x47.2	720.0	780.0	7,920	17,940
T1042	42L tub		36.5 / 14.3	45 / 17.7	0.88 / 1.77	10	51 / 20.1	45 / 17.7	8.9 / 19.6	100x120 / 39x47.2	750.0	800.0	7,500	16,800
T1060	60L tub		42 / 16.5	53 / 20.8	1.35 / 3.00	10	54 / 21.3	53 / 20.8	13.6 / 30	100x100 / 39x39	480.0	520.0	4,800	11,440



15L/4Gal



15L/4Gal



12L/3.2Gal

Item No.	Description	Price per Unit	Product Dim cm/inch		Weight per Unit Kg/Lbs	Qty Per Master	Packaging Details Master cm/inch		Master Pack Weight Kg/Lbs	Pallet Dim cm/inch	Qty per pallet 20"	Qty per pallet 40HC"	20' Container load	40HC' Container load
			H	Ø			H	Ø						
T1012	12L Tub		24 / 9.4	35 / 13.8	0.42 / 0.92	10	37 / 14.6	35 / 13.8	4.2 / 9.2	100x100 / 39x39	1,440.0	1,440.0	14,400	31,680
T1015S	15L Tub Flat		20 / 7.9	42 / 16.5	0.45 / 0.99	10	33 / 13.0	42 / 16.5	4.5 / 9.9	80x120 / 31.5x47.2	780.0	900.0	8,580	20,700
T1015	15L Tub		29 / 11.4	33 / 13	0.37 / 0.86	10	43 / 16.9	33 / 13	3.7 / 8.6	100x100 / 39x39	1,440.0	1,440.0	14,400	31,680

Flexible Bowl with Cover

- Flexible
- Lightweight
- Super strong handles
- Flexible and easy to grip
- Fitting lid keeps food fresh
- Washable
- Uv protected
- Extra strong & durable, BPA-free
- Allows storage one on top of the other

This flexible bowl with cover is perfect for a variety of kitchen tasks, from mixing dough to storing leftovers. The bowl is made of a durable BPA-free plastic material that is flexible and easy to grip, even when wet. The cover is also made of BPA-free plastic and has a fitting seal to keep food fresh. The hard lid allows storage of several bowls one on top of the other.

Available in a wide variety of assorted fashionable colors.



Item No.	Description	Price per Unit	Product Dim cm/inch		Weight per Unit Kg/Lbs	Qty Per Master	Packaging Details Master cm/inch		Master Pack Weight Kg/Lbs	Pallet Dim cm/inch	Qty per pallet 20"	Qty per pallet 40HC"	20' Container load	40HC' Container load
			H	Ø			H	Ø						
T11012C	12L Tub+Cover		24 / 9.4	35 / 13.8	0.42 / 0.92	10	37 / 14.6	35 / 13.8	4.2 / 9.2	100x100 / 39x39	1,440.0	1,440.0	14,400	31,680

Rope tubs

All-purpose tub you'll ever need!

- 45 Liter/12 gallons
- Strong & durable
- Indoor & outdoor
- Uv protected
- Home improvement
- Lawn & garden
- Outdoor living - ice bucket, planter
- Pet + livestock - feed storage, muck bucket, pet bath
- Storage - toys, tools, laundry basket

Available in a wide variety of assorted fashionable colors.



Item No.	Description	Price per Unit	Product Dim cm/inch		Weight per Unit Kg/Lbs	Qty Per Master	Packaging Details Master cm/inch		Master Pack Weight Kg/Lbs	Pallet Dim cm/inch	Qty per pallet 20"	Qty per pallet 40HC"	20' Container load	40HC' Container load
			H	Ø			H	Ø						
RB1045	Rope Tub		35 / 13.8	50 / 19.7	1.1 / 2.42	10.0	50 / 19.7	50 / 19.7	11.1 / 24.2	100x100 / 39x39	320	400	3,200	8,800
RB1045	Rope Tub		35 / 13.8	50 / 19.7	1.1 / 2.42	42.0	113 / 44.4	50 / 19.7	48.0 / 105.6	100x100 / 39x39	360	440	3,600	9,680



MagicPoloPlastLTD was founded in 2001 by the Altman family. From the beginning, the main goal of Magic Polo Plast Ltd. was to specialize in DIY, Gardening and construction products using modern production methods and lowering production costs. the company produces many products for DIY, Gardening and construction markets and sells internationally with great success. The factory that is located between the 2 biggest ports of Israel, in Kibbutz Ma'anit and operates 24/7 with fully automatic machines. Magic Polo Plast also manufactures products according to customer requirements and specific designs. Magic Polo Plast is a member of SMETA - Ethical Trade Audit of Sedex. Sedex is a UK-based, non-profit organization dedicated to improving ethical and responsible business practices in global supply chains. The audit by SMETA demonstrates Magic Polo Plast's commitment to best practices in the planning, training and execution of ethical trade audits and the use of a common format for reporting and corrective actions. Magic Polo Plast is also certified by ISO 9001 and works according to quality control management requirements. Magic Polo Plast is an environmentally friendly production plant Specializing in production from recycled raw materials using more than 4000 metric tons of recycled materials per year that saves pollution from the environment.

